



BROCHURE



LED ALUMINUM PROFILE **ANNUAL CATALOGUE**

CONTACT US

+86-755-27926119 / 27926326 sales@surmountor.com

www.surmountor.com / www.sur-led.com / www.ledstrip.cc

ADD:4/F, No.2 Factory Building, Dayang, No.4 Tangwei Industrial Avenue, FuHai Street, Bao'an, Shenzhen, China



2024-2025

ONE-STOP SERVICE

Surface Mounting Series / Pendant Series / Recessed Series
Corner Series / Floor Series / Stair Series



TABLE OF CONTENTS

About Surmountor

Company Overview	1-2
Linear Lighting System	3-4

LED Aluminum Profile

LED Aluminum Profile Introduction	5
Certificate	6
Various Installation Ways	7
Application	8
Dimensions of LED Profile	9-13
Sample Kit Series	14
Surface Mounting Series	15-29
Recessed Mounting Series	30-37
Angle/Corner Series	39-45
Wall Edge/Gypsum Series	46-54
Step/Floor Series	55-58
Shop fitting/ Shelves Lighting Series	59-60
Waterproof/Plastic Series	61
Round Shape Series	62-65
Pendant/Suspension Series	66-74

LED Linear Light

Running water step light	75-76
LED linear system	77-78
LED motion sensor light	79-80
LED WIFI cabinet light	81-82
Seamless connect LED cabinet light	83-84
Magnetic LED shelf light	85-86
LED wardrobe light	87-88
LED linear track/pendant light	89-92
LED power shelf system	93-96
DC power track system	97-99
Track spot	100
Round LED cabinet light	101

ABOUT OUR COMPANY



We are an industrial and trade company!

Surmountor Lighting Co., Limited, located in Shenzhen, the famous LED City in China. With over 10 years experience, we are specialized in producing LED Aluminum Profile, LED Linear Lighting, Flexible LED Strip, LED Neon Flex, LED Grow Light and LED Sensors Switches. Most of products are widely used in hotel lighting, office lighting, shop lighting, kitchen lighting, outdoor lighting, etc.

Surmountor is a big family with more than 80 employees, advanced production equipment and staff cooperation. Our factory production monthly capacity reach more than 120000 meters of flexible led strips, 150,000 meters led profiles, 100000 pieces sensor switches and so on.

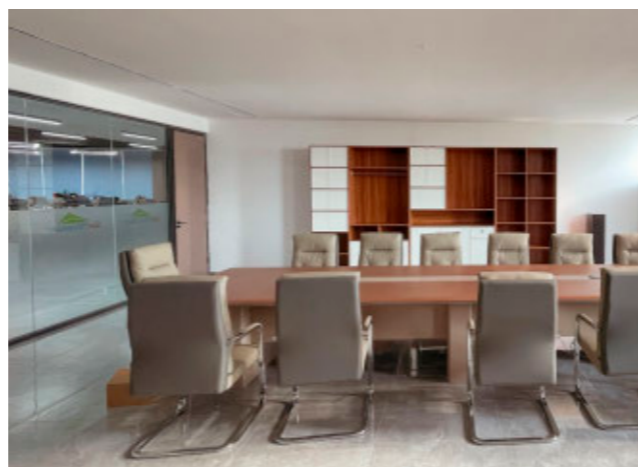

We have strict quality control!

Competitive price, stable quality, timely delivery and good service make us gained good reputation among our customers all over the world, such as in Europe, North America, Latin America, Australia and Middle East. Our LED products are CE, RoHS, UL listed and we have passed ISO9001:2015 management system.



Continuous innovation and R&D!

With wide range led products line, we concentrate on offering one stop and one package service. Most customers choose our linear lights for their important hotel lighting projects. Also our R&D departments always focus on developing new products to keep moving. In 2017, the new products we developed were LED Neon Lights and LED Grow Lights, the latter improves the plants growth quality and speed, customers can choose different wave lengths and related percentage to meet each plant needslighting, outdoor lighting, etc.



We have a great team!

Our energetic and creative sales team could understand customers' demands deeply and solve problems promptly. Every customer should be concerned and respected seriously, patiently, responsibly from enquiry-design-sampling-order-production. Based on all our efforts, we attained great achievements and progress in the past 10 years, we also help our customers to expand their markets by constantly developing new products.



Our target is to satisfy our clients with good quality & best service. Welcome to join us and let us brighten our future together!

Johnson Wan
Surmountor CEO



Our pursuit!

Our main strong point is our engineers can work out light solutions upon our customer's needs. Our goal is to build long term win-win relationship with our customers.

LINEAR LIGHTING SYSTEM

The linear lighting system is designed to explore completely the potentials of installing and connecting providing to designers, architects and engineering parties the flexible solutions in space and lighting design with the various led aluminum profiles, led strip, sensor switch, power supplies, connectors and accessories.

LED ALUMINUM PROFILE

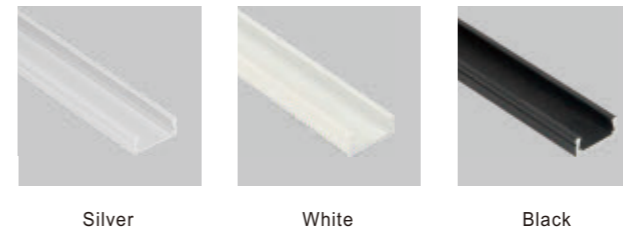

Silver

White

Black

PC/PMMA COVER

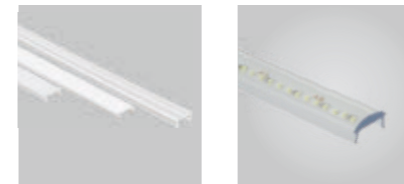

PC Cover

PMMA Cover

LED STRIP

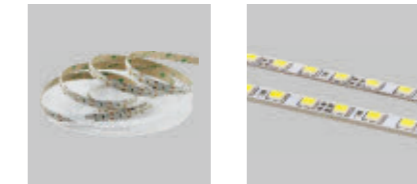

Flexible Strip

Rigid Strip

LED SENSOR SWITCH



Internal

External

POWER SUPPLY



Non-waterproof

Waterproof

CONNECTORS



Accessories

X Shape

L1 Shape

L2 Shape

L3 Shape

T Shape

INSTALLATION ACCESSORIES



Plastic Mounting Clip

Metal Mounting Clip

Adjustable Bracket

Spring Clip (Recessed)

Steel Rope

Wall Mounting Fixtures

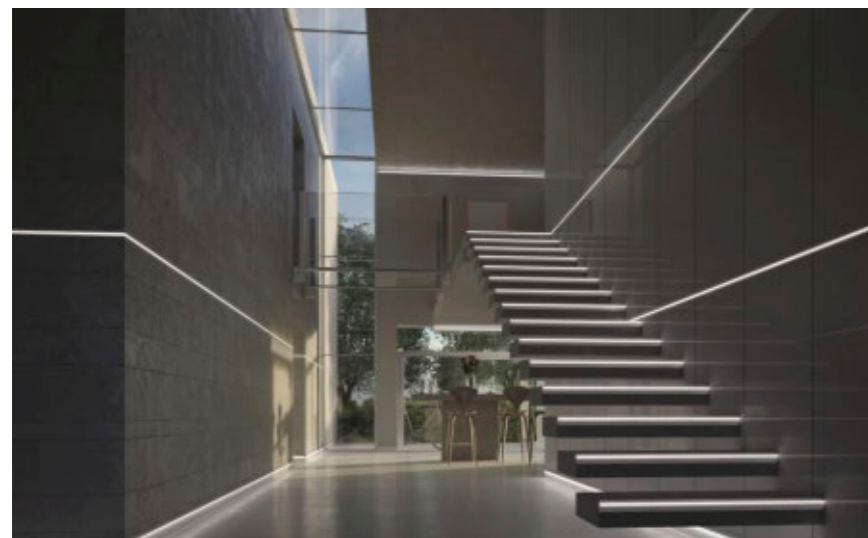

◎ COMMERCIAL LIGHTING



◎ OFFICE LIGHTING



◎ SALOON LIGHTING



◎ KITCHEN LIGHTING

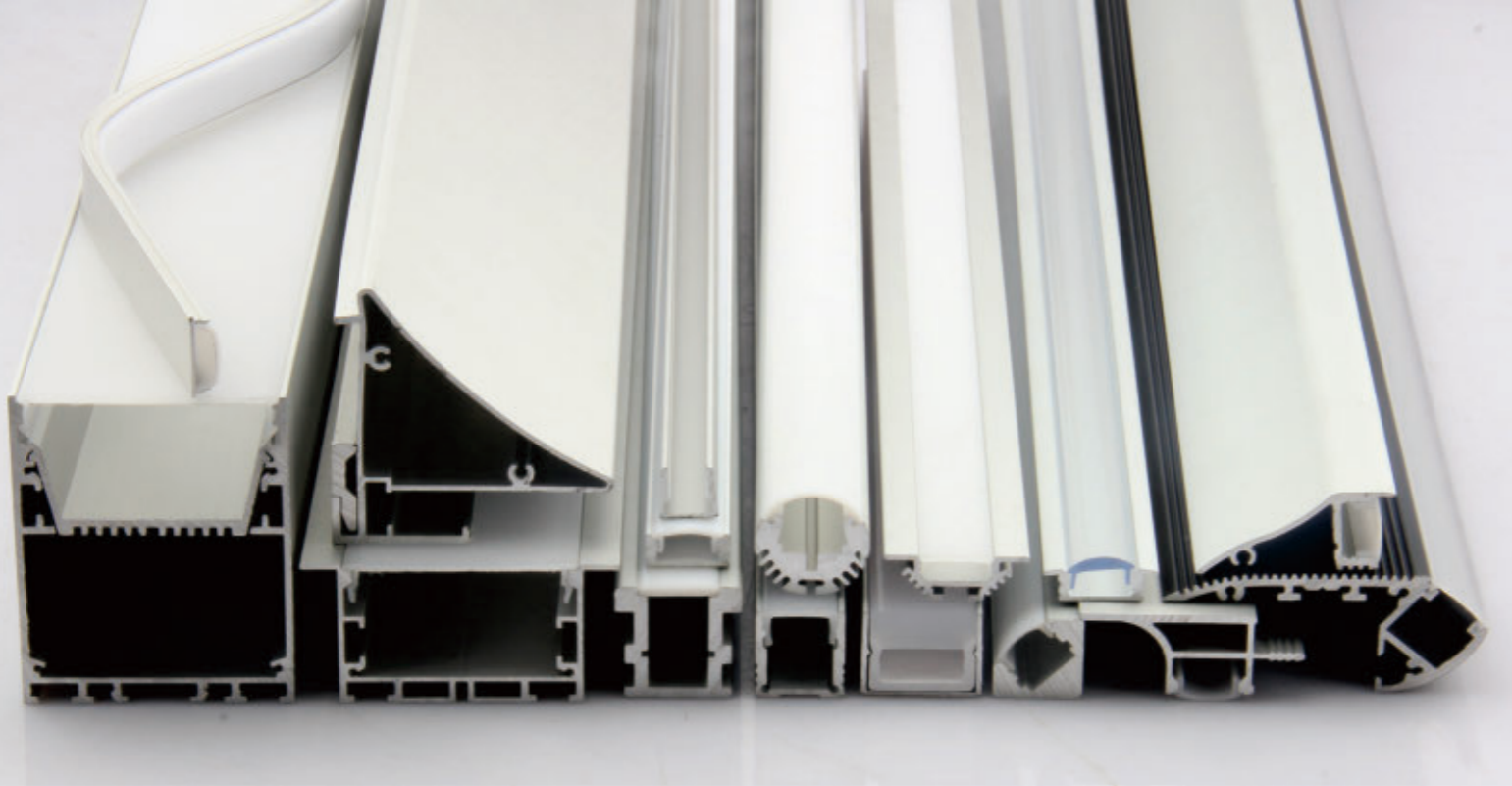

CERTIFICATE

We provide products of quality assurance, with ISO9001-2015 certificate. Meanwhile, high quality is what we insist on. Our aluminum profile is certified by RoHS.

“ LED ALUMINUM PROFILE INTRODUCTION

Aluminum Parameters

Material	Aluminum alloy 6063-T5
Anodized Thickness	10µm
Mounting	For Surface, Recessed, Suspended Mounting, Stair, Dry wall, Floor, Glass Shelf, Bendable, Waterproof etc.
Color	Aluminum silver for standard
*Customized color can be ordered	

Cover Parameters

Material	PC/PMMA
UL Flammability Of PC cover	UL94V-2
Mounting	Clip the cover to the aluminum profile from the top
Standard Type	Transparent, Frosted, Milky
Special Types	60° cover (PMMA)
*Customized cover could be available	

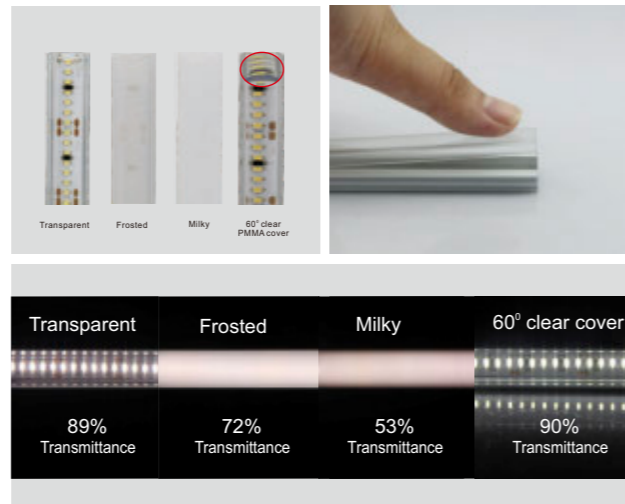

ISO9001-2015



RoHS

VARIOUS INSTALLATION WAYS

- Optional installation accessories
- More convenient installation
- More extensive application

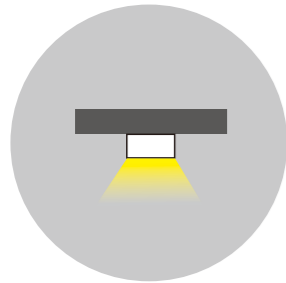

Surface Mounting

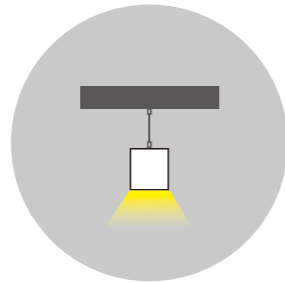

Pendant

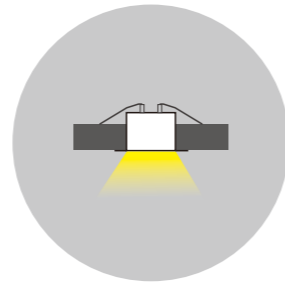

Recessed

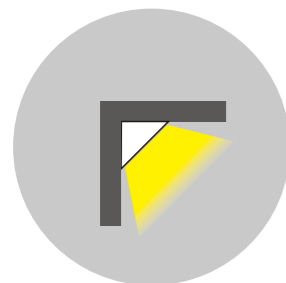

Corner

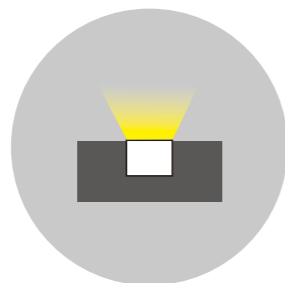

Floor

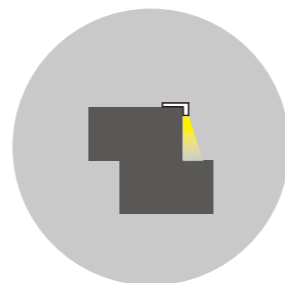

Stair

Application

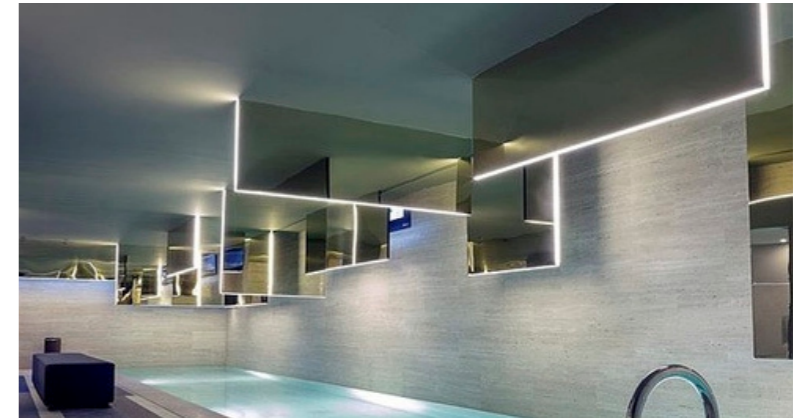
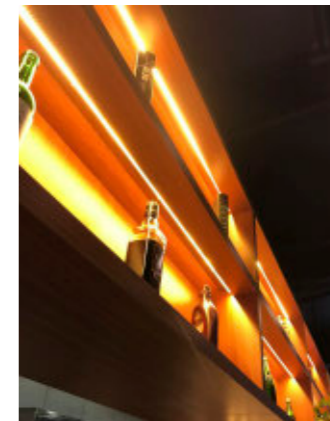
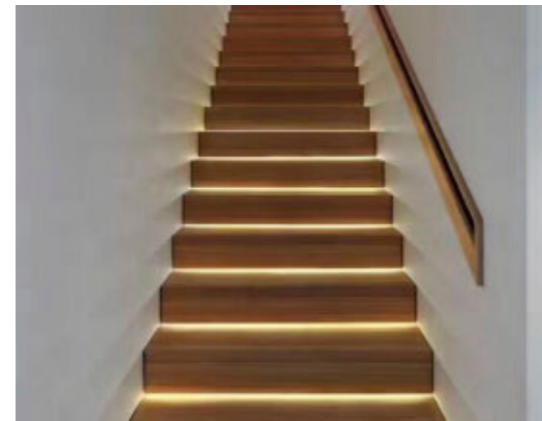

DIMENSIONS OF LED PROFILE

SURFACE MOUNTING SERIES

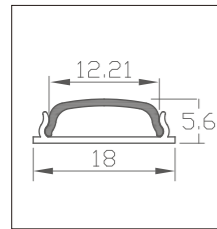

C1806

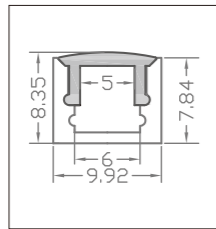

A1008

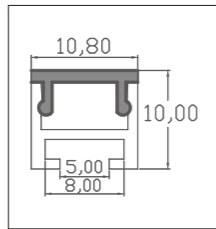

A1110

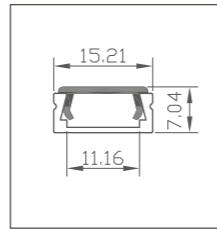

A1506

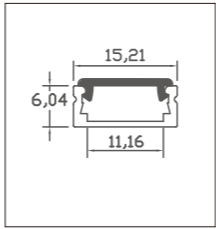

C1506

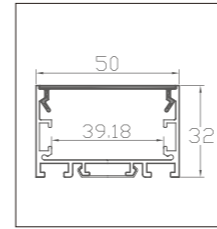

C5032

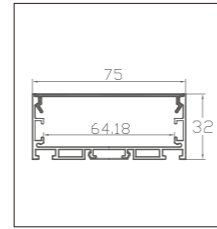

C7532

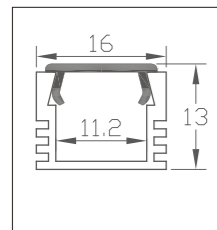

A1612

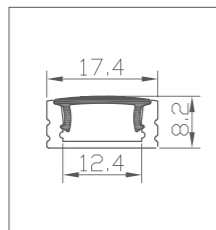

A1707

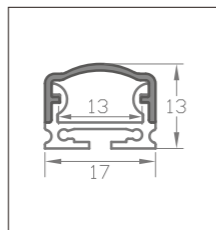

A1713

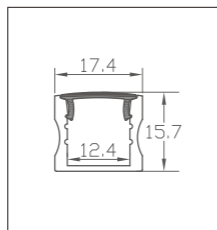

A1715

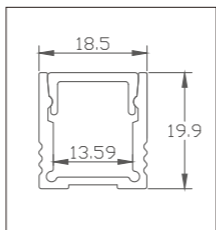

A1920

RECESSED MOUNTING SERIES

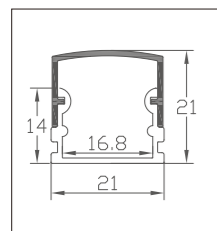

A2114

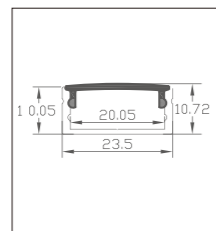

A2310

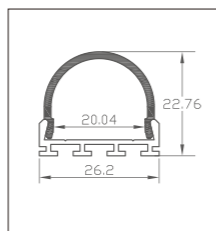

A2623

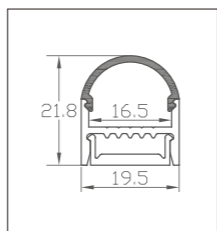

D001

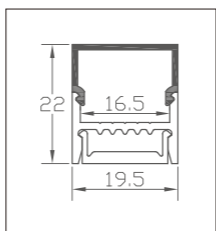

D002

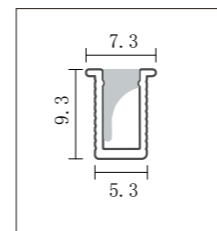

A0709

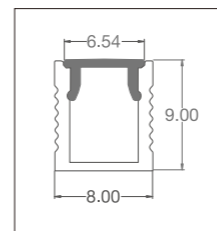

A0809

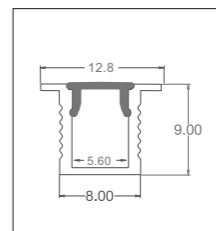

A1209

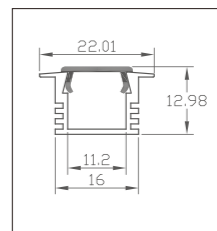

A2212

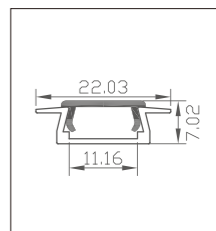

A2206

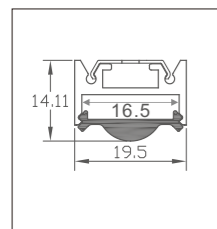

D003A

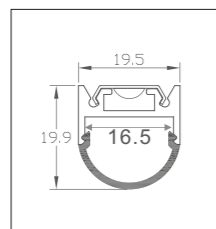

D003B

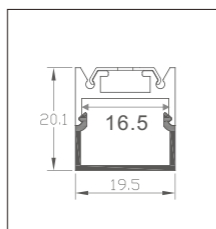

D003C

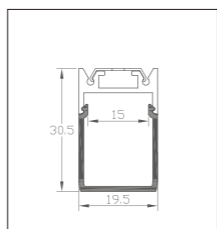

D003D

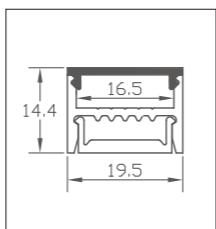

D004

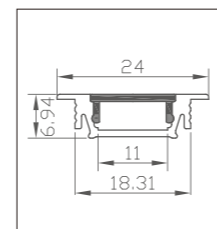

B2407

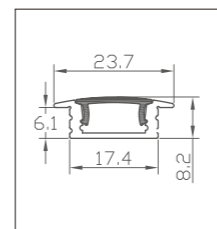

A2507

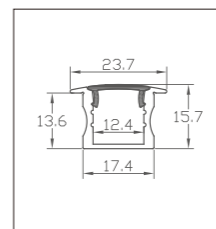

A2515

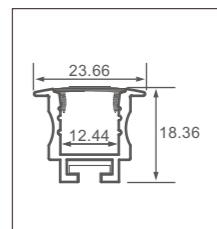

A2520

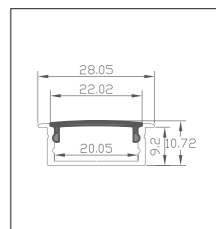

A2810

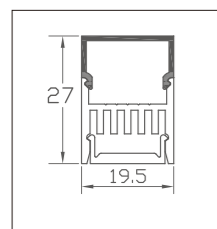

D006

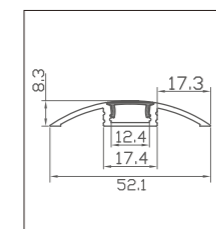

F001

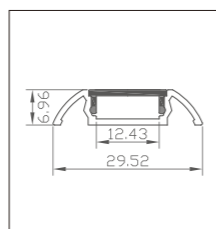

F002

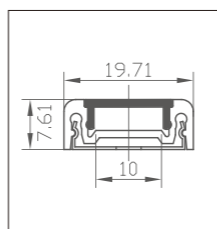

F003

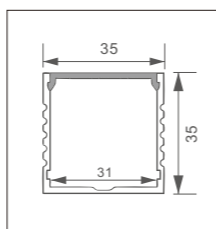

A3535

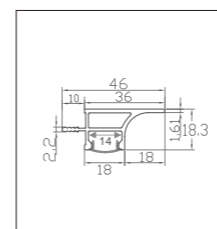

A3619

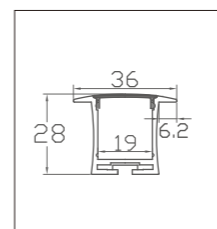

A3628

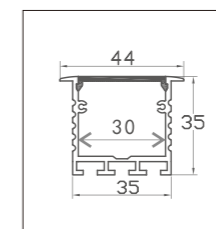

A4435

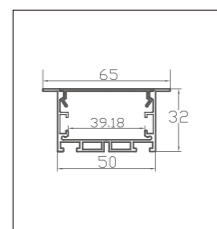

C6532

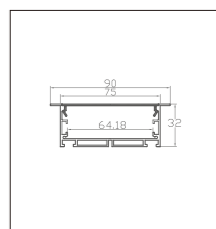

C9032

DIMENSIONS OF LED PROFILE

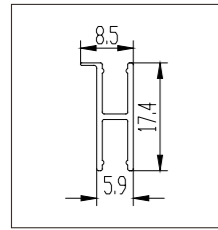

C1809

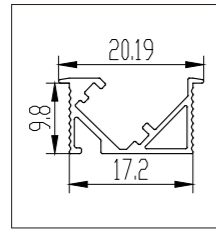

C1710

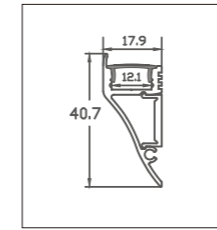

W001

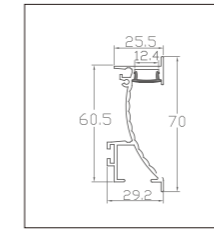

W003

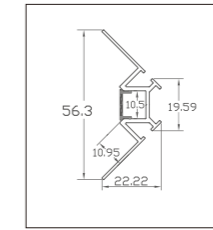

W004

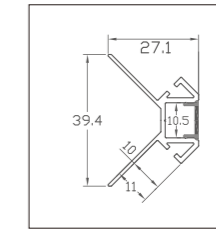

W005

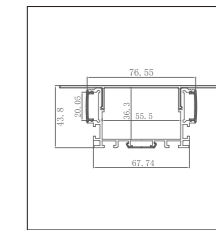

W006

ANGLE/CORNER SERIES

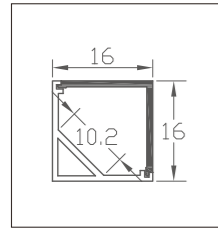

B1616

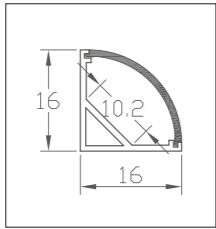

A1616

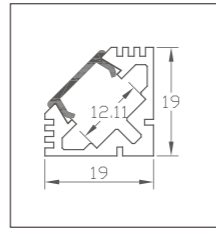

A1919

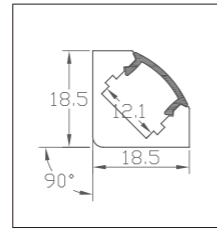

B1919

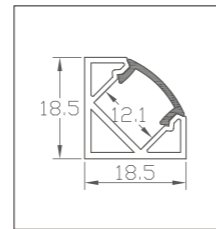

C1919

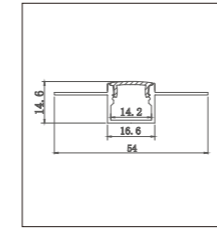

W007

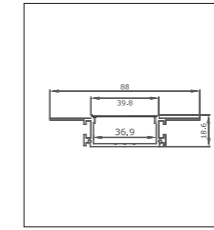

W008

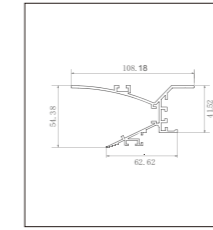

W009

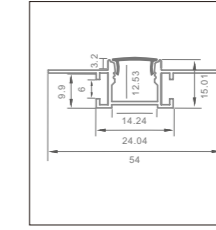

W011

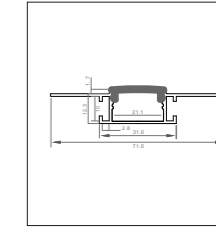

W012

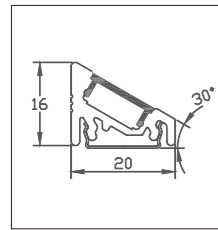

A2016

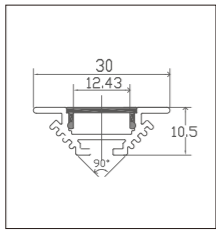

A3010

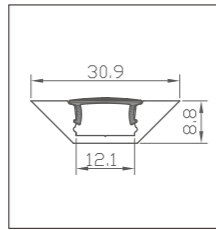

A3109

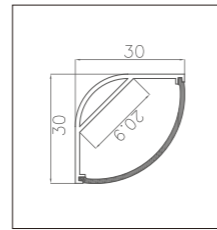

A3030

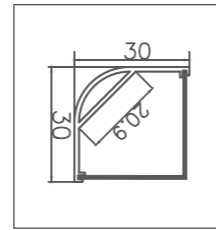

B3030

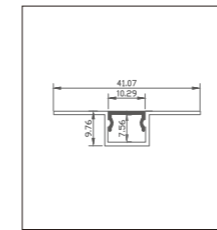

W4010

STEP/FLOOR SERIES

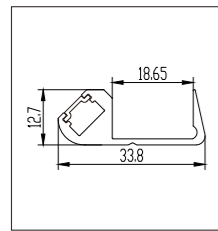

C3413

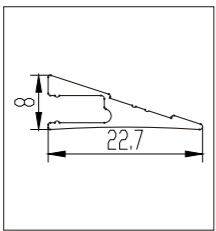

C2208

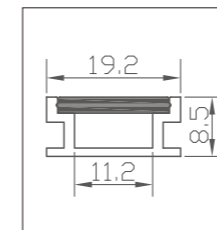

B1908

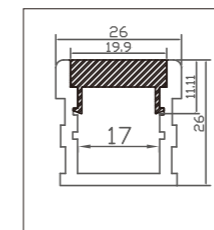

C2626

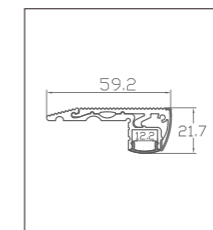

S001

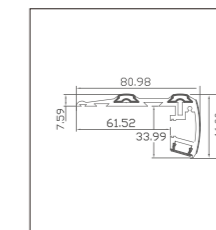

S002

WALL EDGE/GYPSUM SERIES

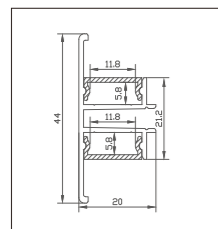

B4420

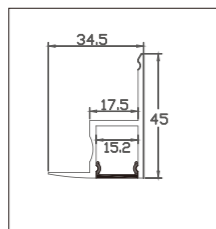

A4535

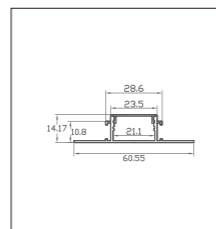

A6014

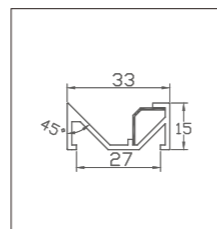

C3315

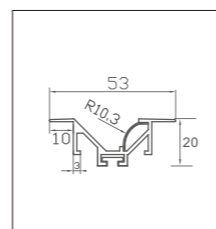

C5320

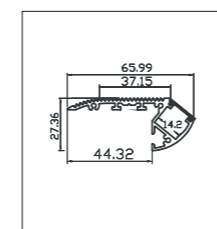

S003

DIMENSIONS OF LED PROFILE

SHOP FITTING/SHELVES LIGHTING SERIES

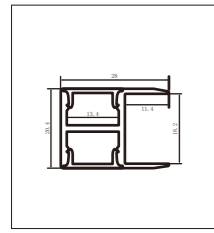

A2820

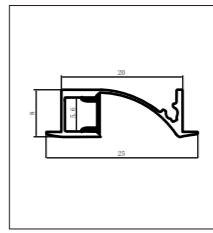

A2508

WATERPROOF/PLASTIC SERIES

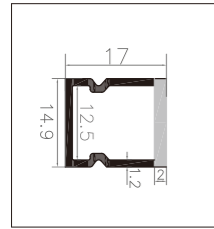

IP001

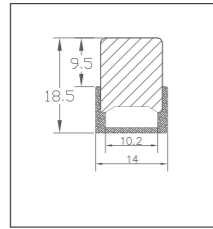

IP003

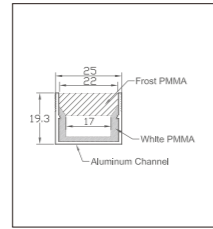

IP004

ROUND SHAPE SERIES

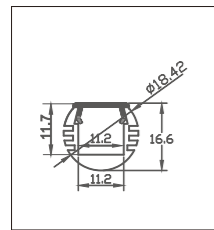

A1818

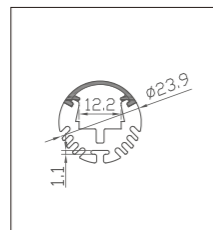

R001

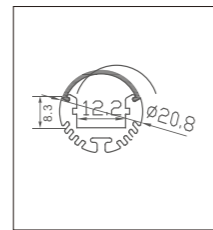

R002

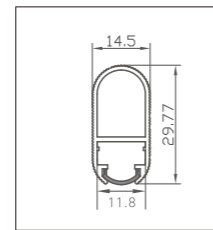

R003

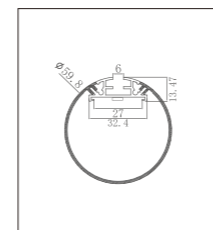

R60

PENDANT/SUSPENSION SERIES

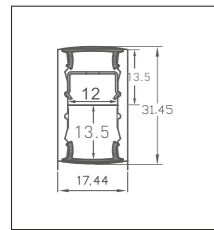

A1732

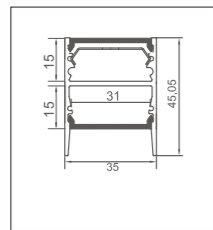

F3545

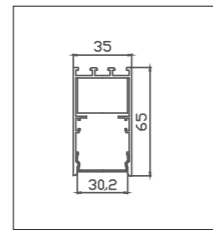

A3565

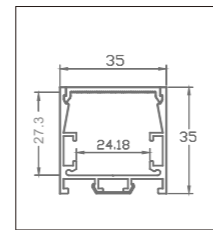

C3535

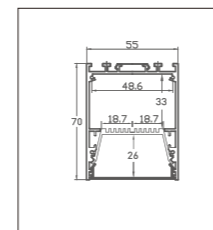

A5570

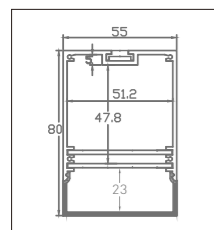

A5580

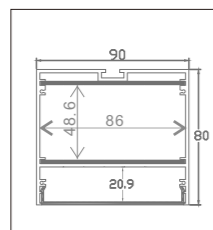

A9080

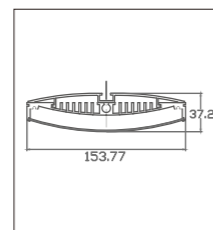

PE001

SAMPLE KIT



FEATURES

- Led Profile sample kit
- About 70 different models
- Please contact us for drawing details



C1806



FEATURES

- Internal width: 12.21 mm
- Material: Anodized aluminum extrusion
- Length: 1~3 meter
- Dimension: 18x5.6 mm
- Application: Surface
- Customized color can be ordered



PRODUCT SIZE

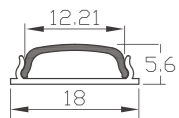

MAXIMUM BEND RADIUS

6"/152.4 mm



STANDARD ACCESSORIES



Profile x1
1~3 Meter



PC Cover x1
Transparent
Frosted
Milky



End Cap x2
1 with hole
1 without hole



Mounting Clip x2
Metal

INSTALLATION

1: With Double-sided Tape

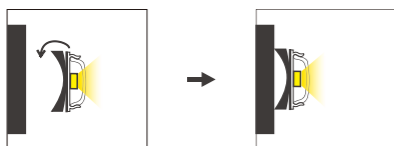

2: With Clip

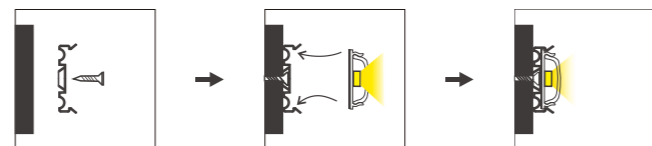

APPLICATIONS

Interior lighting, curved lighting for display counter



A1008



FEATURES

- Internal width: 6 mm
- Material: Anodized aluminum extrusion
- Length: 1~3 meter
- Dimension: 9.92x8.35mm
- Application: Surface
- Customized color can be ordered

PRODUCT SIZE

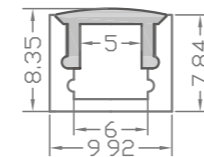

STANDARD ACCESSORIES



Profile x1
1~3 Meter

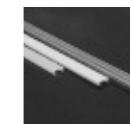

PC Cover x1
Transparent
Frosted
Milky



End Cap x2
1 with hole
1 without hole



Mounting Clip x2
Plastic



A1110/A1110-B



FEATURES

- Internal width: 8 mm
- Material: Anodized aluminum extrusion
- Length: 1~3 meter
- Dimension: 10.8x10 mm
- Application: Surface
- Customized color can be ordered

PRODUCT SIZE

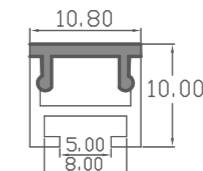

STANDARD ACCESSORIES



Profile x1
1~3 Meter



PC Cover x1
Transparent
Frosted
Milky



End Cap x2
1 with hole
1 without hole



Mounting Clip x2
Plastic

OPTIONAL ACCESSORIES



Magnet



A1506/A1506-W/A1506-B



FEATURES

Internal width: 11.16 mm
 Material: Anodized aluminum extrusion
 Length: 1~3 meter
 Dimension: 15.21×7.04/15.21×6.04mm
 Application: Surface
 Customized color can be ordered

PRODUCT SIZE

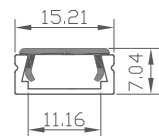

STANDARD ACCESSORIES

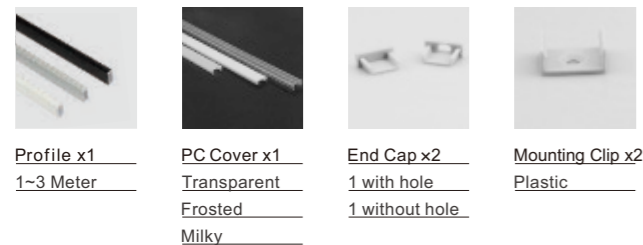

OPTIONAL ACCESSORIES

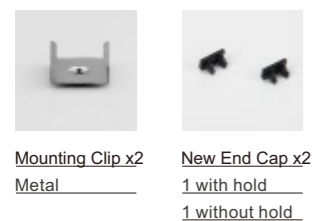

C1506/C1506-B



FEATURES

Internal width: 11.16 mm
 Material: Anodized aluminum extrusion
 Length: 1~3 meter
 Dimension: 15.21×7.04/15.21×6.04 mm
 Application: Surface
 Customized color can be ordered

PRODUCT SIZE

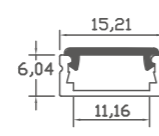

C1506

STANDARD ACCESSORIES



OPTIONAL ACCESSORIES



A1612



FEATURES

Internal width: 11.2 mm
 Material: Anodized aluminum extrusion
 Length: 1~3 meter
 Dimension: 16×13 mm
 Application: Surface
 Customized color can be ordered

PRODUCT SIZE

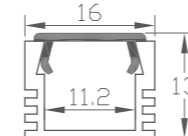

STANDARD ACCESSORIES



OPTIONAL ACCESSORIES



A1707/A1707-B/A1707-W



FEATURES

Internal width: 12.4 mm
 Material: Anodized aluminum extrusion
 Length: 1~3 meter
 Dimension: 17.4×8.2 mm
 Application: Surface
 Customized color can be ordered

PRODUCT SIZE

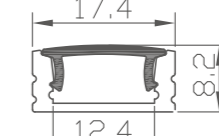

STANDARD ACCESSORIES



OPTIONAL ACCESSORIES

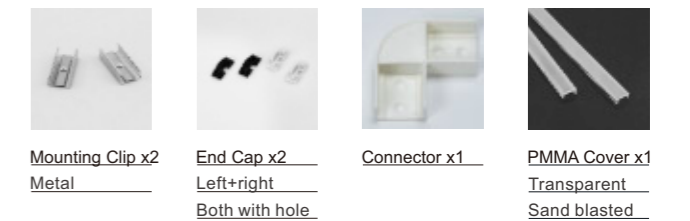



A1713



FEATURES

Internal width: 13 mm
 Material: Anodized aluminum extrusion
 Length: 1~3 meter
 Dimension: 17×13 mm
 Application: Surface
 Customized color can be ordered

PRODUCT SIZE

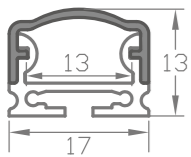

STANDARD ACCESSORIES



Profile x1
1~3 Meter

PC Cover x1
Transparent
Frosted
Milky

End Cap x2
2 without hole
Screw For End Cap x4
PB2x8 mm

Mounting Clip x2
Plastic

OPTIONAL ACCESSORIES



1) 30° mounting clip
 2) 45° mounting clip
 3) 60° mounting clip

Magnet

Male&Female End Cap X2
 2 without hole
 Screw For End Cap x4
 PB2x8 mm



A1715/A1715-B



FEATURES

Internal width: 12.4 mm
 Material: Anodized aluminum extrusion
 Length: 1~3 meter
 Dimension: 17.4×15.7 mm
 Application: Surface
 Customized color can be ordered

PRODUCT SIZE

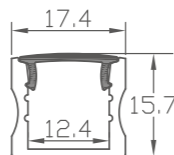

STANDARD ACCESSORIES



Profile x1
1~3 Meter

PC Cover x1
Transparent
Frosted
Milky

End Cap x2
1 with hole
1 without hole

Mounting Clip x2
Plastic

OPTIONAL ACCESSORIES



End Cap x2
Left+right
Both with hole

Mounting Clip x2
Metal



A1920



FEATURES

Internal width: 13 mm
 Material: Anodized aluminum extrusion
 Length: 1~3 meter
 Dimension: 18.5×19.9 mm
 Application: Surface
 Customized color can be ordered

PRODUCT SIZE

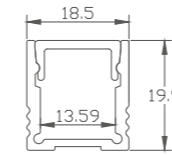

STANDARD ACCESSORIES



Profile x1
1~3 Meter

PC Cover x1
Transparent
Frosted
Milky

End Cap x2
1 with hole
1 without hole

Mounting Clip x2
Metal



A2114



FEATURES

Internal width: 16.8 mm
 Material: Anodized aluminum extrusion
 Length: 1~3 meter
 Dimension: 21×21 mm
 Application: Surface
 Customized color can be ordered

PRODUCT SIZE

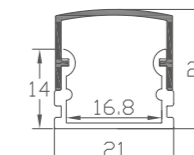

STANDARD ACCESSORIES



Profile x1
1~3 Meter

PC Cover x1
Transparent
Frosted
Milky

End Cap x2
1 with hole
1 without hole

Mounting Clip x2
Metal



A2310/A2310-B



FEATURES

Internal width: 20.05 mm
 Material: Anodized aluminum extrusion
 Length: 1~3 meter
 Dimension: 23.5×10.72 mm
 Application: Surface
 Customized color can be ordered

PRODUCT SIZE

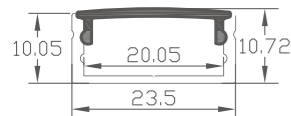

STANDARD ACCESSORIES

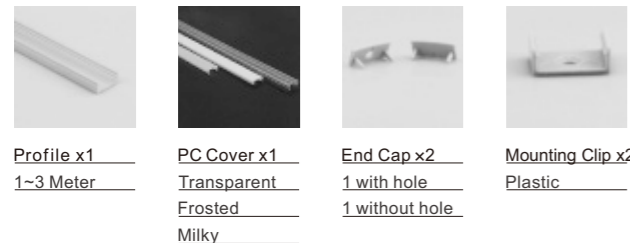

A2623



FEATURES

Internal width: 20.04 mm
 Material: Anodized aluminum extrusion
 Length: 1~3 meter
 Dimension: 26.2×22.76 mm
 Application: Surface
 Customized color can be ordered

PRODUCT SIZE

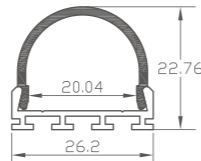

STANDARD ACCESSORIES



OPTIONAL ACCESSORIES



1.5m steel rope x 1 set



D001



FEATURES

Internal width: 16.5 mm
 Material: Anodized aluminum extrusion
 Length: 1~3 meter
 Dimension: 19.5×21.8 mm
 Application: Surface
 Customized color can be ordered

PRODUCT SIZE

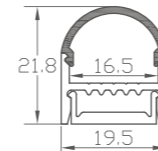

STANDARD ACCESSORIES



OPTIONAL ACCESSORIES



Mounting Clip x2
Metal



D002



FEATURES

Internal width: 16.5 mm
 Material: Anodized aluminum extrusion
 Length: 1~3 meter
 Dimension: 19.5×22 mm
 Application: Surface
 Customized color can be ordered

PRODUCT SIZE

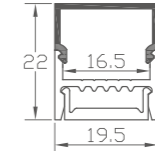

STANDARD ACCESSORIES

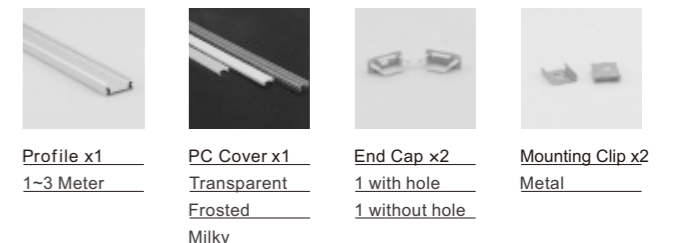

OPTIONAL ACCESSORIES



Mounting Clip x2
Plastic



D003A



FEATURES

- Internal width: 16.5 mm
- Material: Anodized aluminum extrusion
- Length: 1~3 meter
- Dimension: 19.5×14.11 mm
- Application: Surface / Pendant
- Customized color can be ordered

PRODUCT SIZE

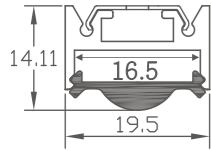

STANDARD ACCESSORIES

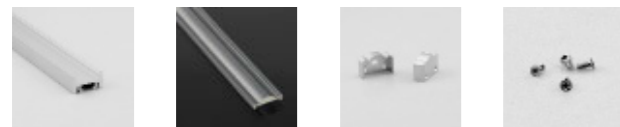

- | | | | |
|-------------------------|--|--|-------------------------------------|
| Profile x1
1~3 Meter | PC Cover x1
Transparent
Frosted
Milky | End Cap x2
Metal
1 with hole
1 without hole | Screw For
End Cap x4
KM2X5 mm |
|-------------------------|--|--|-------------------------------------|

OPTIONAL ACCESSORIES



- | | |
|---------------------------|-------------------------|
| Mounting Clip x2
Metal | 1.5m steel rope x 1 set |
|---------------------------|-------------------------|

D003B

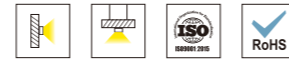

FEATURES

- Internal width: 16.5 mm
- Material: Anodized aluminum extrusion
- Length: 1~3 meter
- Dimension: 19.5×19.9 mm
- Application: Surface / Pendant
- Customized color can be ordered

PRODUCT SIZE

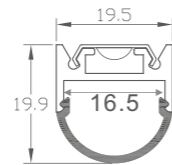

STANDARD ACCESSORIES

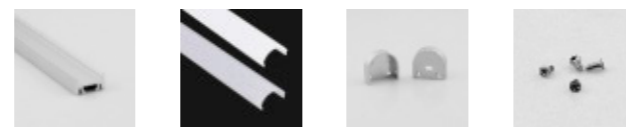

- | | | | |
|-------------------------|--|--|-------------------------------------|
| Profile x1
1~3 Meter | PC Cover x1
Transparent
Frosted
Milky | End Cap x2
Metal
1 with hole
1 without hole | Screw For
End Cap x4
KM2X5 mm |
|-------------------------|--|--|-------------------------------------|

OPTIONAL ACCESSORIES



- | | |
|---------------------------|-------------------------|
| Mounting Clip x2
Metal | 1.5m steel rope x 1 set |
|---------------------------|-------------------------|

D003C

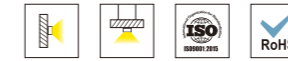

FEATURES

- Internal width: 16.5 mm
- Material: Anodized aluminum extrusion
- Length: 1~3 meter
- Dimension: 19.5×20.1 mm
- Application: Surface / Pendant
- Customized color can be ordered

PRODUCT SIZE

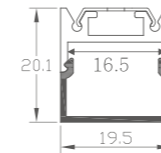

STANDARD ACCESSORIES

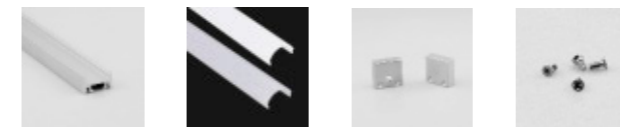

- | | | | |
|-------------------------|--|--|-------------------------------------|
| Profile x1
1~3 Meter | PC Cover x1
Transparent
Frosted
Milky | End Cap x2
Metal
1 with hole
1 without hole | Screw For
End Cap x4
KM2X5 mm |
|-------------------------|--|--|-------------------------------------|

OPTIONAL ACCESSORIES



- | | |
|---------------------------|-------------------------|
| Mounting Clip x2
Metal | 1.5m steel rope x 1 set |
|---------------------------|-------------------------|

D003D



FEATURES

- Internal width: 16.5 mm
- Material: Anodized aluminum extrusion
- Length: 1~3 meter
- Dimension: 19.5×30.5 mm
- Application: Surface / Pendant
- Customized color can be ordered

PRODUCT SIZE

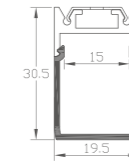

STANDARD ACCESSORIES

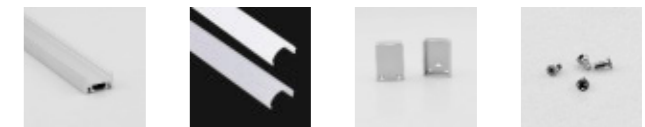

- | | | | |
|-------------------------|--|--|-------------------------------------|
| Profile x1
1~3 Meter | PC Cover x1
Transparent
Frosted
Milky | End Cap x2
Metal
1 with hole
1 without hole | Screw For
End Cap x4
KM2X5 mm |
|-------------------------|--|--|-------------------------------------|

OPTIONAL ACCESSORIES



- | | |
|---------------------------|-------------------------|
| Mounting Clip x2
Metal | 1.5m steel rope x 1 set |
|---------------------------|-------------------------|



D004



FEATURES

- Internal width: 16.5 mm
- Material: Anodized aluminum extrusion
- Length: 1~3 meter
- Dimension: 19.5×14.4 mm
- Application: Surface
- Customized color can be ordered

PRODUCT SIZE

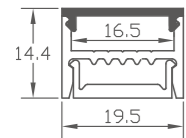

STANDARD ACCESSORIES



- Profile x1
1~3 Meter
- PC Cover x1
Transparent
Frosted
Milky
- End Cap x2
1 with hole
1 without hole
- Mounting Clip x2
Plastic

OPTIONAL ACCESSORIES



- Mounting Clip x2
Metal

D006



FEATURES

- Internal width: 16.5 mm
- Material: Anodized aluminum extrusion
- Length: 1~3 meter
- Dimension: 19.5×27 mm
- Application: Surface
- Customized color can be ordered

PRODUCT SIZE

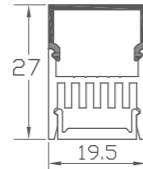

STANDARD ACCESSORIES



- Profile x1
1~3 Meter
- PC Cover x1
Transparent
Frosted
Milky
- End Cap x2
1 with hole
1 without hole
- Mounting Clip x2
Plastic

OPTIONAL ACCESSORIES



- Mounting Clip x2
Metal

F001



FEATURES

- Internal width: 12.4 mm
- Material: Anodized aluminum extrusion
- Length: 1~3 meter
- Dimension: 52.1×8.3 mm
- Application: Surface
- Customized color can be ordered

PRODUCT SIZE

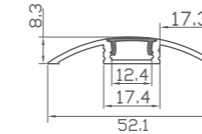

STANDARD ACCESSORIES

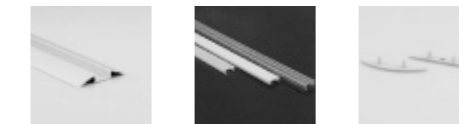

- Profile x1
1~3 Meter
- PC Cover x1
Transparent
Frosted
Milky
- End Cap x2
1 with hole
1 without hole

OPTIONAL ACCESSORIES



- Bracket End Cap x2

F002



FEATURES

- Internal width: 12.43 mm
- Material: Anodized aluminum extrusion
- Length: 1~3 meter
- Dimension: 29.52×6.96 mm
- Application: Surface
- Customized color can be ordered

PRODUCT SIZE

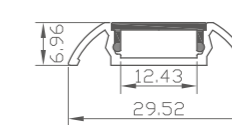

STANDARD ACCESSORIES



- Profile x1
1~3 Meter
- PC Cover x1
Transparent
Frosted
Milky
- End Cap x2
1 with hole
1 without hole
- Mounting Clip x2
Metal



F003



FEATURES

Internal width: 10 mm
 Material: Anodized aluminum extrusion
 Length: 1~3 meter
 Dimension: 19.71×7.61 mm
 Application: Surface
 Customized color can be ordered

PRODUCT SIZE

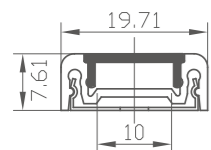

STANDARD ACCESSORIES

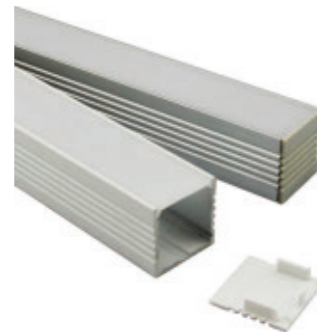
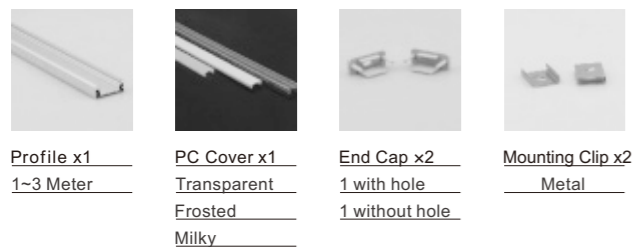

A3535



FEATURES

Internal width: 31 mm
 Material: Anodized aluminum extrusion
 Length: 1~3 meter
 Dimension: 35×35 mm
 Application: Surface
 Customized color can be ordered

PRODUCT SIZE

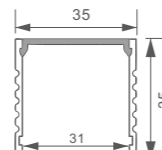

STANDARD ACCESSORIES



C5032

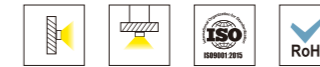

FEATURES

Internal width: 39.18 mm
 Material: Anodized aluminum extrusion
 Length: 1~3 meter
 Dimension: 50×32 mm
 Application: Surface / Pendant
 Customized color can be ordered



PRODUCT SIZE

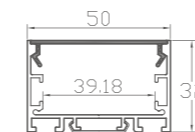

STANDARD ACCESSORIES

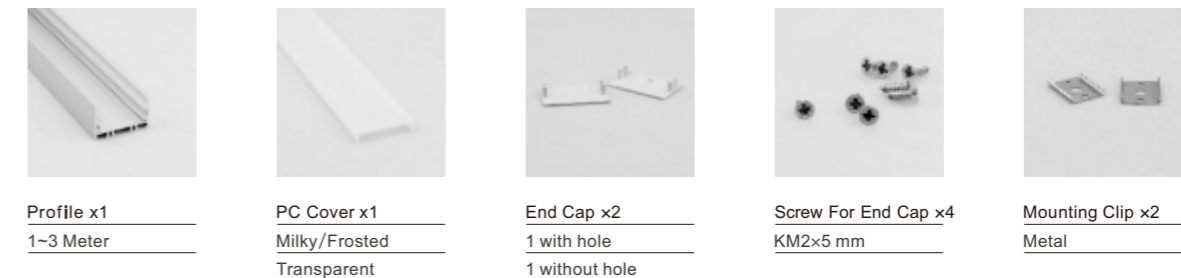

OPTIONAL ACCESSORIES



1.5m steel rope x1 set

CONNECTORS (Optional)



1) C1: 180° connector
 2) C2: 90° surface connector
 3) C3: 90° vertical connector
 4) HM4x4mm screw

C7532

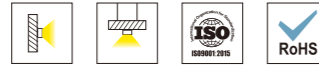

FEATURES

Internal width: 64.18 mm
 Material: Anodized aluminum extrusion
 Length: 1~3 meter
 Dimension: 75×32 mm
 Application: Surface/Pendant
 Customized color can be ordered



PRODUCT SIZE

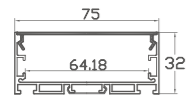

STANDARD ACCESSORIES



Profile x1
1~3 Meter



PC Cover x1
Milky/Frosted
Transparent



End Cap x2
1 with hole
1 without hole

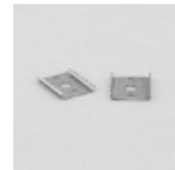

Mounting Clip x2
Metal

OPTIONAL ACCESSORIES



1.5m steel rope x1 set

CONNECTOR (Optional)



1) C1: 180° connector
 2) C2: 90° surface connector
 3) C3: 90° vertical connector
 4) HM4x4mm screw



L shape



X shape

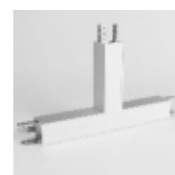

T shape



A0709



FEATURES

Internal width: 5.5mm
 Material: Anodized aluminum extrusion
 Length: 1~3 meter
 Dimension: 7.3×9.3 mm
 Application: Cabinet,supermarket,home furnishings
 Customized color can be ordered

PRODUCT SIZE

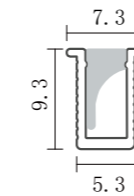

STANDARD ACCESSORIES



Profile x1
1~3 Meter



PC Cover x1
Transparent
Frosted
Milky



A0809



FEATURES

Internal width: 5.6 mm
 Material: Anodized aluminum extrusion
 Length: 1~3 meter
 Dimension: 8×9 mm
 Application: Cabinet,supermarket,home furnishings
 Customized color can be ordered

PRODUCT SIZE

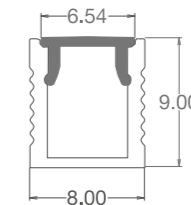

STANDARD ACCESSORIES



Profile x1
1~3 Meter



PC Cover x1
Transparent
Frosted
Milky



End Cap x2
1 with hole
1 without hole



A1209



FEATURES

- Internal width: 5.6 mm
- Material: Anodized aluminum extrusion
- Length: 1~3 meter
- Dimension: 12.8×9 mm
- Application: Cabinet,supermarket,home furnishings
- Customized color can be ordered

PRODUCT SIZE

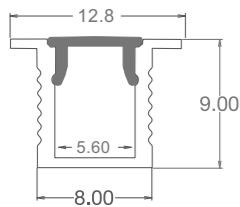

STANDARD ACCESSORIES



- | | | |
|--------------------------------|---|--|
| Profile x1
1~3 Meter | PC Cover x1
Transparent
Frosted
Milky | End Cap x2
1 with hole
1 without hole |
|--------------------------------|---|--|



A2212



FEATURES

- Internal width: 11.2 mm
- Material: Anodized aluminum extrusion
- Length: 1~3 meter
- Dimension: 22.01×12.98 mm
- Application: Recessed
- Customized color can be ordered

PRODUCT SIZE

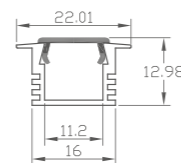

STANDARD ACCESSORIES

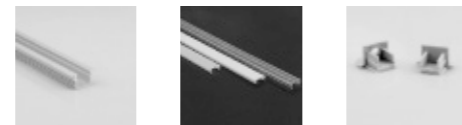

- | | | |
|--------------------------------|---|--|
| Profile x1
1~3 Meter | PC Cover x1
Transparent
Frosted
Milky | End Cap x2
1 with hole
1 without hole |
|--------------------------------|---|--|



A2206



FEATURES

- Internal width: 11.16 mm
- Material: Anodized aluminum extrusion
- Length: 1~3 meter
- Dimension: 22.03×7.02 mm
- Application: Recessed
- Customized color can be ordered

PRODUCT SIZE

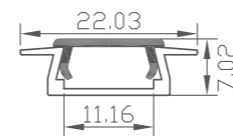

STANDARD ACCESSORIES

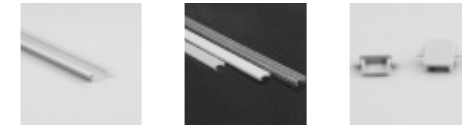

- | | | |
|--------------------------------|---|--|
| Profile x1
1~3 Meter | PC Cover x1
Transparent
Frosted
Milky | End Cap x2
1 with hole
1 without hole |
|--------------------------------|---|--|



B2407



FEATURES

- Internal width: 11 mm
- Material: Anodized aluminum extrusion
- Length: 1~3 meter
- Dimension: 24×6.94 mm
- Application: Recessed
- Customized color can be ordered

PRODUCT SIZE

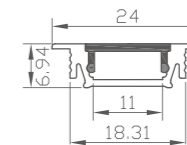

STANDARD ACCESSORIES

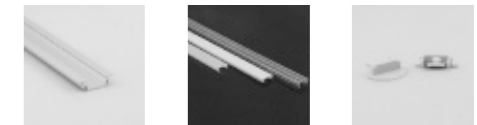

- | | | |
|--------------------------------|---|--|
| Profile x1
1~3 Meter | PC Cover x1
Transparent
Frosted
Milky | End Cap x2
1 with hole
1 without hole |
|--------------------------------|---|--|

OPTIONAL ACCESSORIES



Mounting Clip x2
Metal



A2507/A2507-B



FEATURES

- Internal width: 12.39 mm
- Material: Anodized aluminum extrusion
- Length: 1~3 meter
- Dimension: 23.7×8.2 mm
- Application: Recessed
- Customized color can be ordered

PRODUCT SIZE

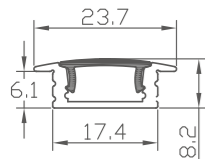

STANDARD ACCESSORIES

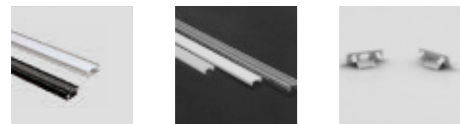

- | | | |
|-------------------------|--|---|
| Profile x1
1~3 Meter | PC Cover x1
Transparent
Frosted
Milky | End Cap x2
1 with hole
1 without hole |
|-------------------------|--|---|

OPTIONAL ACCESSORIES



- | | | |
|--|-----------------------------|-------|
| End Cap x2
Left+right
both with hold | Mounting Clip x2
Plastic | B2507 |
|--|-----------------------------|-------|

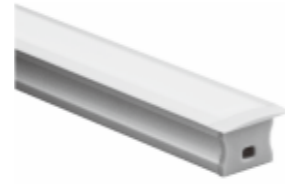

A2515



FEATURES

- Internal width: 12.4 mm
- Material: Anodized aluminum extrusion
- Length: 1~3 meter
- Dimension: 23.7×15.7 mm
- Application: Recessed
- Customized color can be ordered

PRODUCT SIZE

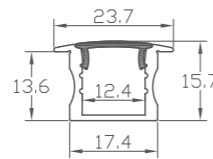

STANDARD ACCESSORIES

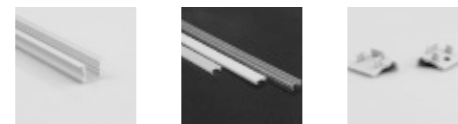

- | | | |
|-------------------------|--|---|
| Profile x1
1~3 Meter | PC Cover x1
Transparent
Frosted
Milky | End Cap x2
1 with hole
1 without hole |
|-------------------------|--|---|

OPTIONAL ACCESSORIES



- | | |
|---------------------------|-----------------------------|
| Mounting Clip x2
Metal | Mounting Clip x2
Plastic |
|---------------------------|-----------------------------|



A2520



FEATURES

- Internal width: 12.44 mm
- Material: Anodized aluminum extrusion
- Length: 1~3 meter
- Dimension: 23.66×18.36 mm
- Application: Recessed
- Customized color can be ordered

PRODUCT SIZE

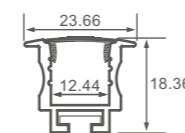

STANDARD ACCESSORIES



- | | | | |
|-------------------------|--|---|----------------------------|
| Profile x1
1~3 Meter | PC Cover x1
Transparent
Frosted
Milky | End Cap x2
1 with hole
1 without hole | Mounting Clip x2
Spring |
|-------------------------|--|---|----------------------------|

OPTIONAL ACCESSORIES



- | |
|-----------------------------|
| Mounting Clip x2
Plastic |
|-----------------------------|



A2810



FEATURES

- Internal width: 20.05 mm
- Material: Anodized aluminum extrusion
- Length: 1~3 meter
- Dimension: 28.05×10.72 mm
- Application: Recessed
- Customized color can be ordered

PRODUCT SIZE

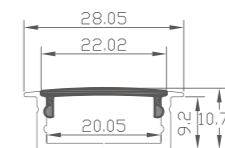

STANDARD ACCESSORIES

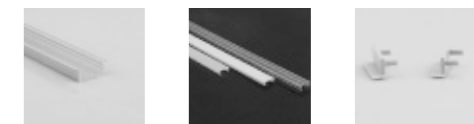

- | | | |
|-------------------------|--|---|
| Profile x1
1~3 Meter | PC Cover x1
Transparent
Frosted
Milky | End Cap x2
1 with hole
1 without hole |
|-------------------------|--|---|

OPTIONAL ACCESSORIES



- | |
|-----------------------------|
| Mounting Clip x2
Plastic |
|-----------------------------|



A3619



FEATURES

Internal width: 14 mm
Material: Anodized aluminum extrusion
Length: 1~3 meter
Dimension: 46×18.3 mm
Application: Recessed
Customized color can be ordered

PRODUCT SIZE

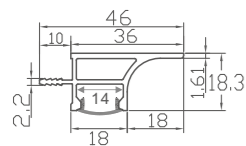

STANDARD ACCESSORIES



Profile x1
1~3 Meter

PC Cover x1
Transparent
Frosted
Milky



A3628



FEATURES

Internal width: 19 mm
Material: Anodized aluminum extrusion
Length: 1~3 meter
Dimension: 36×28 mm
Application: Recessed
Customized color can be ordered

PRODUCT SIZE

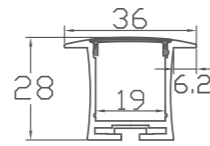

STANDARD ACCESSORIES



Profile x1
1~3 Meter

PC Cover x1
Transparent
Frosted
Milky

End Cap x2
1 with hole
1 without hole

Mounting Clip x2
Spring

A4435

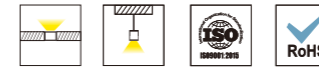

FEATURES

Internal width: 30 mm
Material: Anodized aluminum extrusion
Length: 1~3 meter
Dimension: 44×35 mm
Application: Recessed / Pendant
Customized color can be ordered

PRODUCT SIZE

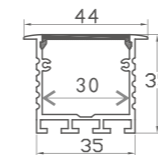

STANDARD ACCESSORIES



Profile x1
1~3 Meter

PC Cover x1
Transparent
Milky/Frosted

End Cap x2
1 with hole
1 without hole



Screw For End Cap x4
KA2. 3x6 mm

Mounting Clip x2
Spring

OPTIONAL ACCESSORIES



Steel rope x1 set

End cap x2pcs
Metal



CONNECTOR (Optional)



L shape X shape T shape



1) C1: 180° connector
2) C2: 90° surface connector
3) C3: 90° vertical connector
4) HM4x4mm screw

PROJECT



C6532



FEATURES

Internal Width: 39.18 mm
 Material: Anodized aluminum extrusion
 Length: 1~3 meter
 Dimension: 65x32 mm
 Application: Recessed / Pendant
 Customized color can be ordered



PRODUCT SIZE

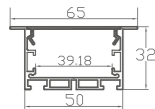

STANDARD ACCESSORIES

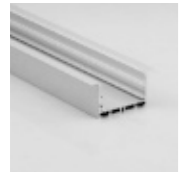

Profile x1
1~3 Meter



PC Cover x1
Transparent
Milky/Frosted



End Cap x2
1 with hole
1 without hole



Screw For End Cap x4
KM2x5 mm



Mounting Clip x4
Spring

CONNECTOR (Optional)



L shape



X shape



T shape



- 1) C1: 180° connector
- 2) C2: 90° surface connector
- 3) C3: 90° vertical connector
- 4) HM4x4mm screw

PROJECT



C1809



FEATURES

Internal width: 5mm
 Material: Anodized aluminum extrusion
 Length: 1~3 meter
 Dimension: 17.4x8.5mm
 Application: Recessed
 Customized color can be ordered

PRODUCT SIZE

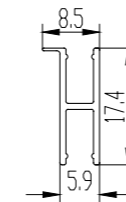

STANDARD ACCESSORIES



Profile x1
1~3 Meter



PC Cover x1



C1710



FEATURES

Internal width: 8 mm
 Material: Anodized aluminum extrusion
 Length: 1~3 meter
 Dimension: 17.2x9.8 mm
 Application: Recessed
 Customized color can be ordered

PRODUCT SIZE

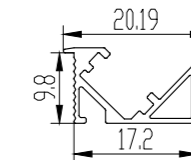

STANDARD ACCESSORIES



Profile x1
1~3 Meter



PC Cover x1



End Cap x2
1 with hole
1 without hole



C9032



FEATURES

Internal width: 64.18 mm
 Material: Anodized aluminum extrusion
 Length: 1~3 meter
 Dimension: 90×32 mm
 Application: Recessed
 Customized color can be ordered

PRODUCT SIZE

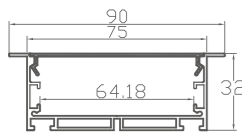

STANDARD ACCESSORIES



B1616



FEATURES

Internal width: 10.2 mm
 Material: Anodized aluminum extrusion
 Length: 1~3 meter
 Dimension: 16×16 mm
 Application: Corner
 Customized color can be ordered

PRODUCT SIZE

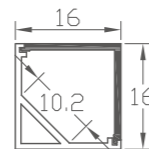

STANDARD ACCESSORIES



C2208



FEATURES

Internal width: 5 mm
 Material: Anodized aluminum extrusion
 Length: 1~3 meter
 Dimension: 22.7×8 mm
 Application: Corner
 Customized color can be ordered

PRODUCT SIZE

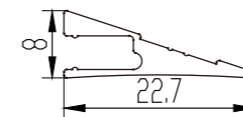

STANDARD ACCESSORIES

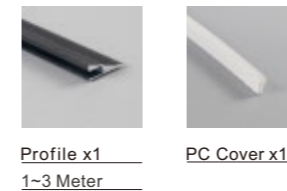

C3413



FEATURES

Internal width: 8 mm
 Material: Anodized aluminum extrusion
 Length: 1~3 meter
 Dimension: 33.8×18.65 mm
 Application: Corner
 Customized color can be ordered

PRODUCT SIZE

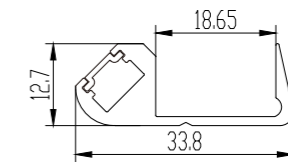

STANDARD ACCESSORIES

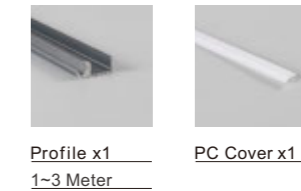

A1616



FEATURES

- Internal width: 10.2 mm
- Material: Anodized aluminum extrusion
- Length: 1~3 meter
- Dimension: 16×16 mm
- Application: Corner
- Customized color can be ordered



PRODUCT SIZE

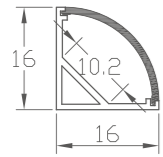

STANDARD ACCESSORIES



Profile x1
1~3 Meter

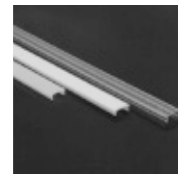

PC Cover x1
Transparent
Milky/Frosted



End Cap x2
1 with hole
1 without hole



Mounting Clip x2
Plastic

OPTIONAL ACCESSORIES

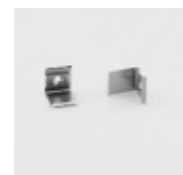

Mounting Clip x2
Metal

CONNECTOR (Optional)



A1616-C1: Inside
Corner



A1616-C2: Outside
Corner

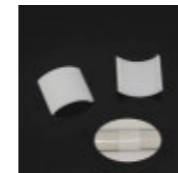

A1616-C3: Straight

PROJECT

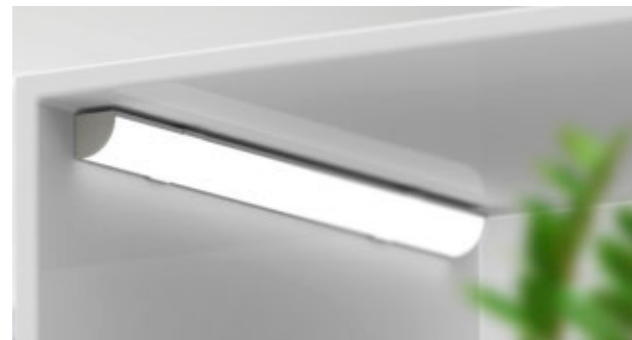

A1919



FEATURES

- Internal width: 12.11 mm
- Material: Anodized aluminum extrusion
- Length: 1~3 meter
- Dimension: 19×19 mm
- Application: Corner
- Customized color can be ordered

PRODUCT SIZE

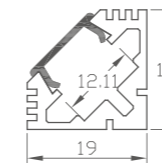

STANDARD ACCESSORIES



Profile x1
1~3 Meter

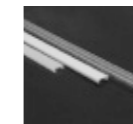

PC Cover x1
Transparent
Frosted
Milky



End Cap x2
1 with hole
1 without hole



Mounting Clip x2
Metal

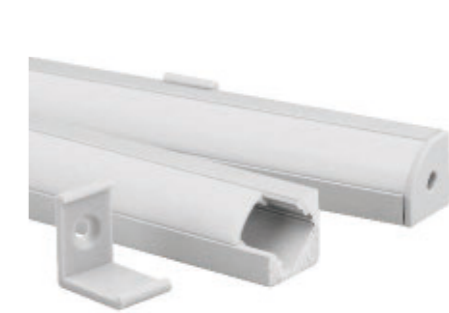

B1919



FEATURES

- Internal width: 12.1 mm
- Material: Anodized aluminum extrusion
- Length: 1~3 meter
- Dimension: 18.5×18.5 mm
- Application: Corner
- Customized color can be ordered

PRODUCT SIZE

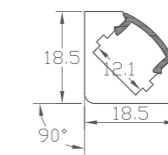

STANDARD ACCESSORIES



Profile x1
1~3 Meter



PC Cover x1
Transparent
Frosted/Milky



End Cap x2
1 with hole
1 without hole



Mounting Clip x2
Plastic

OPTIONAL ACCESSORIES



Mounting Clip x2
Metal



C1919/1919-B



FEATURES

- Internal width: 12.1 mm
- Material: Anodized aluminum extrusion
- Length: 1~3 meter
- Dimension: 18.5×18.5 mm
- Application: Corner
- Customized color can be ordered

PRODUCT SIZE

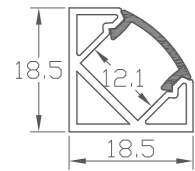

STANDARD ACCESSORIES



OPTIONAL ACCESSORIES



A2016



FEATURES

- Internal width: 12 mm
- Material: Anodized aluminum extrusion
- Length: 1~3 meter
- Dimension: 20×16 mm
- Application: Corner
- Customized color can be ordered

PRODUCT SIZE

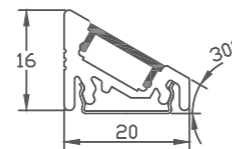

STANDARD ACCESSORIES



A3010



FEATURES

- Internal width: 12.43 mm
- Material: Anodized aluminum extrusion
- Length: 1~3 meter
- Dimension: 30×10.5 mm
- Application: Recessed
- Customized color can be ordered

PRODUCT SIZE

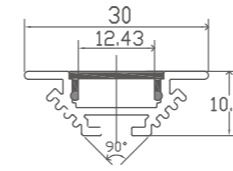

STANDARD ACCESSORIES



A3109



FEATURES

- Internal width: 12.1 mm
- Material: Anodized aluminum extrusion
- Length: 1~3 meter
- Dimension: 30.9×8.8 mm
- Application: Corner
- Customized color can be ordered

PRODUCT SIZE

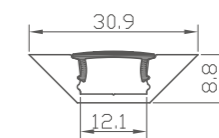

STANDARD ACCESSORIES





A3030



FEATURES

Internal width: 20.9 mm
 Material: Anodized aluminum extrusion
 Length: 1~3 meter
 Dimension: 30×30 mm
 Application: Corner
 Customized color can be ordered

PRODUCT SIZE

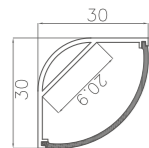

STANDARD ACCESSORIES

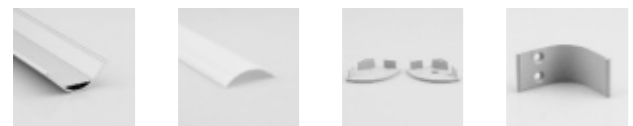

Profile x1
1~3 Meter

PC Cover x1
Transparent
Frosted
Milky

End Cap x2
1 with hole
1 without hole

Mounting Clip x2
Plastic

CONNECTOR (Optional)



Inside Corner

Outside Corner

Straight



B3030



FEATURES

Internal width: 20.9 mm
 Material: Anodized aluminum extrusion
 Length: 1~3 meter
 Dimension: 30×30 mm
 Application: Corner
 Customized color can be ordered

PRODUCT SIZE

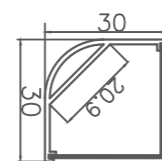

STANDARD ACCESSORIES

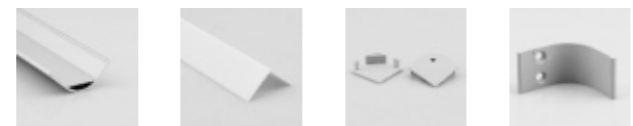

Profile x1
1~3 Meter

PC Cover x1
Transparent
Frosted
Milky

End Cap x2
1 with hole
1 without hole

Mounting Clip x2
Plastic

B4420



FEATURES

Internal width: 11.8 mm
 Material: Anodized aluminum extrusion
 Length: 1~3 meter
 Dimension: 44×20 mm
 Application: Surface
 Customized color can be ordered



PRODUCT SIZE

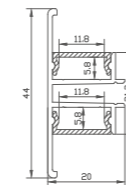

STANDARD ACCESSORIES



Profile x1
1~3 Meter

PC Cover x2
Transparent
Frosted
Milky

Mounting Clip
Plastic

Connector
Plastic
Inside/Outside
Straight/X-shape
L-shape/T-shape

CONNECTOR (Optional)

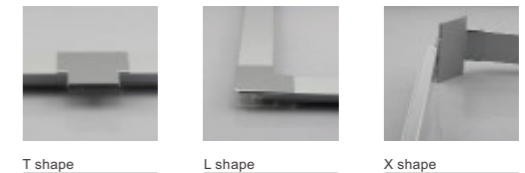

T shape

L shape

X shape

A4535



FEATURES

Internal width: 15.2 mm
 Material: Anodized aluminum extrusion
 Length: 1~3 meter
 Dimension: 45x34.5 mm
 Application: Ceiling decoration
 Customized color can be ordered



PRODUCT SIZE

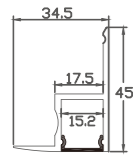

STANDARD ACCESSORIES

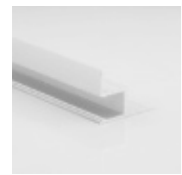

Profile x1
1~3 Meter

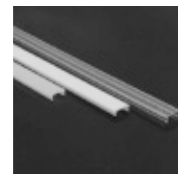

PC Cover x1
Transparent
Milky/Frosted



End Cap x2
1 with hole
1 without hole

PROJECT

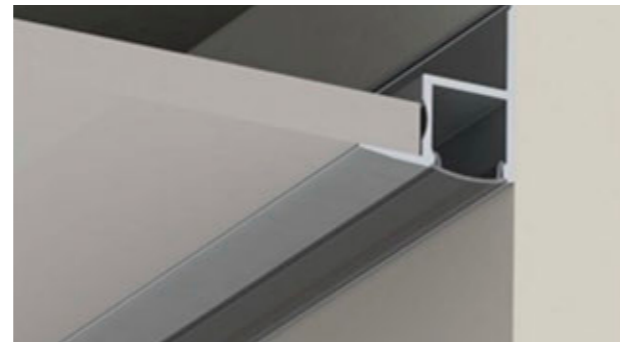

A6014



FEATURES

Internal width: 21.1 mm
 Material: Anodized aluminum extrusion
 Length: 1~3 meter
 Dimension: 60.55x14.17 mm
 Application: Gypsum / Plaster recessed lighting
 Customized color can be ordered

PRODUCT SIZE

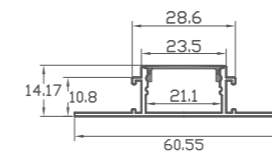

STANDARD ACCESSORIES



Profile x1
1~3 Meter

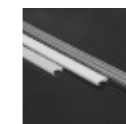

PC Cover x1
Transparent
Frosted
Milky



End Cap x2
1 with hole
1 without hole



C3315



FEATURES

Internal width: 8 mm
 Material: Anodized aluminum extrusion
 Length: 1~3 meter
 Dimension: 33x15 mm
 Application: Surface
 Customized color can be ordered

PRODUCT SIZE

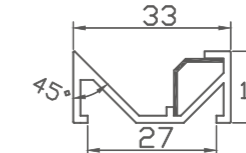

STANDARD ACCESSORIES



Profile x1
1~3 Meter



PC Cover x1
Transparent
Frosted
Milky



End Cap x2
1 with hole
1 without hole



Mounting Clip x2
Metal



C5320



FEATURES

- Internal width: 8.2 mm
- Material: Anodized aluminum extrusion
- Length: 1~3 meter
- Dimension: 53×20 mm
- Application: Recessed
- Customized color can be ordered

PRODUCT SIZE

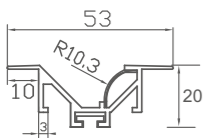

STANDARD ACCESSORIES



Mounting Clip x2
Spring



W001/W001-W



FEATURES

- Internal width: 12.1 mm
- Material: Anodized aluminum extrusion
- Length: 1~3 meter
- Dimension: 17.9×40.7 mm
- Application: Surface
- Customized color can be ordered

PRODUCT SIZE

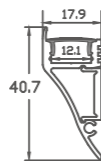

STANDARD ACCESSORIES



OPTIONAL ACCESSORIES



Mounting Clip x2
Metal



W003



FEATURES

- Internal width: 12.4 mm
- Material: Anodized aluminum extrusion
- Length: 1~3 meter
- Dimension: 70×29.2 mm
- Application: Recessed
- Customized color can be ordered

PRODUCT SIZE

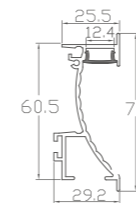

STANDARD ACCESSORIES



Mounting Clip x2
Spring



W004



FEATURES

- Internal width: 10.5 mm
- Material: Anodized aluminum extrusion
- Length: 1~3 meter
- Dimension: 56.3×22.22 mm
- Application: Gypsum / Plaster Inner corner lighting
- Customized color can be ordered

PRODUCT SIZE

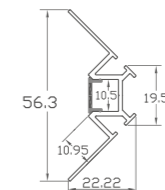

STANDARD ACCESSORIES

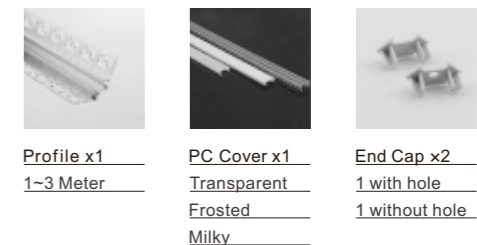



W005



FEATURES

- Internal width: 10.5 mm
- Material: Anodized aluminum extrusion
- Length: 1~3 meter
- Dimension: 39.4×27.1 mm
- Application: Gypsum / Plaster Inner corner lighting
- Customized color can be ordered

PRODUCT SIZE

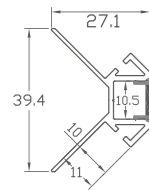

STANDARD ACCESSORIES

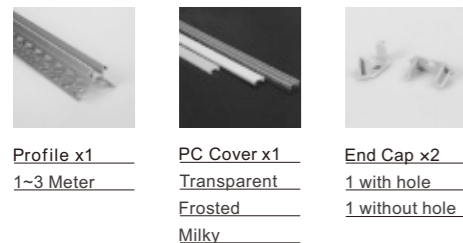

W006



FEATURES

- Internal width: 20 mm
- Material: Anodized aluminum extrusion
- Length: 1~3 meter
- Dimension: 115×43.8 mm
- Application: Stair
- Customized color can be ordered

PRODUCT SIZE

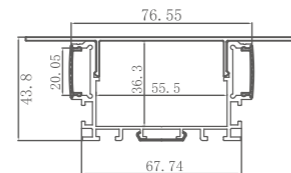

STANDARD ACCESSORIES

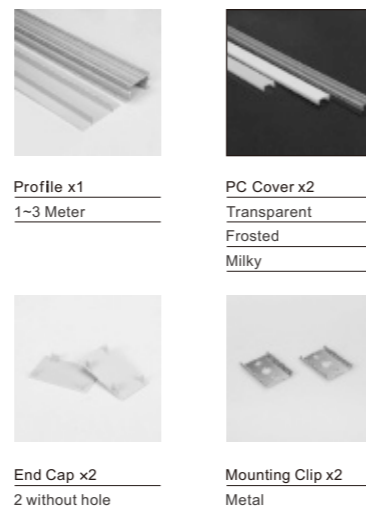

W007



FEATURES

- Internal width: 14.2 mm
- Material: Anodized aluminum extrusion
- Length: 1~3 meter
- Dimension: 54×14.6 mm
- Application: Gypsum / Plaster recessed lighting
- Customized color can be ordered

PRODUCT SIZE

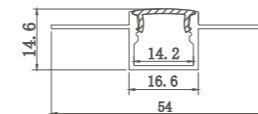

STANDARD ACCESSORIES

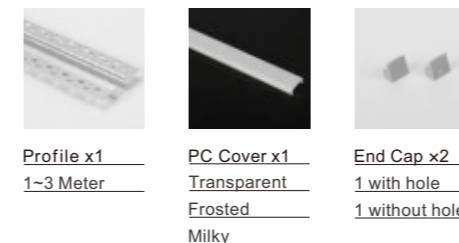

W008



FEATURES

- Internal width: 36.9 mm
- Material: Anodized aluminum extrusion
- Length: 1~3 meter
- Dimension: 88×18.6 mm
- Application: Gypsum / Plaster recessed lighting
- Customized color can be ordered

PRODUCT SIZE

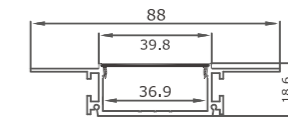

STANDARD ACCESSORIES

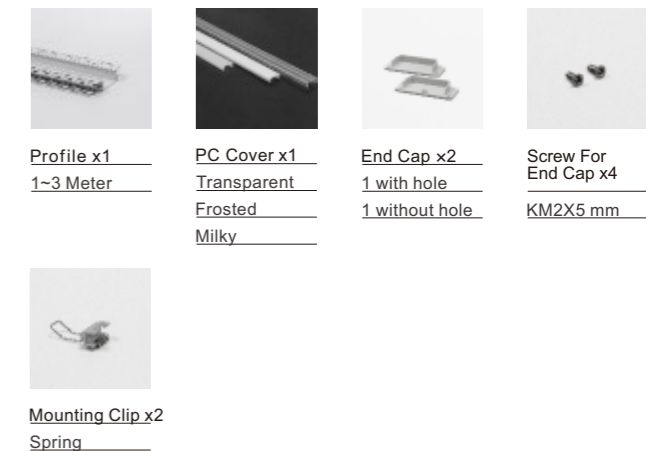

CONNECTOR (Optional)





W009



FEATURES

Material: Anodized aluminum extrusion
Length: 1~3 meter
Application: Surface
Customized color can be ordered

PRODUCT SIZE

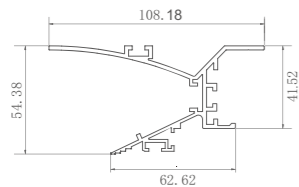

STANDARD ACCESSORIES



Profile x1
1~3 Meter



W011



FEATURES

Internal width: 14.24 mm
Material: Anodized aluminum extrusion
Length: 1~3 meter
Dimension: 54x15.01 mm
Application: Cabinet,supermarket,home furnishings
Customized color can be ordered

PRODUCT SIZE

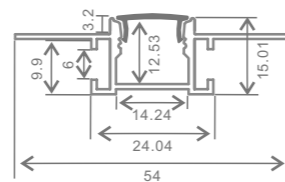

STANDARD ACCESSORIES



Profile x1
1~3 Meter



PC Cover x1
Transparent
Frosted
Milky



End Cap x2
1 with hole
1 without hole

CONNECTOR (Optional)



L shape



X shape



T shape



W012



FEATURES

Internal width: 21. 1 mm
Material: Anodized aluminum extrusion
Length: 1~3 meter
Dimension: 71. 6x14 mm
Application: Cabinet,supermarket,home furnishings
Customized color can be ordered

PRODUCT SIZE

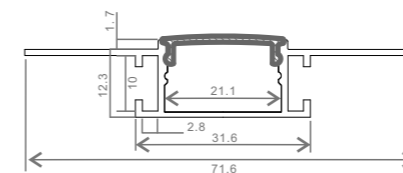

STANDARD ACCESSORIES



Profile x1
1~3 Meter



PC Cover x1
Transparent
Frosted
Milky



End Cap x2
1 with hole
1 without hole

CONNECTOR (Optional)



L shape



X shape



T shape



W4010



FEATURES

Internal width: 10. 29 mm
Material: Anodized aluminum extrusion
Length: 1~3 meter
Dimension: 41.07x9. 76mm
Application: Cabinet,supermarket,home furnishings
Customized color can be ordered

PRODUCT SIZE

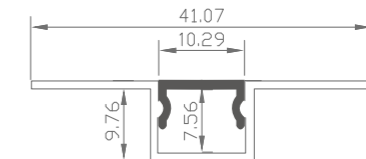

STANDARD ACCESSORIES



Profile x1
1~3 Meter



PC Cover x1
Transparent
Frosted
Milky



End Cap x2
1 with hole
1 without hole



B1908



FEATURES

Internal width: 11.2 mm
 Material: Anodized aluminum extrusion
 Length: 1~3 meter
 Dimension: 19.2×8.5 mm
 Application: Floor
 Customized color can be ordered

PRODUCT SIZE

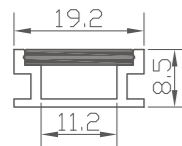

STANDARD ACCESSORIES

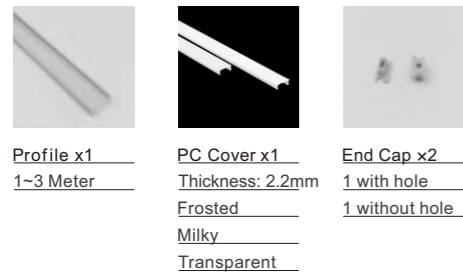

Profile x1
1~3 Meter

PC Cover x1
Thickness: 2.2mm
Frosted
Milky
Transparent

End Cap x2
1 with hole
1 without hole



C2626



FEATURES

Internal width: 17 mm
 Material: Anodized aluminum extrusion
 Length: 1~3 meter
 Dimension: 26×26 mm
 Application: Floor
 Customized color can be ordered

PRODUCT SIZE

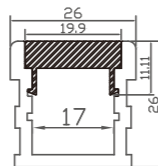

STANDARD ACCESSORIES

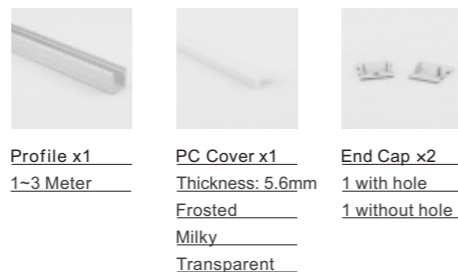

Profile x1
1~3 Meter

PC Cover x1
Thickness: 5.6mm
Frosted
Milky
Transparent

End Cap x2
1 with hole
1 without hole

S001/S001-B



FEATURES

Internal width: 12.2 mm
 Material: Anodized aluminum extrusion
 Length: 1~3 meter
 Dimension: 59.2×21.7 mm
 Application: Stair
 Customized color can be ordered



PRODUCT SIZE

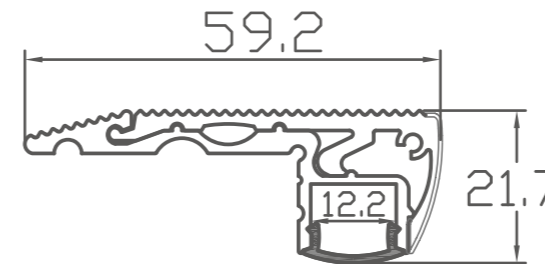

STANDARD ACCESSORIES



Profile x1
1~3 Meter

PC Cover x1
Transparent
Frosted
Milky

End Cap x2
1 with hole
1 without hole

Screw For End Cap x2
KA2.6X8 mm

S002



FEATURES

Internal width: up 8mm and down 10mm
 Material: Anodized aluminum extrusion
 Length: 1~3 meter
 Dimension: 80.98×41.60 mm
 Application: Stair
 Customized color can be ordered



PRODUCT SIZE

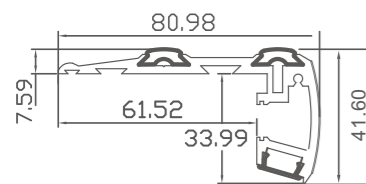

STANDARD ACCESSORIES

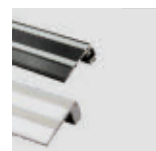

Profile x1
1~3 Meter

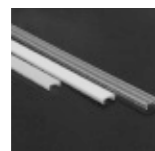

PC Cover x1
Transparent
Frosted
Milky



End Cap x2
1 with hole
1 without hole



Screw For End Cap x2
KA3X8 mm



Anti-slip Rubber x2
1~3 Meter

S003



FEATURES

Internal width: 14.2 mm
 Material: Anodized aluminum extrusion
 Length: 1~3 meter
 Dimension: 65.99×27.36 mm
 Application: Stair
 Customized color can be ordered



PRODUCT SIZE

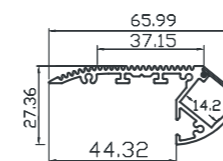

STANDARD ACCESSORIES

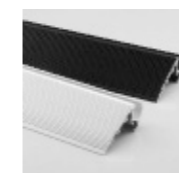

Profile x1
1~3 Meter

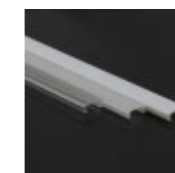

PC Cover x1
Transparent
Frosted
Milky



End Cap x2
1 with hole
1 without hole



Screw For End Cap x4
KA2.3X10 mm

OPTIONAL ACCESSORIES

Row Number



Step-LED





A2820



FEATURES

Internal width: 13.4mm
 Material: Anodized aluminum extrusion
 Length: 1~3 meter
 Dimension: 20.4x28 mm
 Application: Floor
 Customized color can be ordered

PRODUCT SIZE

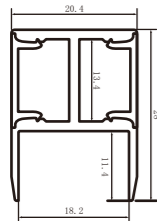

STANDARD ACCESSORIES

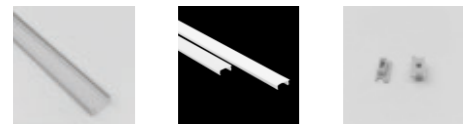

Profile x1
1~3 Meter

PC Cover x1
Thickness: 2.2mm
Frosted
Milky
Transparent

End Cap x2
1 with hole
1 without hole



A2508



FEATURES

Internal width: 5.6 mm
 Material: Anodized aluminum extrusion
 Length: 1~3 meter
 Dimension: 25x8 mm
 Application: Recessed
 Customized color can be ordered

PRODUCT SIZE

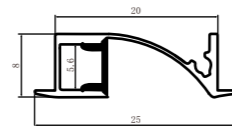

STANDARD ACCESSORIES

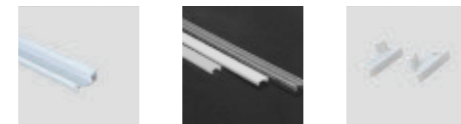

Profile x1
1~3 Meter

PC Cover x1
Transparent
Frosted
Milky

End Cap x2
1 with hole
1 without hole



IP001



FEATURES

Internal width: 12.5 mm
 Material: PC
 Length: 1~3 meter
 Dimension: 17x14.9 mm
 IP Rate: IP65 with silicone resin encapsulated
 Customized color can be ordered

PRODUCT SIZE

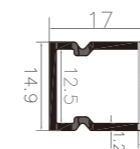

STANDARD ACCESSORIES



Profile x1
1~3 Meter

End Cap x2
1 with hole
1 without hole

Mounting Clip x2

OPTIONAL ACCESSORIES



Aluminum Slat For LED Strip



IP002



FEATURES

Internal width: 8.91 mm
 Material: PC
 Length: 1~3 meter
 Dimension: 11.4x11.4 mm
 IP Rate: IP65 with silicone resin encapsulated
 Customized color can be ordered

PRODUCT SIZE

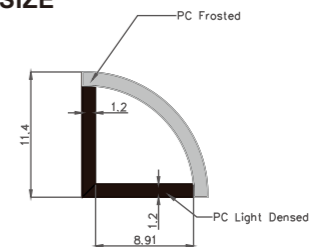

STANDARD ACCESSORIES



Profile x1
1~3 Meter

End Cap x2
1 with hole
1 without hole

Mounting Clip x2

OPTIONAL ACCESSORIES



Aluminum Slat For LED Strip



IP003



FEATURES

- Internal width: 10.2 mm
- Material: PMMA
- Length: 1~3 meter
- Dimension: 14×18.5 mm
- IP Rate: IP65 with silicone resin encapsulated
- Customized color can be ordered

PRODUCT SIZE

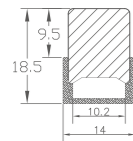

STANDARD ACCESSORIES



PMMA Profile x1
1~3 Meter
Mounting Clip x2
Metal

IP004



FEATURES

- Internal width: 17 mm
- Material: PMMA
- Length: 1~3 meter
- Dimension: 25×19.3 mm
- IP Rate: IP65 with silicone resin encapsulated
- Customized color can be ordered

PRODUCT SIZE

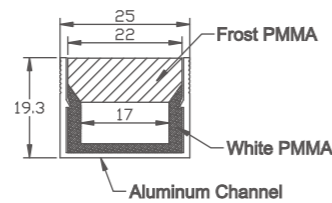

STANDARD ACCESSORIES



PMMA Profile x1
1~3 Meter

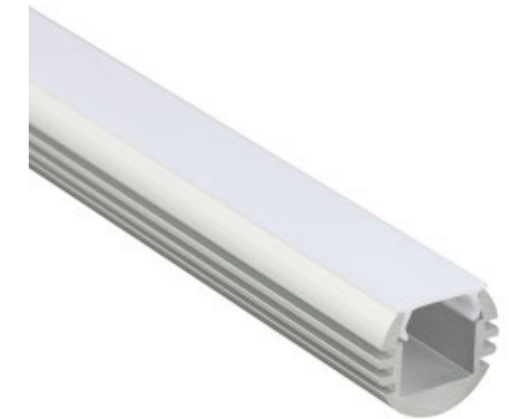

IP004+A2519



FEATURES

- Internal width: 17 mm
- Material: PMMA
- Length: 1~3 meter
- Dimension: 25×19.3 mm
- IP rate: IP65 with silicone resin encapsulated
- Customized color can be ordered

PRODUCT SIZE

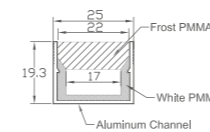

STANDARD ACCESSORIES



PMMA Profile IP004 x1
Aluminum Profile A2519 x1
End Cap x2
1 with hole
1 without hole

OPTIONAL ACCESSORIES



Aluminum Slat For LED Strip

A1818



FEATURES

- Internal width: 11.2 mm
- Material: Anodized aluminum extrusion
- Length: 1~3 meter
- Dimension: 18.42×16.6 mm
- Application: Surface
- Customized color can be ordered

PRODUCT SIZE

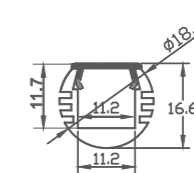

STANDARD ACCESSORIES



Profile x1
1~3 Meter
PC Cover x1
Transparent
Frosted
Milky
End Cap x2
1 with hole
1 without hole
Mounting Clip x2
Metal

R001

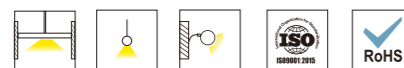

FEATURES

Internal width: 12.2 mm
 Material: Anodized aluminum extrusion
 Length: 1~3 meter
 Dimension: 23.9x23.9 mm
 Application: Wardrobe/Cabinet/Ceiling
 Customized color can be ordered

PRODUCT SIZE

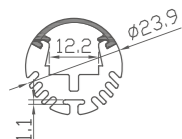

STANDARD ACCESSORIES



Profile x1
1~3 Meter

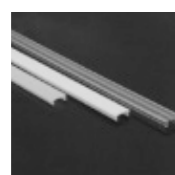

PC Cover x1
Transparent
Milky / Frosted



End Cap x2
1 with hole
1 without hole

OPTIONAL ACCESSORIES



End cap closet
A1

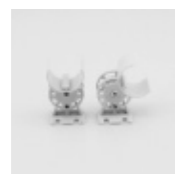

Angle adjustable wall clip
A2



Hanging fixture
A3



1.5m steel rope x1 set
A4



Wall mounting fixtures
A5

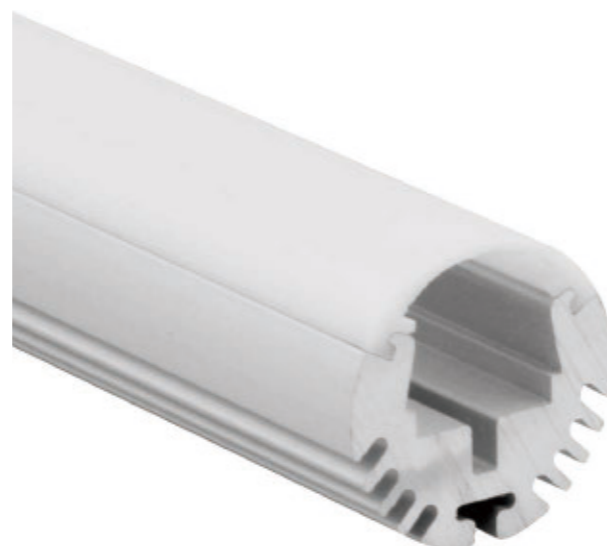

PROJECT

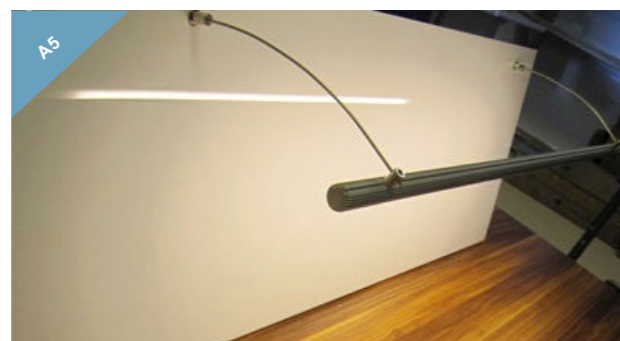
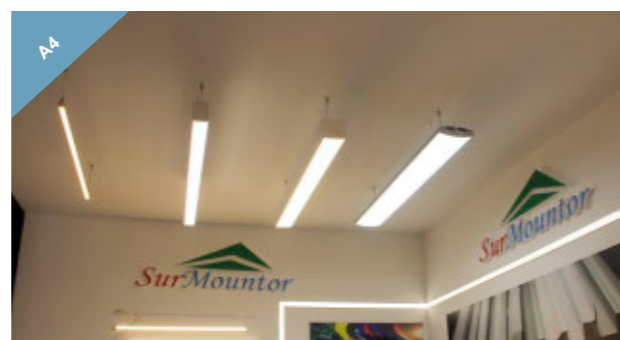

R002



FEATURES

Internal width: 12.2 mm
 Material: Anodized aluminum extrusion
 Length: 1~3 meter
 Dimension: 20.8x20.8 mm
 Application: Pendant
 Customized color can be ordered

PRODUCT SIZE

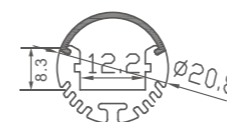

STANDARD ACCESSORIES



Profile x1
1~3 Meter

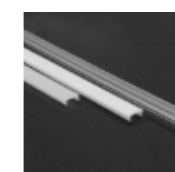

PC Cover x1
Transparent
Milky
Frosted



End Cap x2
1 with hole
1 without hole

OPTIONAL ACCESSORIES



Hanging fixture
A3



1.5m steel rope x1 set
A4



PROJECT



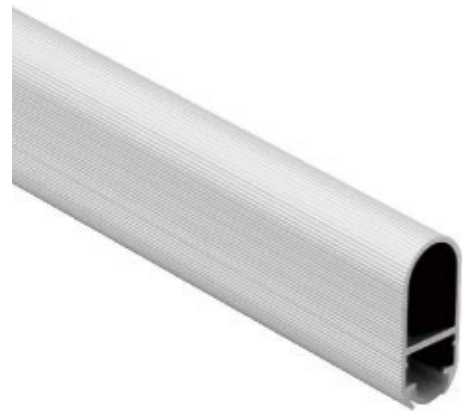

R003



FEATURES

Internal width: 11.8 mm
 Material: Anodized aluminum extrusion
 Length: 1~3 meter
 Dimension: 29.77×14.5 mm
 Application: Wardrobe
 Customized color can be ordered

PRODUCT SIZE

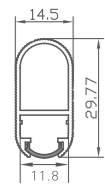

STANDARD ACCESSORIES



Profile x1
1~3 Meter

PC Cover x1
Transparent
Frosted
Milky

OPTIONAL ACCESSORIES



Metal End Cap **Hanging Bracket**



R60



FEATURES

Internal width: 30 mm
 Material: Anodized aluminum extrusion
 Length: 1~3 meter
 Dimension: 59.8x59.8 mm
 Application: Pendant
 Beam angle: 180°
 Customized color can be ordered

PRODUCT SIZE

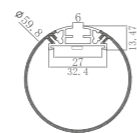

STANDARD ACCESSORIES



Profile x1
1~3 Meter

PC Cover x1
Transparent
Frosted
Milky

End Cap x2
Screw For End Cap x4
KA3x8 mm

OPTIONAL ACCESSORIES



1.5m steel rope x1 set

A1732

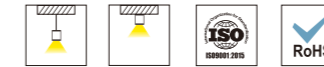

FEATURES

Internal width: 12 mm
 Material: Anodized aluminum extrusion
 Length: 1~3 meter
 Dimension: 17.44×31.45 mm
 Application: Pendant/Surface
 Light up and down
 Customized color can be ordered

PRODUCT SIZE

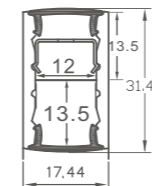

STANDARD ACCESSORIES

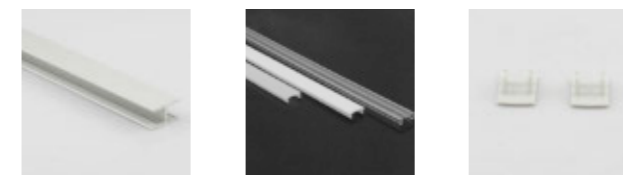

Profile x1
1~3 Meter

PC Cover x2
Transparent
Milky/Frosted

End Cap x2
2 without hole



Mounting Clip x2
Metal

OPTIONAL ACCESSORIES



1.5m steel rope x1 set **180°connector** **HM4x4 screw**



PROJECT



F3545



FEATURES

- Internal width: 31 mm
- Material: Anodized aluminum extrusion
- Length: 1~3 meter
- Dimension: 35x45.05 mm
- Application: Pendant
- Customized color can be ordered



PRODUCT SIZE

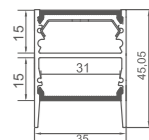

STANDARD ACCESSORIES

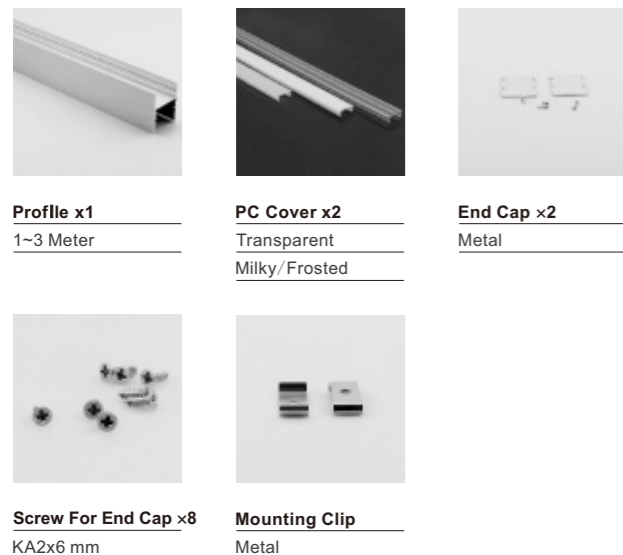

OPTIONAL ACCESSORIES



1.5m steel rope x1 set

PROJECT



A3565



FEATURES

- Internal width: 30.2 mm
- Material: Anodized aluminum extrusion
- Length: 1~3 meter
- Dimension: 35x65 mm
- Application: Pendant
- Light up and down
- 220V AC driver can be put inside the aluminum profile
- Customized color can be ordered



PRODUCT SIZE

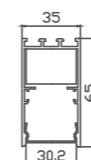

STANDARD ACCESSORIES

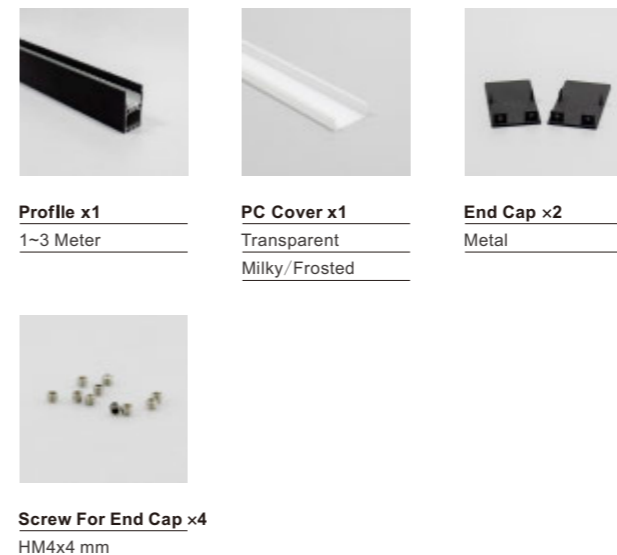

PROJECT



C3535



FEATURES

- Internal width: 24.18 mm
- Material: Anodized aluminum extrusion
- Length: 1~3 meter
- Dimension: 35x35 mm
- Application: Pendant / Surface
- Customized color can be ordered

PRODUCT SIZE

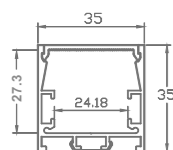

STANDARD ACCESSORIES

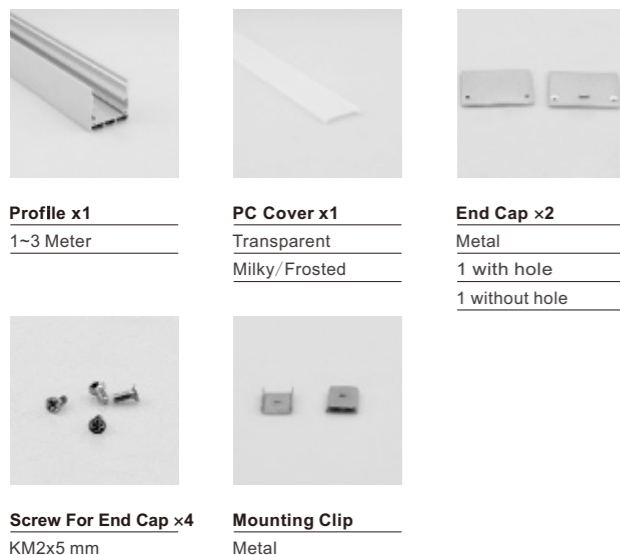

OPTIONAL ACCESSORIES



1.5m steel rope x1 set

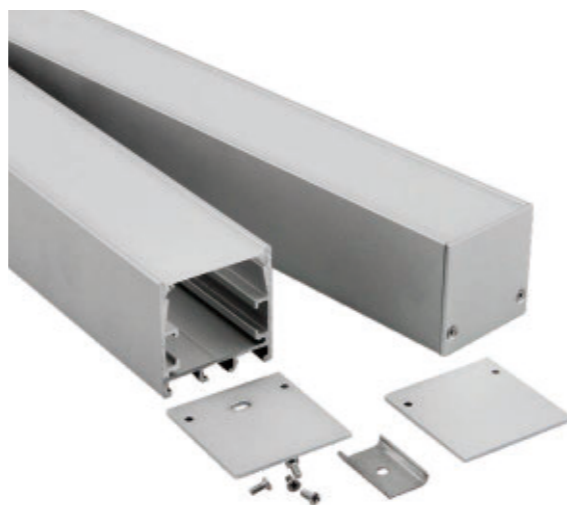

CONNECTOR (Optional)

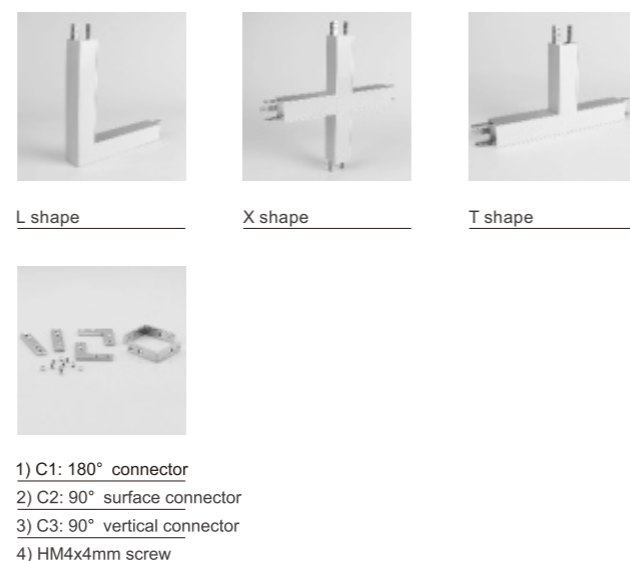

PROJECT

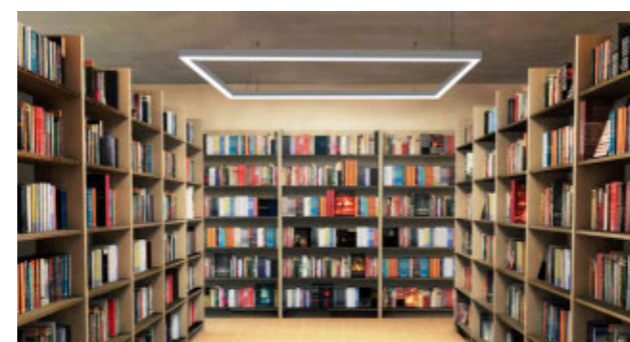

A5570/A5570-B/A5570-W



FEATURES

- Internal width: 37 mm
- Material: Anodized aluminum extrusion
- Length: 1~3 meter
- Dimension: 55x70 mm
- Application: Pendant / Surface
- 220V AC driver can be put inside the aluminum profile
- Customized color can be ordered

PRODUCT SIZE

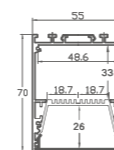

STANDARD ACCESSORIES

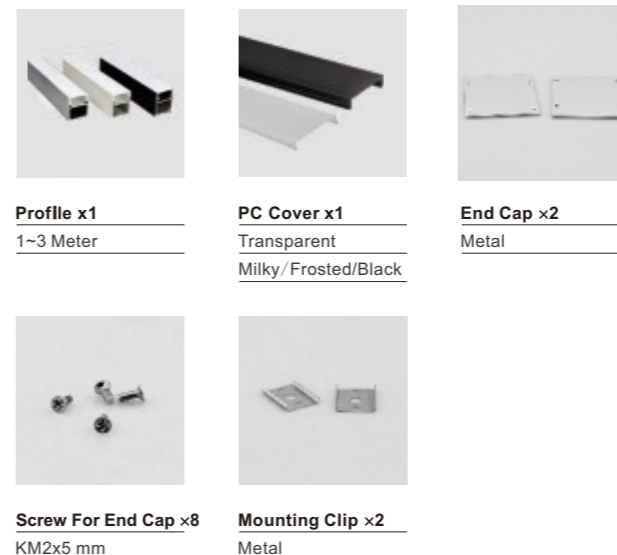

OPTIONAL ACCESSORIES

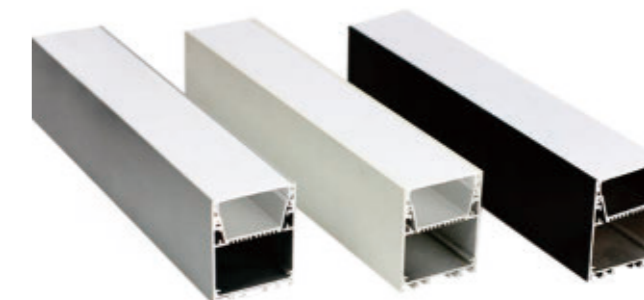
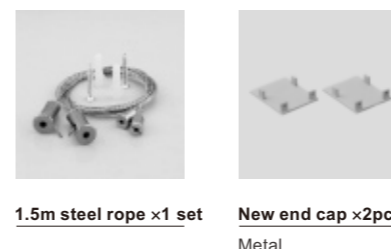

CONNECTOR (Optional)

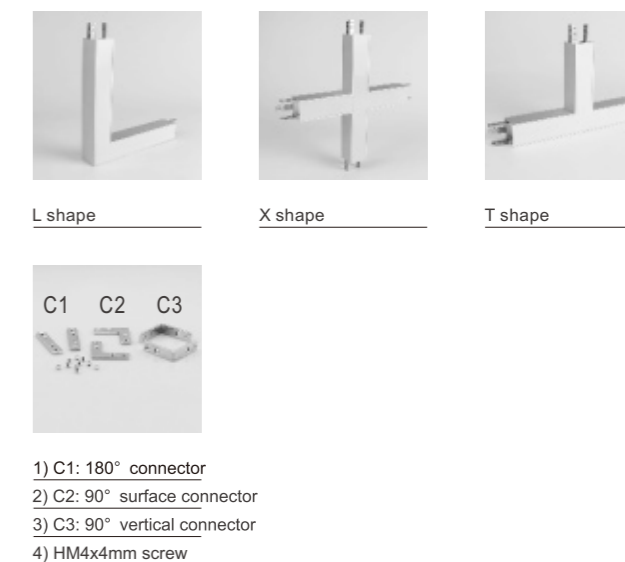

PROJECT



A5580



FEATURES

- Internal width: 47 mm
- Material: Anodized aluminum extrusion
- Length: 1~3 meter
- Dimension: 55x80 mm
- Application: Pendant / Surface
- 220V AC driver can be put inside the aluminum profile
- Customized color can be ordered



PRODUCT SIZE

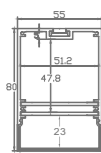

STANDARD ACCESSORIES



- Profile x1**
1~3 Meter
- B5580: Steel bar inter-connector**
- PC Cover x1**
Transparent
Milky/Frosted



- End Cap x2**
Metal
- Screw For End Cap x8**
KA2x6 mm

OPTIONAL ACCESSORIES



- 1.5m steel rope x1 set**
- C5580: Steel bar inter-connector (A5580/A9080)**

PROJECT



A9080



FEATURES

- Internal width: 86 mm
- Material: Anodized aluminum extrusion
- Length: 1~3 meter
- Dimension: 90x80 mm
- Application: Pendant / Surface
- 220V AC driver can be put inside the aluminum profile
- Customized color can be ordered



PRODUCT SIZE

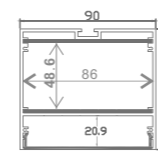

STANDARD ACCESSORIES

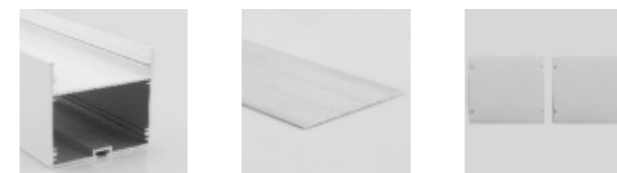

- Profile x1**
1~3 Meter
- B9080: Steel bar inter-connector**
- End Cap x2**
Metal

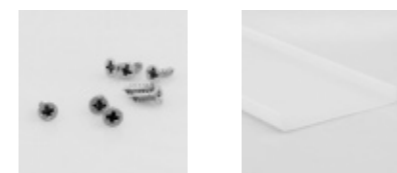

- Screw For End Cap x8**
KA2x6 mm
- PC Cover x1**
Transparent
Milky/Frosted

OPTIONAL ACCESSORIES



- 1.5m steel rope x1 set**
- C9080: Steel bar inter-connector**

PROJECT

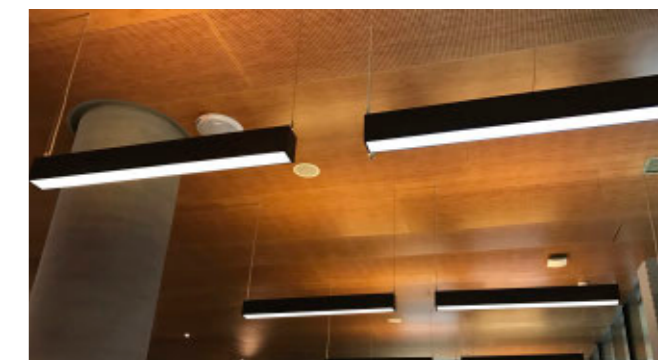

PE001A



FEATURES

- Internal width: 138 mm
- Material: Anodized aluminum extrusion
- Length: 1~3 meter
- Dimension: 153.77x37.2 mm
- Application: Pendant/Surface
- Customized color can be ordered

PRODUCT SIZE

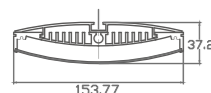

STANDARD ACCESSORIES



Profile x1
1~3 Meter

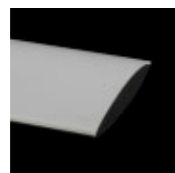

PC Cover x1
Transparent
Milky/Frosted



End Cap x2

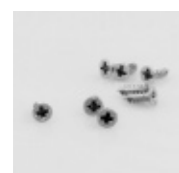

Screw For End Cap x4
KA3x8 mm

OPTIONAL ACCESSORIES



1.5m steel rope x1 set



Hanging plate PE001B



Driver box PE001C
With LED driver built inside
With KA3.5X10 mm screw



PROJECT



Accessories for LED Aluminum Profile



SR01

Rope Size: 1.2MM
Length: 1.5Meter/PC
1Set with 2PCS Ropes+ Accessories



SR02

Rope Size: 1.2MM
Length: 1.5Meter/PC
1Set with 2PCS Ropes+ Accessories



SR03

Rope Size: 3MM
Length: 1.5Meter/PC
1Set with 2PCS Ropes + Accessories



SR04

Conductive Steel Rope
Size: 3MM
Length: 1.5Meter/PC
1Set with 2PCS Ropes + Accessories
(For clips items A1732/ A5570/ C5032/ C7532)



Adjustable Bracket

Angle Adjustable Mounting
Bracket for LED profile. Suitable
for any profiles with mounting Clips.

LED LINEAR SAPP CEILING LIGHT- CLINE

FEATURES

- Model Number: CLINE-800, CLINE-1200, CLINE-1600, CLINE-2000.
- Material: 6063 Extruded aluminum
- Color: White/Black
- Input Voltage: DC24V
- Light Source: San'an
- CRI: 80-95
- Color Temperature: 4000K
- Life Time: 50000h
- Beam Angle: 40/24/14° optional
- Application: Office/Exhibition/Hall



INSTALLATION STEPS

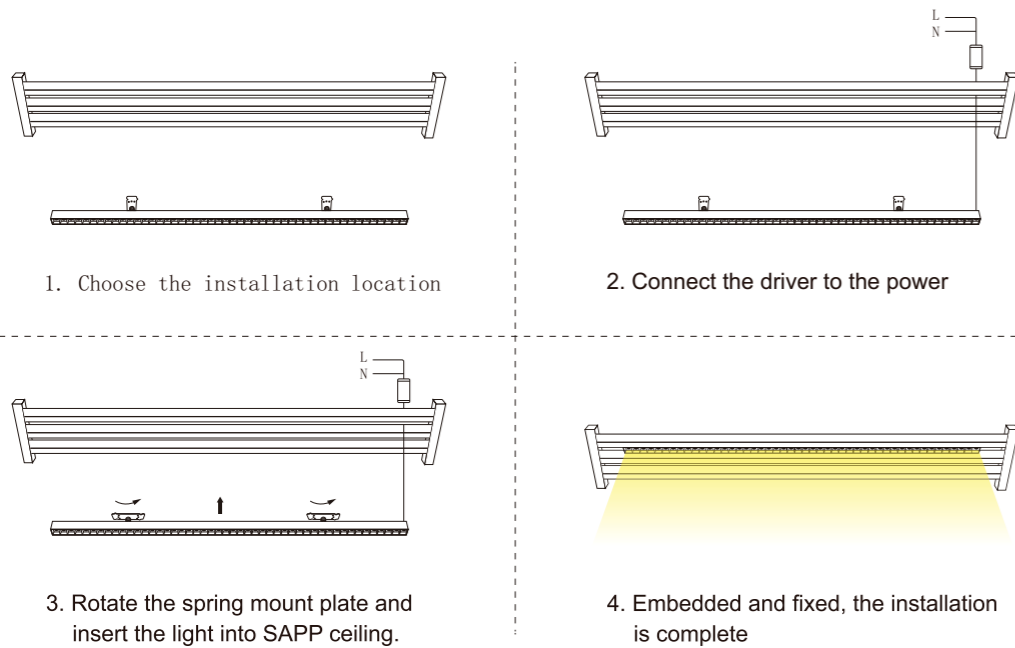

SCENES TO BE USED



LINEAR SYSTEM- STARLINE

FEATURES

- Flexible and convenient installation, minor modifications to the walls.
- High quality material, zinc alloy+stainless steel composition, strong and durable not easy to deformation.
- Fixed rod can be adjusted by 45°, more possibilities suitable for direct, indirect lighting, wall washing lighting and other applications.
- Steel band 25 meter per roll which adapt to the lighting decoration of large space.

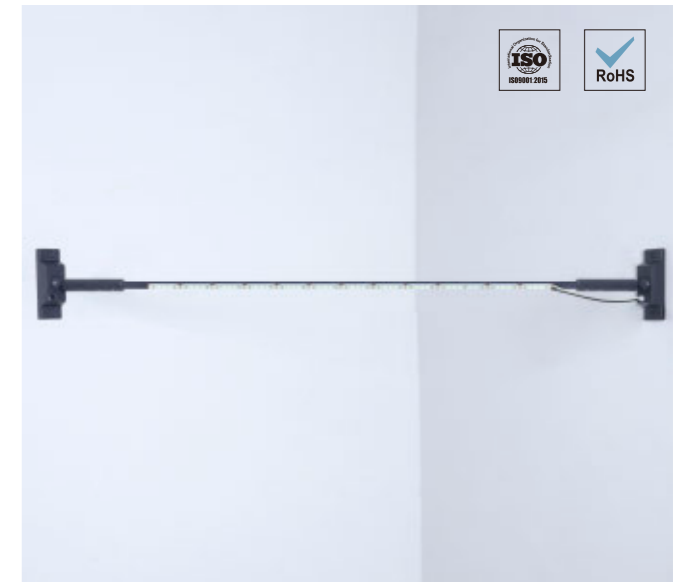

PRODUCT SIZE

Screw Shaft / Cardan Shaft

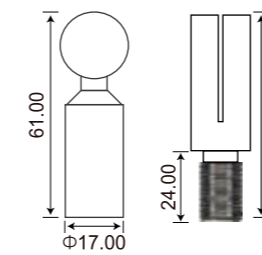

Cardan Shaft Base

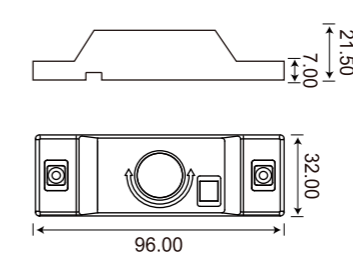

ACCESSORIES



Screw shaft / cardan shaft



Cardan shaft base



Steel band 25 meters/roll



Power supply PCB



Screw

SCENES TO BE USED

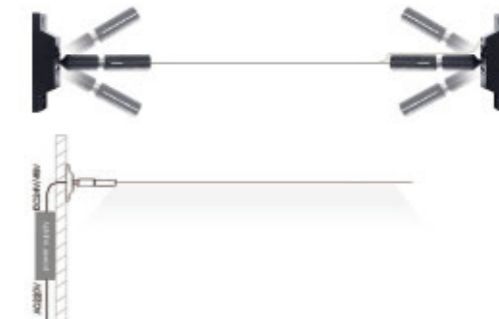
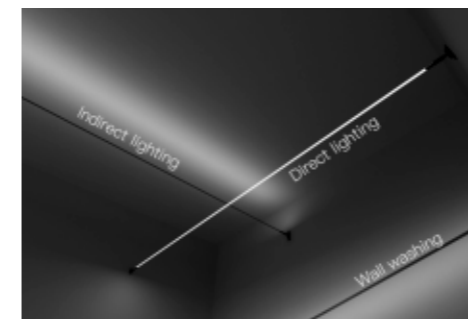

CA01-PIR



FEATURES

- PIR moon sensor built in. Light off/day, light on when human pass within 2 Meters at night, it will turn off in 20 seconds automatically after human body move away more than 2 meters.
- Easy to install.
- Apply for bedroom, cabinet, wardrobe, etc.
- High quality LEDs, super bright.
- Detection distance: $\leq 2m$.
- Life span: $>50,000h$.



SPECIFICATION:

Input voltage: 5V/1A.

Output Voltage: 5V.

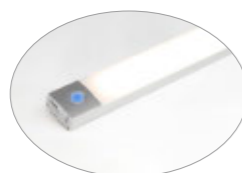

THREE LENGTHS CAN BE CHOSEN.

Length	Power	Lumens	Last 100% light
① 250 mm	0.7W	60	4H
② 430 mm	1.3W	110	4.5H
③ 600 mm	2W	170	3H

THREE KINDS OF FUNCTION SWITCH



AUTO: PIR motion sensor mode.
OFF: turn off the light
ON: the light is always on.

LITHIUM BATTERY POWER SUPPLY



When charging this product, red light is flashing.



When the product is fully charged, red light is always on.



When the product is working, blue light is always on.



When the battery power is not enough, blue light will flash.

PIR MOTION SENSOR DETECTIVE DISTANCE ($\leq 2M$)

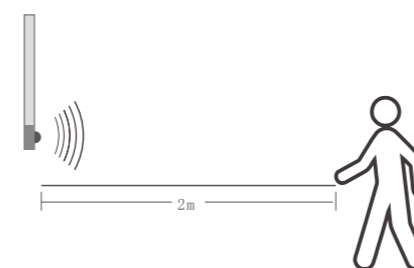

DETECTION ANGLE:



INSTALLATION:

- ① Be installed on iron materials, with built-in magnet.

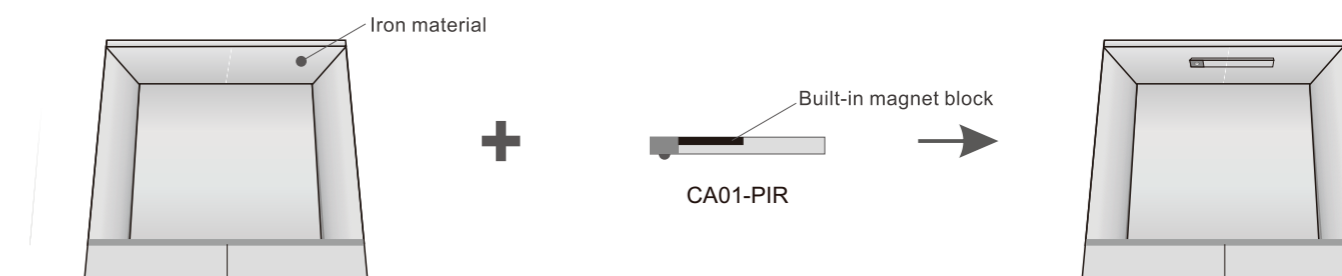

- ② Be installed on non-iron materials, with double sided adhesive tape.

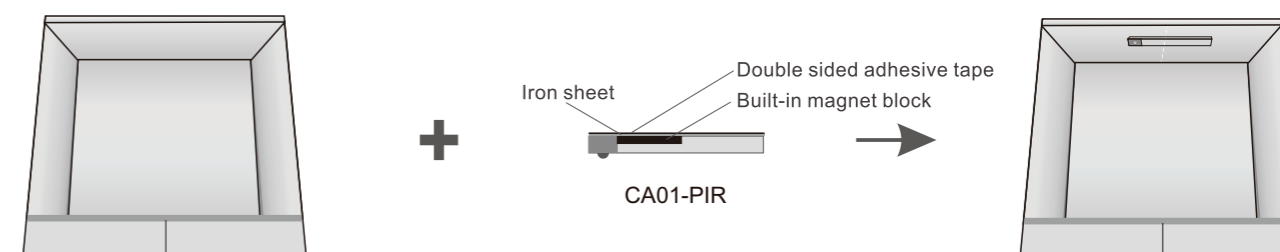

CA01-IR



FEATURES

- Easy to install.
- Apply for bedroom, cabinet, wardrobe, etc.
- High quality LEDs, super bright.
- PIR Detection distance: $\leq 2m$.
- IR Detective Distance: $0.5cm \leq \text{Detection} \leq 10cm$.
- Life span: $>50,000h$.



Two Functions of LED closet Light to switch:

1. Switch to PIR motion sensor function
Light would be ON when people move into the detection range 2meter. Light would be OFF after 20 seconds when people leave this detection range.
2. Switch to IR door sensor function
Light would be ON when the door open and would be OFF when the door close.

SPECIFICATION:

Input voltage: 5V/1A.

Output Voltage: 5V.

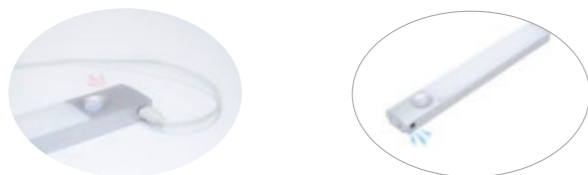

THREE LENGTHS CAN BE CHOSEN.

① 250 mm	0.7W Power	60 Lumens	4H Last 100% light
② 430 mm	1.3W Power	110 Lumens	4.5H Last 100% light
③ 600 mm	2W Power	170 Lumens	3H Last 100% light

STANDARD ACCESSORIES

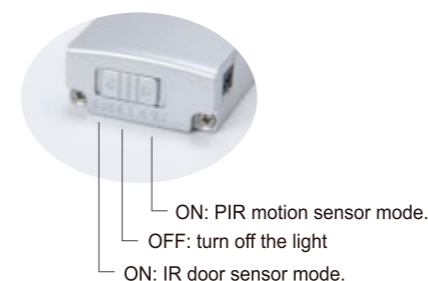

LITHIUM BATTERY POWER SUPPLY

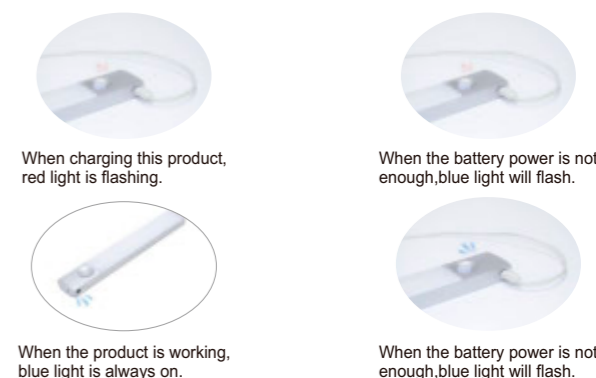

IR MOTION SENSOR DETECTIVE DISTANCE ($\leq 2M$)

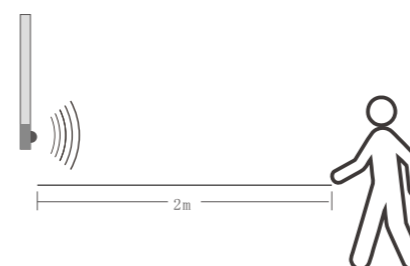

DETECTION ANGLE:



IR MOTION SENSOR DETECTIVE DISTANCE ($0.5CM \leq \text{DETECTION} \leq 10CM$)

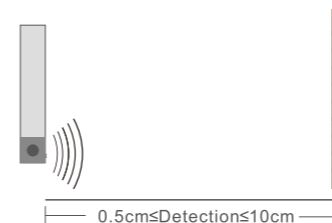

PIR MOTION SENSOR DETECTIVE DISTANCE ($\leq 2M$)

- ① Be installed on iron materials, with built-in magnet.

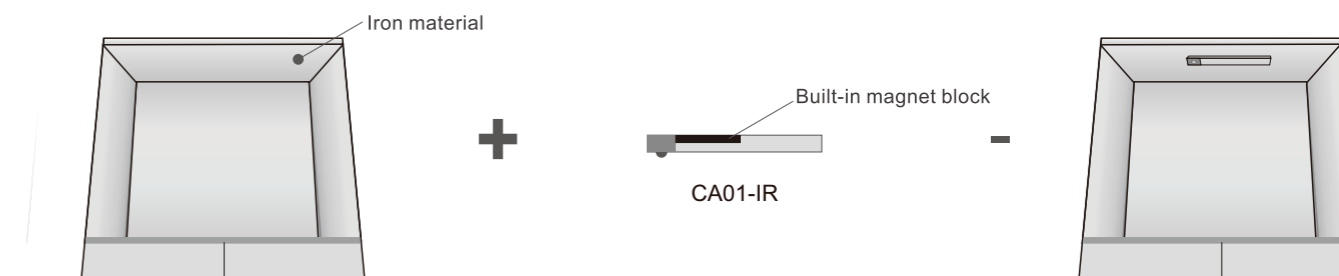

- ② Be installed on non-iron materials, with double sided adhesive tape.

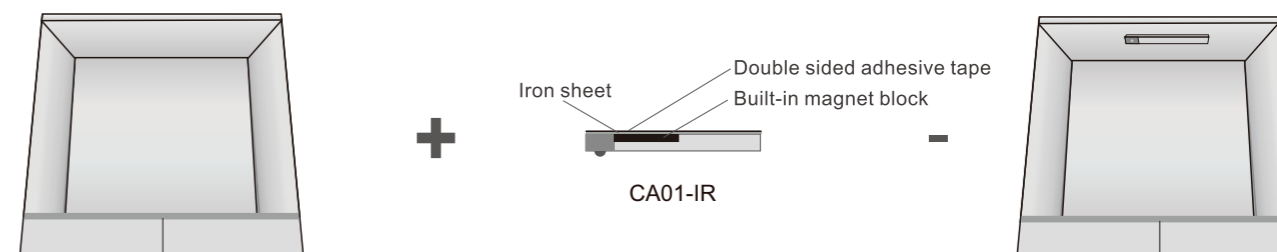

CA01-WIFI



NEW



FEATURES

- Based on Android and IOS system, local and remote control are available. It supports scene effects editing by mobile phone itself.
- It supports automatic detection of new equipment. Network configuration can be done with one click.
- It supports the combination of one-click execution and automatic smart scenes, and the link of scenes and devices, enabling interaction among products.
- It supports Amazon Echo, Google Home and other third-party voice control, which are totally hand-free.
- Considerate permission management and device sharing can be used with no worry.
- Seamless connection with local life, allowing users to easily control smart devices, know the real-time device status and enjoy smart life.

SIZE(mm):

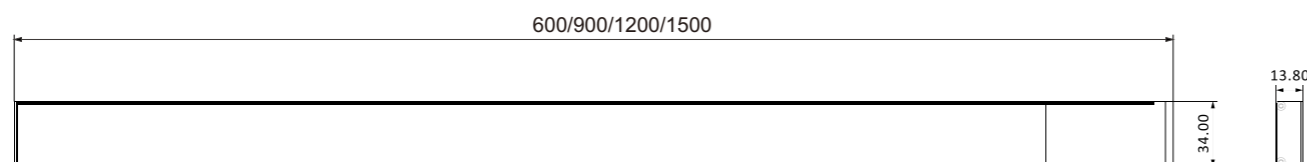

EASY TO INSTALL

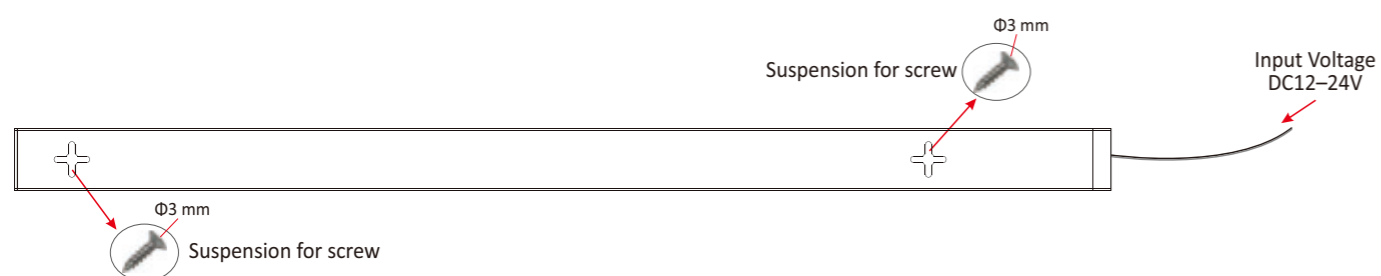

TECHNICAL PARAMETER

Hardware Parameters				
Input Voltage	DC12-24V			
Brightness Range	10%-100%			
Dimming Frequency	1,000Hz			
0V Memory	Yes, it takes effect after maintaining the current state for 5 seconds			
Length=600 mm	Power	8W		
	Color	WW	NW	CW
	LM	640	680	710
Length=900 mm	Power	12.5W		
	Color	WW	NW	CW
	LM	1,000	1,060	1,100
Length=1,200 mm	Power	17W		
	Color	WW	NW	CW
	LM	1,360	1,440	1,500
Length=1,500 mm	Power	21.5W		
	Color	WW	NW	CW
	LM	1,720	1,830	1,900
Network Configuration Parameters				
Trigger Mode of the First Network Distribution	Flashes after manually switching			
Network Distribution Reset	Switch 3 times (ON-OFF-ON -OFF-ON)			
Brightness of Reminder	50%			
Successful Network Distribution	Light of reminder is ON with 100% brightness all the time			

NETWORK GUIDANCE

Please scan below left QR code to down load the Tuya Smart APP or Smart Life App on your mobile phone. And then use Tuya Smart or Smart Life app to scan the below right QR code of the distribution network , and then complete the operation according to the prompt steps



Tuya Smart APP



Smart Life APP



QR code of distribution network, please scan code with Tuya Smart app or Smart Life app.

LINE



FEATURES

Line Light Series				
Model	Power	Lumens		
LINE-1000MM-12V	14.4W	940-1050		
LINE-1000MM-24V	14.4W	940-1050		
With 2835 LED Rigid Strip				
Ra	CCT(K)	Length	Voltage	LED Type
>80	3000K 4000K 6000K	1000MM	DC12V or 24V	SMD2835
		1000MM		



PRODUCT SIZE

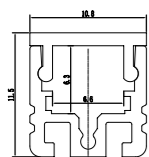

The LED Light is easy to install to wardrobe or shelf with mounting clip accessories. With modern design, it is suitable for cabinet / furniture / room / ceiling hanging lighting etc. Substantial aluminum mass provide good heat sink for high power leds. It's perfect for seamless connection, no dark space.

HOW TO INSTALL:

1, With clip

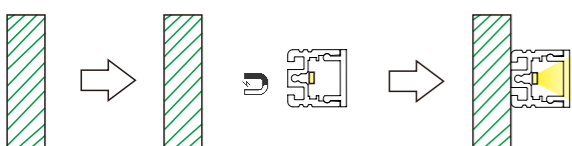

Power input cable
1, VDE 18# cable, 8A max.
2, Length: 100cm(cable length can be customized)



PCB connector
8A max.



Powerful Magnet



Power input cable



Power cable

SCENES TO BE USED

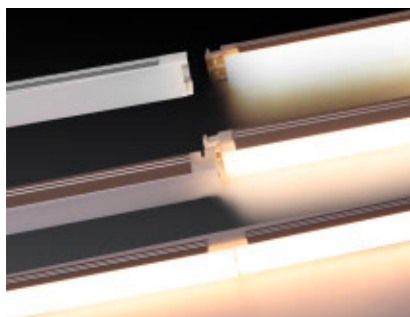

LED CABINET LIGHT-A1110



FEATURES

- Mini LED cabinet light
- I shape, L shape connector available.
- Strong magnetic clip/plastic mounting clips are available.
- The LED light can be connected to another LED light directly by cable connector.



STANDARD ACCESSORIES



Cable Connector



With Strong Magnet



With 0° mounting Bracket



Power Input Cable



I Shape



L Shape

Three Lengths Standard Models Specifications

Model	A1110-560	A1110-860	A1110-1160
Power	7.9W	12.2W	16.6W
Lumens	700 lm	1100 lm	1600 lm
Ra	80	80	80
Size	560 mm	860 mm	1160 mm
Voltage	DC24V (22V~30V)		

SCENES TO BE USED



LINE-B1110



FEATURES

- The Super LED Light Bar is easy to be put onto the metal shelf in the supermarket. Substantial aluminum mass provides good heat sink for high power LEDs. This model is good for shelf lighting. The model equipped with strong magnet plate on the back of the aluminum profile.



SPECIFICATIONS:

LED Profile with LED								
Power	Wattage	Lumens	Ra	CCT(K)	Length	Voltage	LED Type	Package
LINE-B1110-WW	10W	950	>80	3000K	1009mm	DC24V	SMD-2214-160LED/M	The power cable (customized length)
LINE-B1110-NW	10W	1000	>80	4000K	1009mm	DC24V	SMD-2214-160LED/M	The male and female connector (customized length)
LINE-B1110-CW	10W	980	>80	6500K	1009mm	DC24V	SMD-2214-160LED/M	PC end cap.

Customizable information			
Voltage	Power	Customizable length calculation formula	Example
DC12V/DC24V	0.5*N	50*N+9mm (N=Integer) mm	50*20+9mm=Total length1009mm

STANDARD ACCESSORIES

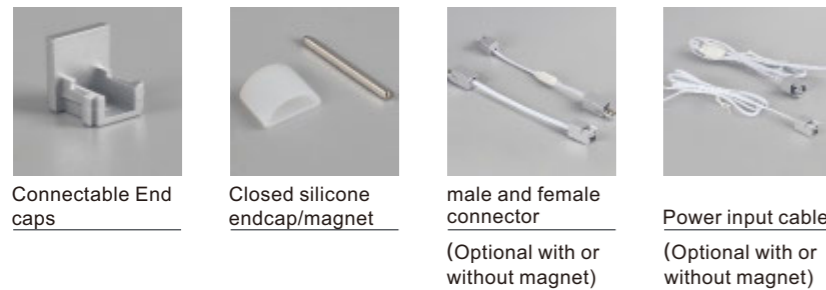

Connectable End caps

Closed silicone endcap/magnet

male and female connector (Optional with or without magnet)

Power input cable (Optional with or without magnet)

SCENES TO BE USED



LED SUPER LIGHT BAR WITH MAGNET-A1713



FEATURES

- Two ways for connecting: Interconnection cable, male and female end cap.
- Angle bracket 0, 30, 45, 60 degree are available for surface mounting.
- With SUR-2835FW120-12/24V Flexible LED strip



STANDARD ACCESSORIES



Power Input Cable

Cable Connector

Model	Super-570	Super-870	Super-1170
Power	8.0W	12.3W	16.6W
Lumens	800lm	1230lm	1660lm
Color	WW	NW	CW
Ra	>80	>80	>80
Size	570 mm	870 mm	1170 mm
Voltage	DC12V/24V		

SCENES TO BE USED

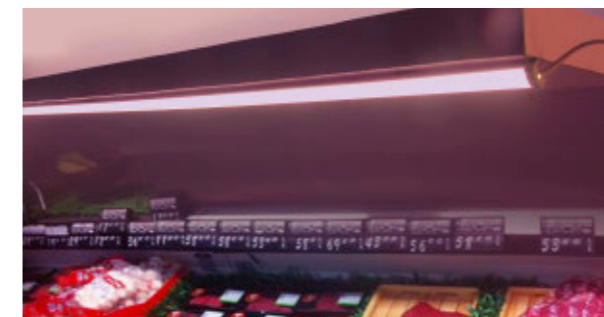
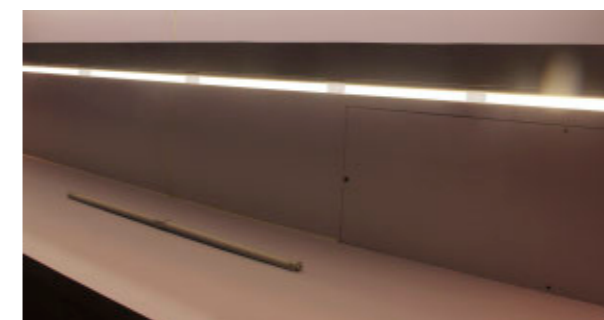

LED LINEAR LIGHT-A1816



FEATURES

- This LED Light can be cut and connected seamlessly by interior connectors.
- Control mode: Can be used with IR/PIR/Touchsensor switches.
- I shape connector.
- The LED light can be connected to another LED light directly by interconnect cable.
- With SMD2835 120 LEDs rigid strip.
- CCT: Warm white, nature white, cool white.

INSTALLATION

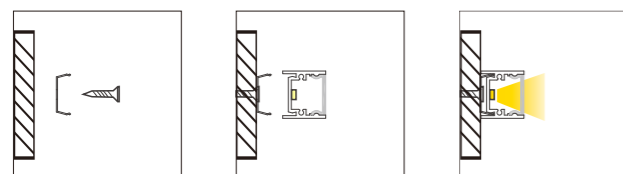

Model	A1816-600	A1816-1000
Power	8.6W	14.4W
Lumens	700-730 lm	1100 -1200lm
Ra	>80	>80
Length	600mm	1000mm
PCB Length For Cutting	25mm or 50mm	25mm or 50mm
Voltage	DC12V or 24V	DC12V or 24V

STANDARD ACCESSORIES



A1816-AS2
Power input connector with 1m 18#VDE cable



A1816-Clip
A1816 Metal Mounting Clips



A1816-EC
A1816 End Caps
1 without hole
1 without hole

OPTIONAL ACCESSORIES



A1816-AS1
Interior connector between 2 lights



A1816-AS4
Double side cable connector with 20cm 18#VDE cable

PROJECT

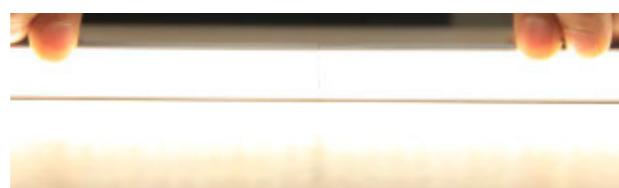

FC-C1707



Model	FC-HE-C1707
Size (mm)	17.4*8.2
Material	6063 T5 Aluminum Alloy
Finish	Aluminum Anodized
Color	Sliver/White/Black
Lighting direction	Front luminous
Installation	Surface mount
Color Temperature	3000K/ 4000K/ 6500K
Voltage	12V/24V
Power(W/PC)	9.6W/M
Power output contact	SlingShot Contact
CRI (RA)	>80

PRODUCT SIZE

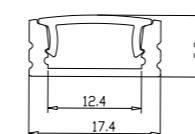

HOW TO INSTALL:

1. With clip

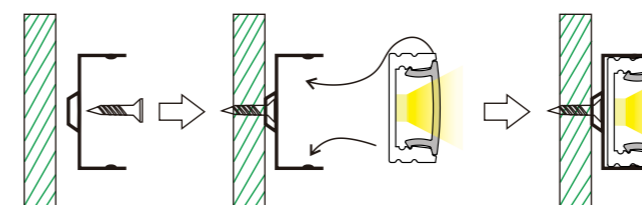

2. With double-sided tap

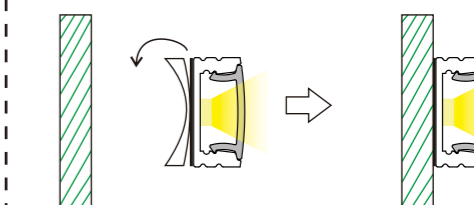

SCENES TO BE USED

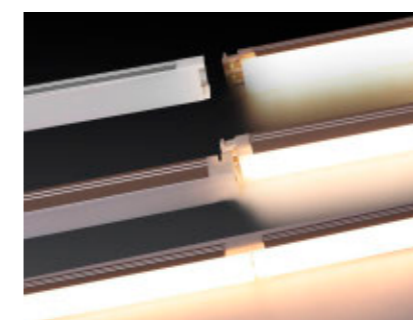

R003E-PIR007



FEATURES

End caps with PIR sensor switch for R003 wardrobe light.

- Automatically ON/OFF.
- Input Voltage: 5V DC.
- Output Voltage: 5V DC.
- Current: 1.2A Max.
- Delay Time: About 20 seconds.



STRUCTURE AND DIMENSIONS (mm):

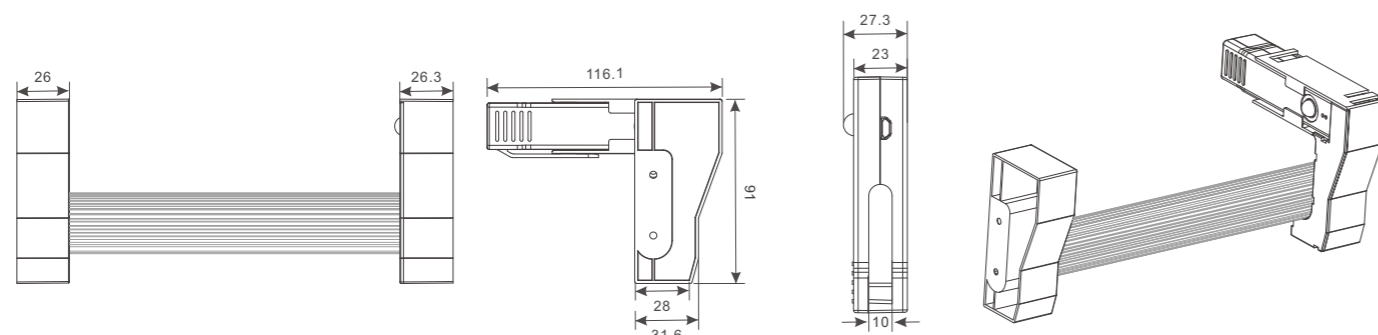

PIR MOTION SENSOR DETECTIVE DISTANCE (≤2M):

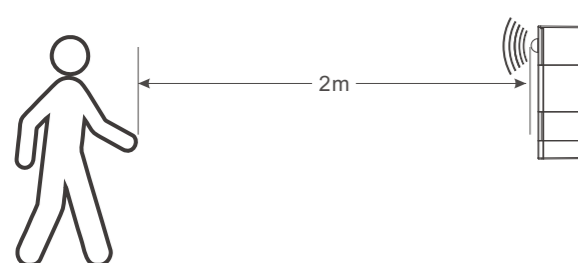

DETECTION ANGLE:

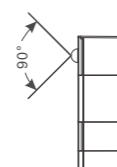

ABOUT PIR007:

Three kinds of function switch: ON-OFF-AUTO

- When the product is charging, red light flashing.
- When the product is fully charged, red light is always on.
- When the product is working, blue light is always on.
- When the appliance is not enough, blue light flashes.

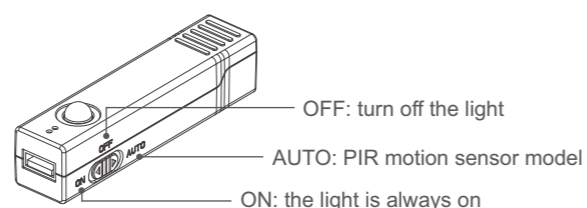

R003E-PIR008

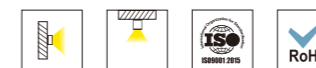

FEATURES

End caps with PIR sensor switch for R003 wardrobe light.

- Automatically ON/OFF.
- Input Voltage: 12V–24V DC.
- Output Voltage: 12V–24V DC
- Loading Power: 2.5A Max.
- Delay Time: About 20 seconds.
- Load around: 30W for 12V, and 60W for 24V.
- PIR sensor switch detector cable length: 1m. (Customized length can be ordered).



STRUCTURE AND DIMENSIONS (mm):

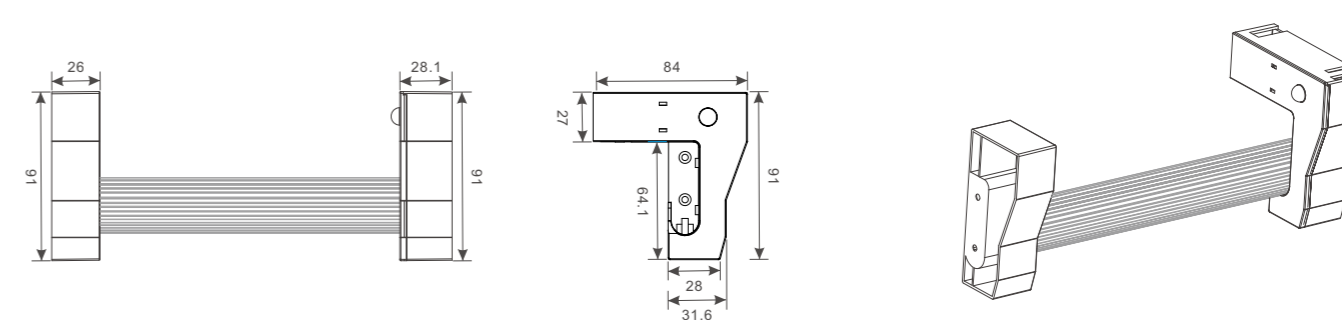

PIR MOTION SENSOR DETECTIVE DISTANCE (≤2M):

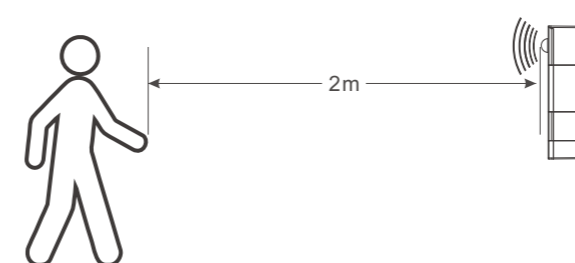

DETECTION ANGLE:

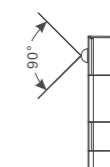

OPERATIONS:

- PIR sensor switch R003E-PIR008 can be assembled with R003 wardrobe LED fixtures, so R003 wardrobe light can automatically turn on when any part of human body is approaching within 2 meters from the sensor.
- The R003 wardrobe light with this PIR sensor switch PIR008 will stay on if the human body stays within 2 meters from the sensor. It will turn off in 20 seconds after human body move away more than 2 meters.

LED LINEAR TRACK LIGHT-A3552



FEATURES

- Universal 3 phase Philip track connector.
- Professional optical design.
- The same product with multiple light distribution is available for different applications.
- AL6063-T5 aluminum profile with high-quality surface treatment and three optional colors of black, white and silver.
- Ultra anti-glare design UGR ≤ 19.
- Lm80 certified Light source, life ≥ 50000h.
- Built-in anti-flicker-free Philips power supply.
- 10°/24°/36°/48°/10*35° multiple optical design, more application.



APPLICATIONS

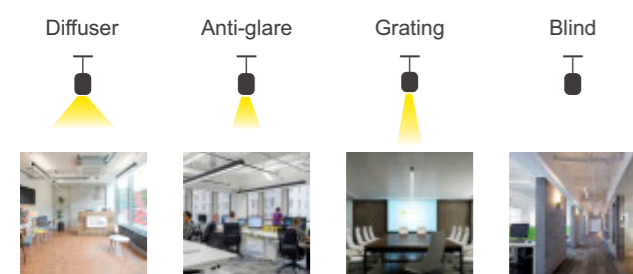

Three Lengths Standard Models Specifications			
Model	A3552-1200	A3552-1200	A3552-1200
Power	38W	38W	38W
Lumens	1800lm	1900lm	2000lm
Color	WW	NW	CW
Ra	>80	>80	>80
Size	L1200*W35*H52	L1200*W35*H52	L1200*W35*H52
Voltage	200-240VAC 50/60HZ		

SCENES TO BE USED

INSTALLATION

With the track

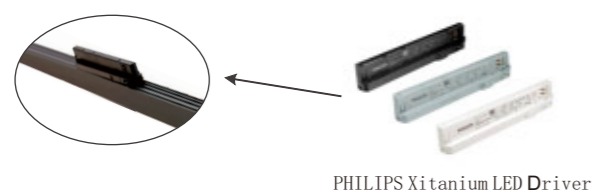

SCENES TO BE USED



LED PENDANT LINEAR LIGHT-A3565



FEATURES

- Professional optical design.
- The same product with multiple light distribution is available for different applications.
- AL6063-T5 aluminum profile with high-quality surface treatment and three optional colors of black, white and silver.
- Ultra anti-glare design UGR ≤ 19.
- Lm80 certified Light source, life ≥ 50000h.
- Built-in anti-flicker-free Philips power supply.
- 10°/24°/36°/48°/10*35° multiple optical design, more application.



APPLICATIONS

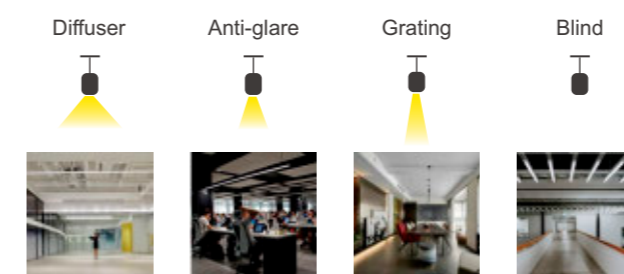

Three Lengths Standard Models Specifications			
Model	A3565-1200	A3565-1800	A3565-2400
Power	38W	53W	71W
Lumens	1800/1900 /2000 lm	2500/2650 /2800 lm	3350/3550 /3750 lm
Color	WW/NW/CW	WW/NW/CW	WW/NW/CW
Ra	>80	>80	>80
Size	L1200*W35*H65	L1800*W35*H65	L2400*W35*H65
Voltage	200-240VAC 50/60HZ		

INSTALLATION

A3565 is suspended from ceiling with stainless steel cable and fixing componentry



SCENES TO BE USED



STR001



FEATURES

- Power Shelf System
- Alu Shelf Power Profile Track(with power track)
- Hook for Wood (left and right), Suitable for Wood Shelf 25mm thickness*1pair"
- Hook for Metal Plates *1pair Suitable for Metal Shelf 21mm"
- Hook for Glass *1pair Suitable for Glass Shelf 10mm"
- Power Connector for Alu Shelf Profile Track
- Power Connector for Shelf Hooks



PRODUCT SIZE

STR001

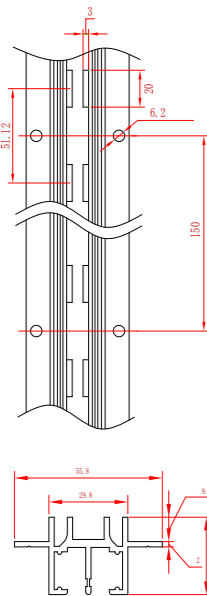

STR001-HT

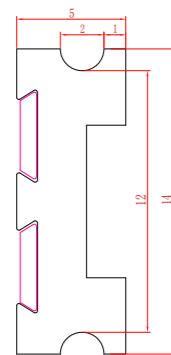

STR001-AP

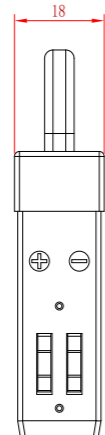

STR001-HP

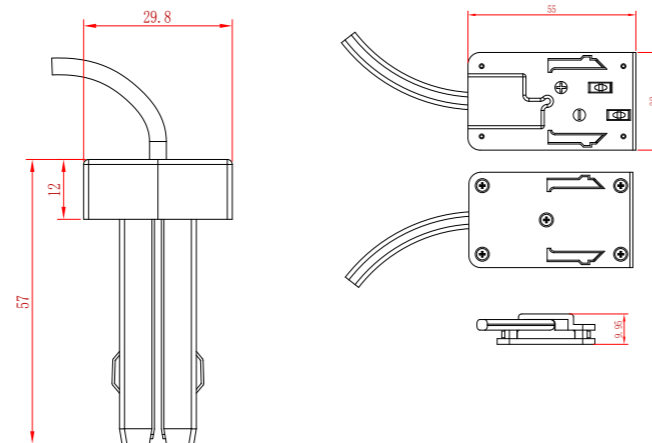

STR001-HM

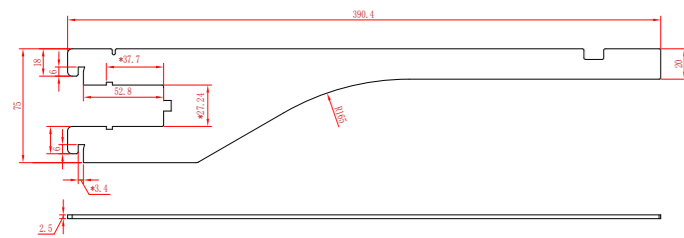

STR001-HG

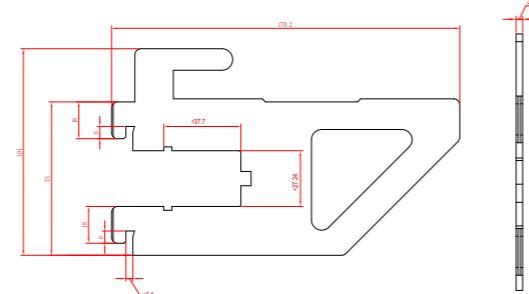

STR001-HL

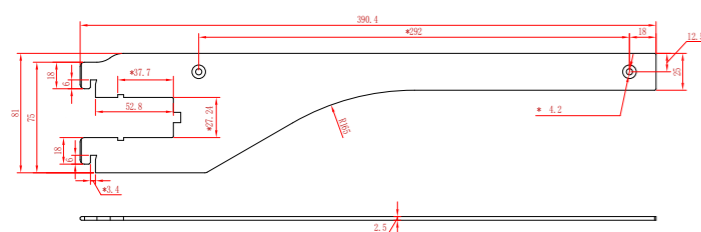

STANDARD ACCESSORIES



STR001



STR001-HT

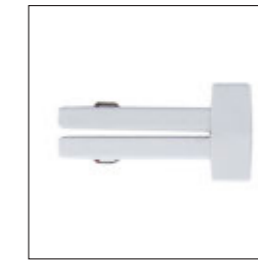

STR001-AP

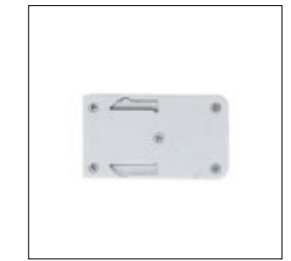

STR001-HP

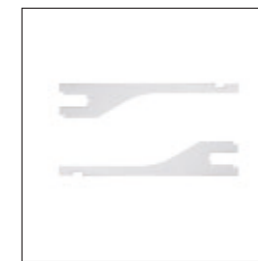

STR001-HM



STR001-HL/HR



STR001-HG

ITR001



FEATURES

- The track is work with 12-24V power supply (customizable), which is convenient for installa an be connected to the power supply a er plugging in.
- According to the needs of different occasions, the space layout can be controlled arbitrarily, The metal panels.
- Max weight to hold up to 30 kg.



STANDARD ACCESSORIES

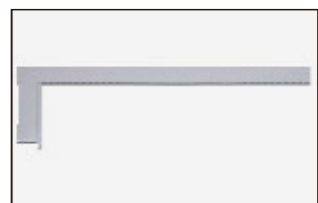

ITR001-POST
(1500/2000mm)

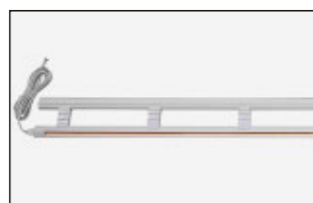

ITR001-HT(Max 8A)

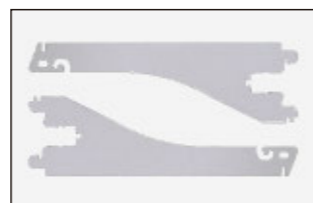

ITR001-BR
(Length 300mm)



ITR001-HP(Max 2A)
Cable length 35mm.



ITR001-BAP



ITR001-SF
(Width 300mm
Length 900/1200mm)



ITR001-BTP
(Width 350mm
Length 900/1200mm)

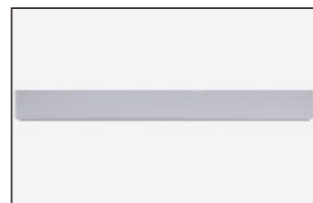

ITR001-FAP
(Length 900/1200mm)

PRODUCT SIZE

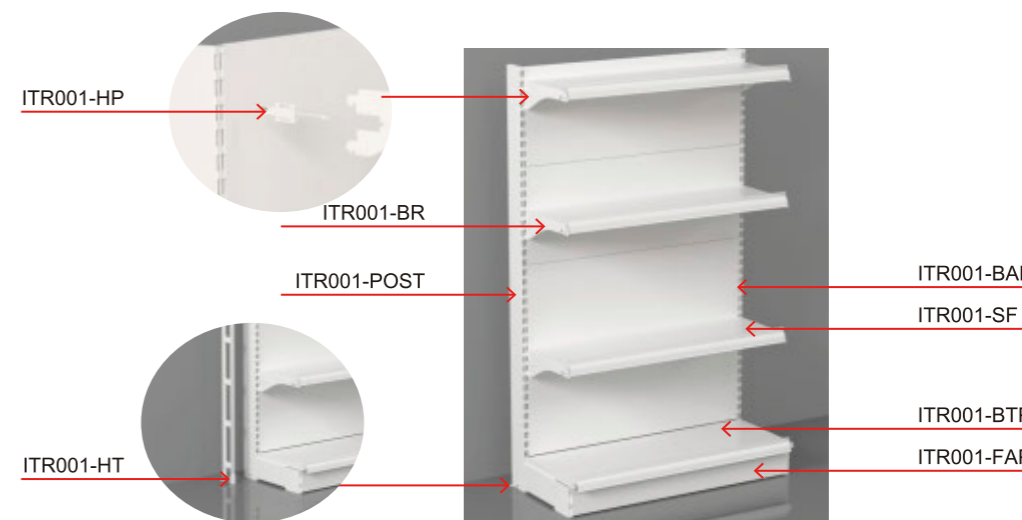
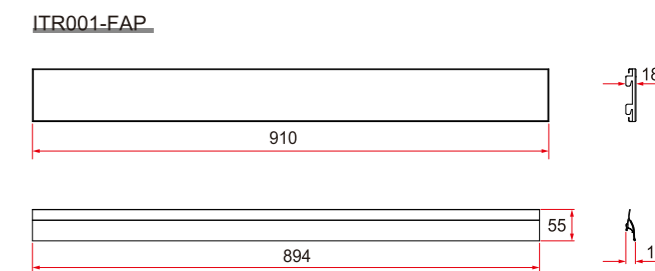
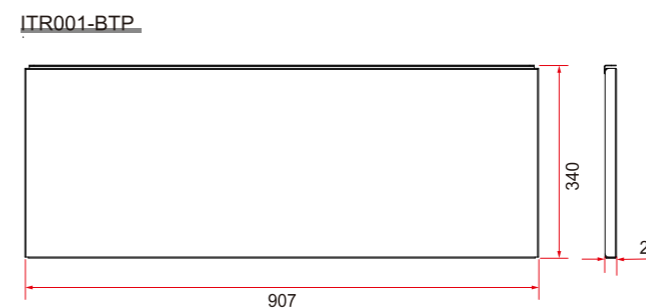
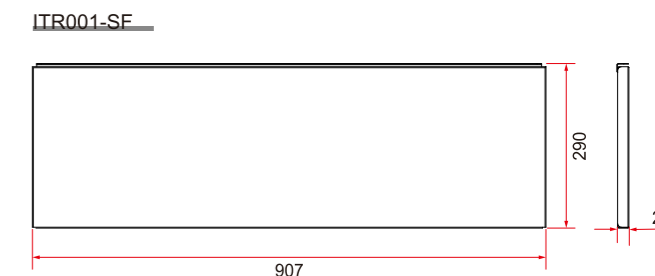
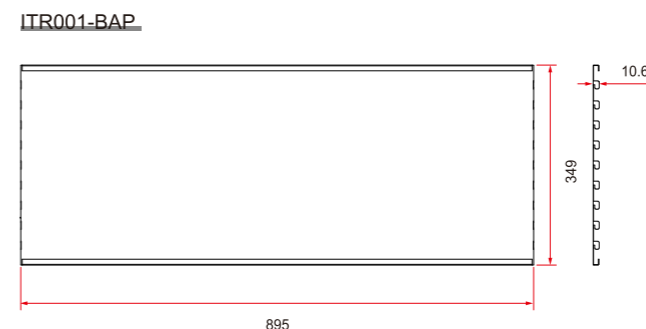
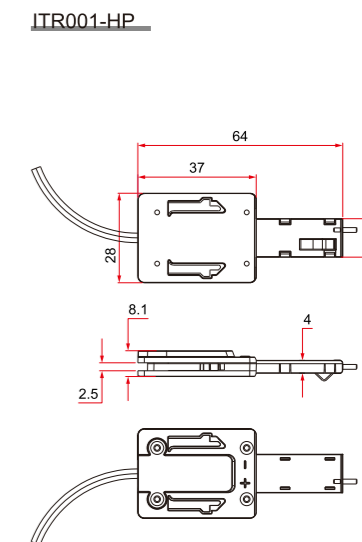
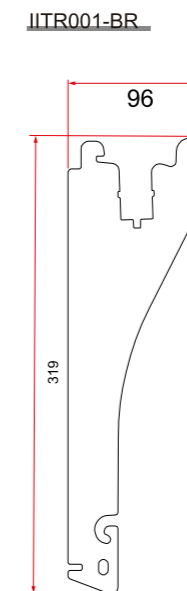
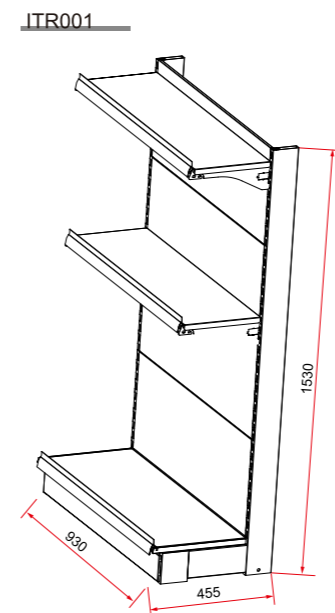
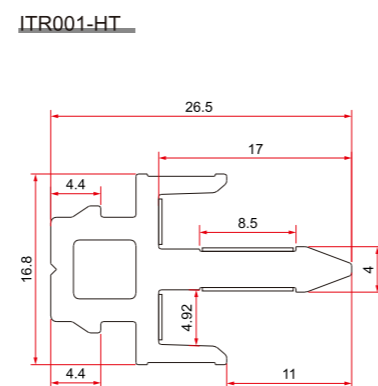
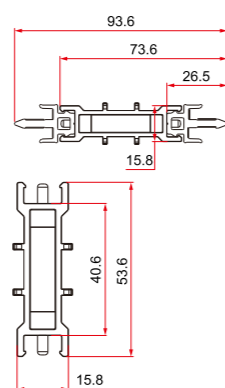
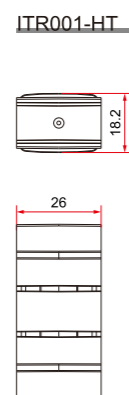
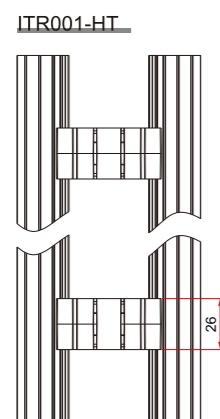
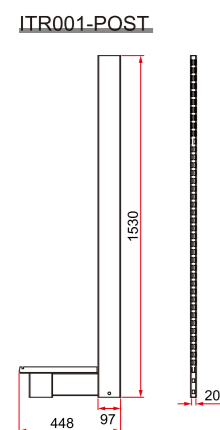

MINI MAGNET POWER TRACK

FEATURES

- Surface mounting on iron materials only.
- Track: 25A max, DC12V-24V.
- Connector: 8A max with VDE #18 cable.
- Color: Black, white, customized color are available.



ACCESSORIES:



MTR01

Track



MTR02

VDE #18 Cable



MTR03

Power Connector

VDE #18 Cable



MTR04

Endcap

SIZE:

MTR01

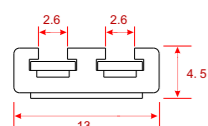

MTR02

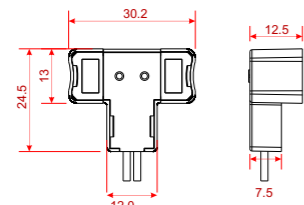

MTR03

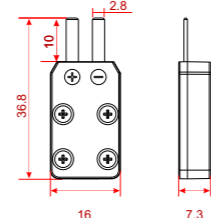

MTR04

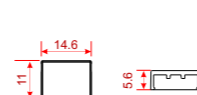

CONNECTION DIAGRAM:

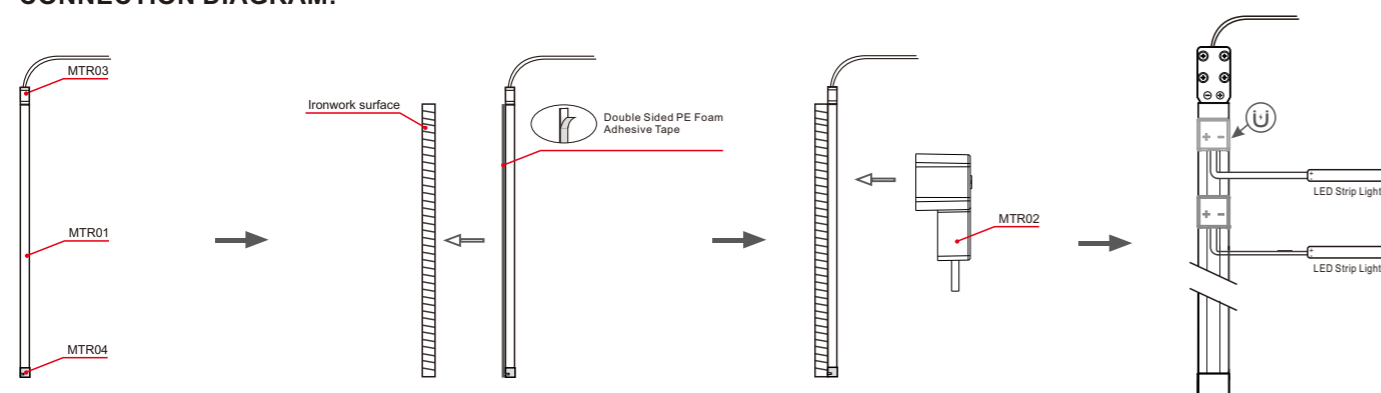

Step 1

Connect the MTR03 and MTR04 to the MTR01

Step 2

Installed MTR01 on iron materials

Step 3

Install the MTR02 straight to the MTR01 and MTR02 can be used with iron material only.

Step 4

Install successful

DC POWER TRACK & CONNECTOR

FEATURES

- Surface and recessed mounting ways are available.
- Track: 25A max, 12VDC/24VDC.
- Connector: 8A max with VDE #18 cable, 4A max with AWG #22 cable.
- Color: Black and white customized color is available.

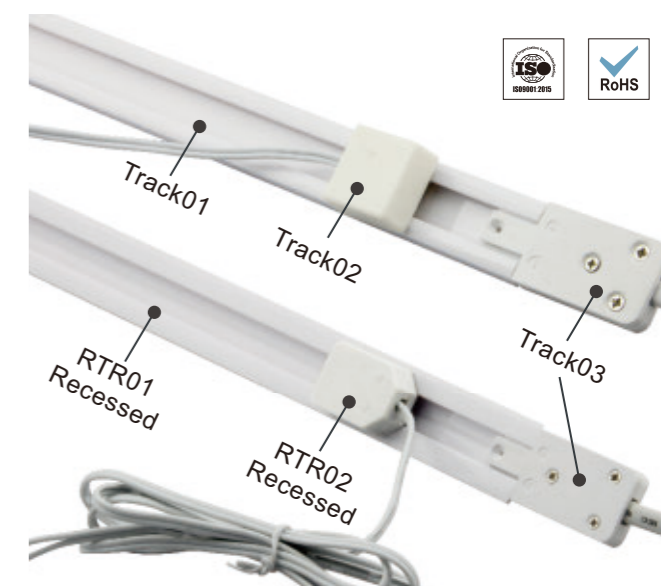

ACCESSORIES



Track 01

VDE #18 Cable
Surface Mounting



Track 02

AWG #22 Cable
Surface Mounting



Track 03



Track 04

End Cap



Track 05

Middle Track Connector
Between 2 Tracks

DIMENSION

Surface

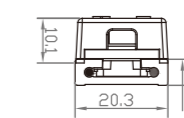

Recessed

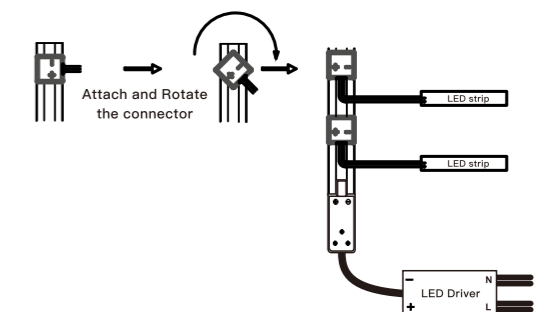
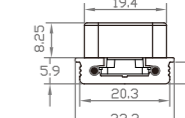

PROJECT

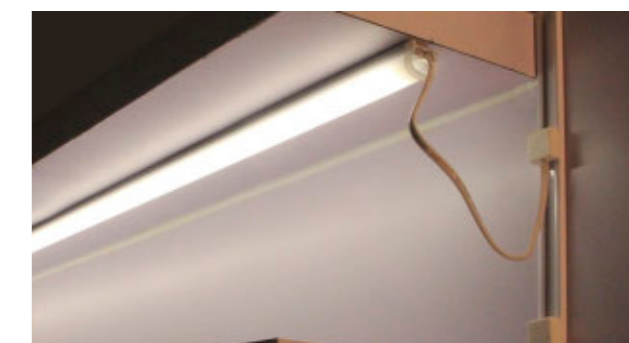

SOFT MAGNETIC TRACK

FEATURES

- Surface mounting on iron materials only.
- Track: 10A max, DC12-36V.
- Connector: 3A max 20AWG 2468 Parallel Wire
- Color: Black, white, customized color are available.



ACCESSORIES:



FTR01

Track



FTR02

20AWG 2468 Parallel Wire
Length and Color can be customized.



FTR03

16AWG 2468 Parallel Wire
Length and Color can be customized.



FTR04

Color can be customized.

SIZE:

FTR01

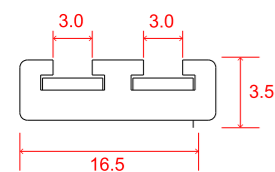

FTR02

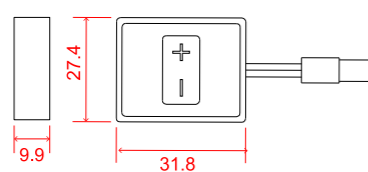

FTR03

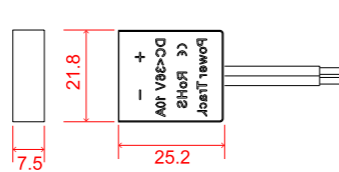

FTR04

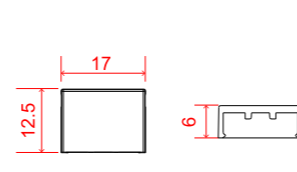

CONNECTION DIAGRAM:

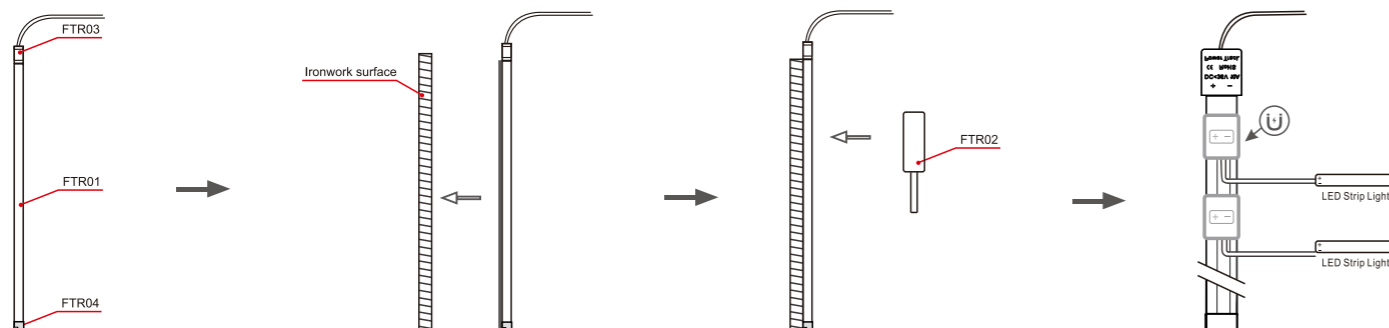

Step 1

Connect the FTR03 and FTR04 to the FTR01

Step 2

Installed FTR01 on iron materials

Step 3

Install the FTR02 straight to the FTR01 and FTR02 can be used with iron material only.

Step 4

Install successful

TRACK SPOT

FEATURES

- Operating temperature: 0~45°C
- Life time: 40,000hrs/70%
- Available CCT: 3000K, 4000K, 6000K
- Degree of protection: IP20
- Available in silver or black body
- Beam angle: Standard 40° / Optional 25°
- Total energy consumption: 1.0W
- CREE LED Chip



PRODUCT SIZE

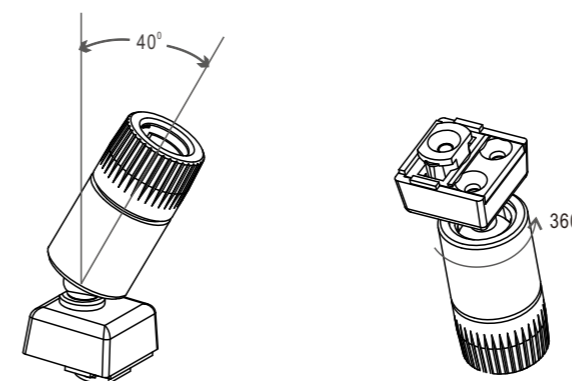
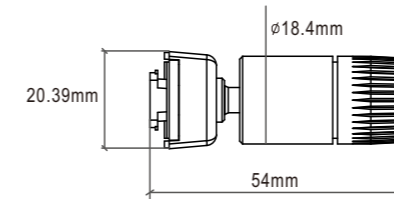

Model	Track Spot
Power	1W
Lumens	65/70/68 lm
Color	WW/NW/CW
Ra	>85
Voltage	DC12/24V

SCENES TO BE USED



LED CABINET LIGHT D70



FEATURES

- Control mode: To be connected to IR/touch/door switch.
- Application: Surface mounting
- Surface mounting by only two screws.
- CCT: Warm white, nature white, cool white.



STANDARD ACCESSORIES



Lamp body clip into the mounting bracket



Mounting Bracket

Model	NSC-D70-12V
Power	2.5W
Lumens	200lm
Color	WW
Ra	>85
Size	φ 70x12mm
Beam Angle	120°

SCENES TO BE USED

