

Flex Led Neon Light

# N1010D-SIDE FC-N1010D-SIDE

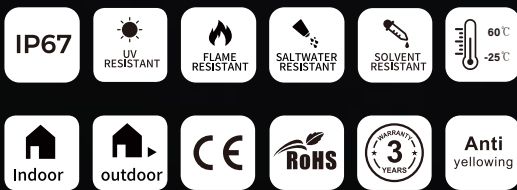

Product Specification

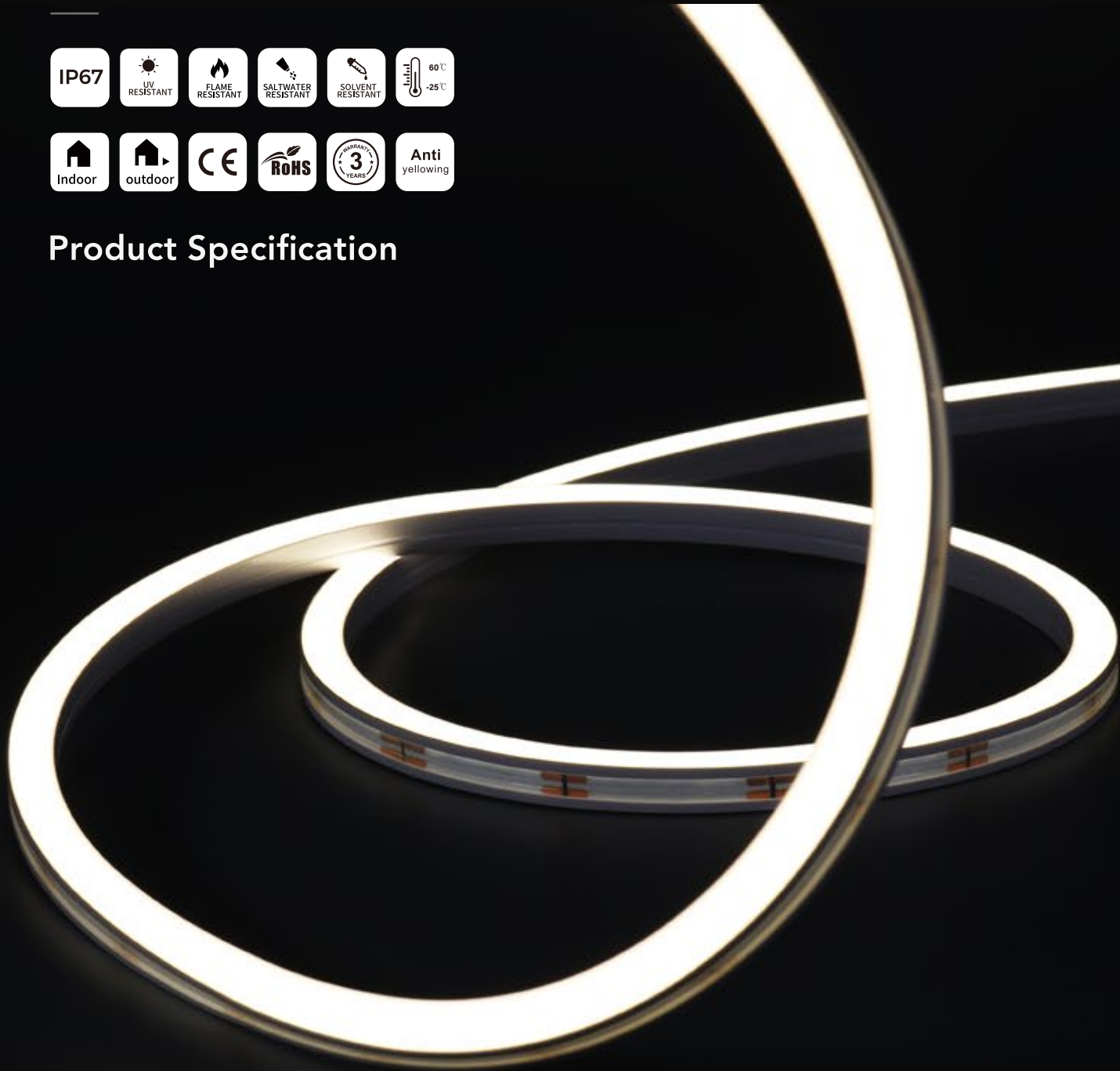

# LED strip colloid specifications comparison

| Materials                                 | Silicone flexible led strip      | PVC flexible led strip                                      | Notes  |
|---|----------------------------------|---|--|
| Main parameters                           |                                  |   |  |
| Colloid features in -40°C                 | No crack after 30 days           | Totally cracked   | The low temperature resistant of silicone is superior than PVC or epoxy materials                                  |
| Colloid features in 120°C                 | No obvious change after 72 hours | Colloid changed into yellow and deformed after 2 hours      | The high temperature resistant of silicone is superior than PVC or epoxy   |
| Colloid features in 180°C                 | No obvious change after 72 hours | Colloid changed into brown and some melted after 20 minutes | Over 150°C, PVC is easily hydrolyzed, Viscosity becomes weaken and easily seperated                                |
| Steadily lighted in Seawater for 72 hours | No obvious change                | Serious atomization on the surface                          | The waterproof grade of silicone led strip can reach to IP67, high resistance to acidic alkali and salt properties |
| Thermal conductivity                      | Good thermal conductivity        | No thermal conductivity                                     | Pvc and epoxy cannot conduct heat, while silicone has good thermal conductivity                                    |

## Product features

- Anti-yellowing and heat resisting silicone glue, chemical resistance acid and alkaline, available for extremely terrible outdoor environment.
- Uniform and soft luminance, no light spot.
- Super brightness large chip, golden wire welded and copper led holder for quicker heat dissipation, higher stability, longer life span.
- Leadless SMT technique (RoHS certificated), smooth welding joint, firm connection of led and pcb.

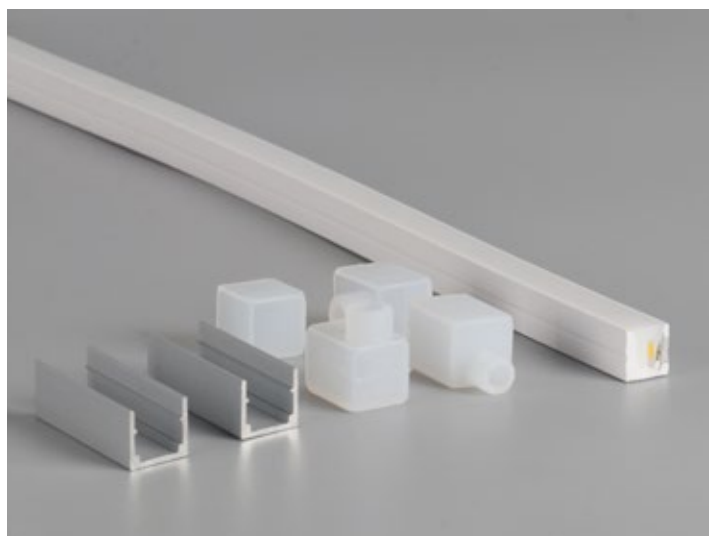

# Specification



## Bending (Silicone)

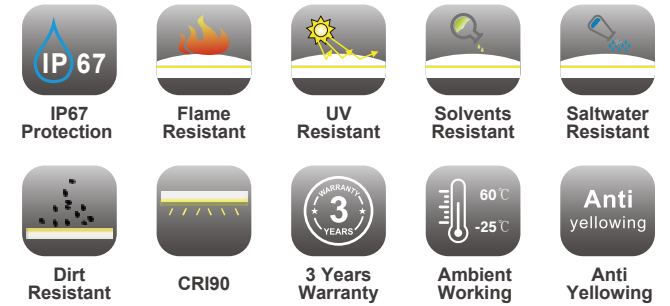
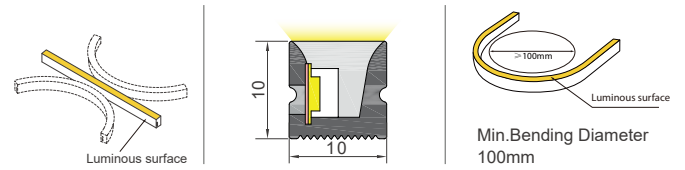

|                     |             |           |       |
|---------------------|-------------|-----------|-------|
| Model Number        | N1010D-SIDE | Size (mm) | 10*10 |
| PCB Limited (mm)    | 6mm         | IP Grade  | IP67  |
| Working Temperature | -25 to 60°C | N.W.(G/M) | 130g  |

## Dimensions of light

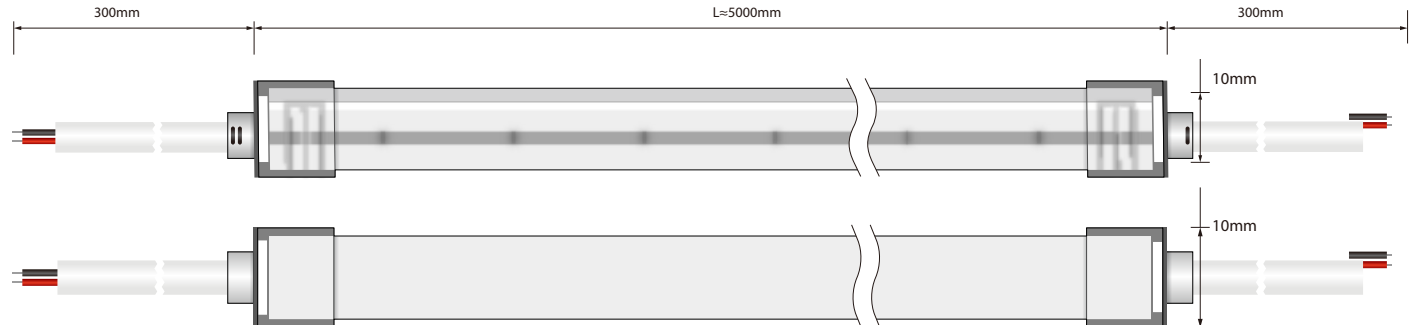

## VARIOUS CONNECTIONS

### Silicone glue endcap

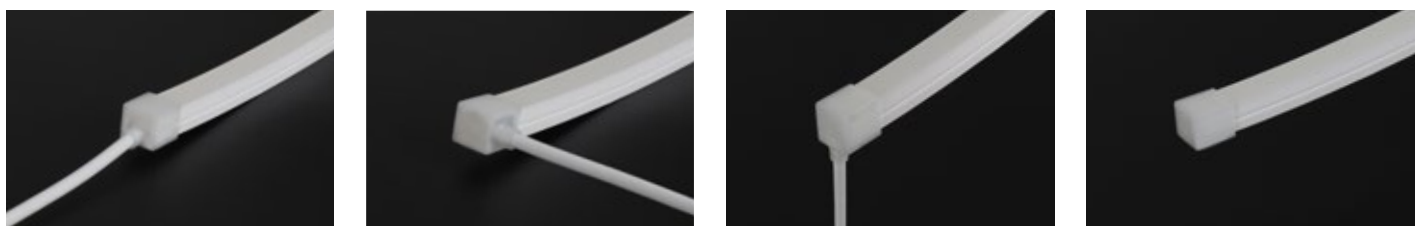

front cable entry



side cable entry

bottom entry



closed

# Recommend LED strip parameters

## (1) N1010D-SIDE WHT

| SMD2835, 168 LED/meter |  |         |          |                  |           |         |         |                       |
|------------------------|--|---------|----------|------------------|-----------|---------|---------|-----------------------|
| Part number            | Color  | Luneh/M | Unit cut | Cut every (LEDS) | LED Qty/M | Voltage | Power/M | Max run length        |
| SUR-2835FW168-24V      | WW  | 636     | 41.67mm  | 7                | 168       | 24V     | 9.6W    | 5 meters from one end |
|                        | NW  | 672     |          |                  |           |         |         |                       |
|                        | CW  | 661     |          |                  |           |         |         |                       |

## (2) FC-N1010D-SIDE WHT

| SMD2835, 180LED/meter |  |         |              |                  |           |         |         |                       |
|-----------------------|--|---------|--------------|------------------|-----------|---------|---------|-----------------------|
| Part number           | Color  | Luneh/M | Unit cut     | Cut every (LEDS) | LED Qty/M | Voltage | Power/M | Max run length        |
| SUR-2835FW180-24V     | WW  | 575     | cut anywhere | 1                | 180       | 24V     | 9.6W    | 5 meters from one end |
|                       | NW  | 605     |              |                  |           |         |         |                       |
|                       | CW  | 595     |              |                  |           |         |         |                       |

## N1010D-SIDE-Accessories

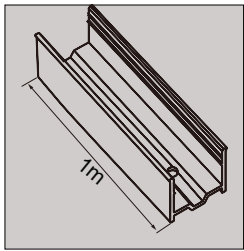

LED profile:  
1m/pc

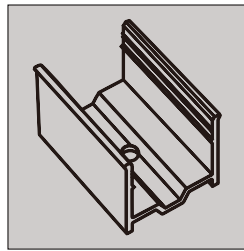

Mounting clip  
(Optional)

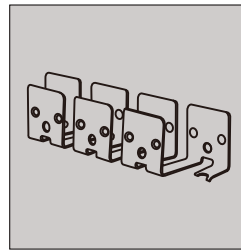

Curved profile  
1m/pc

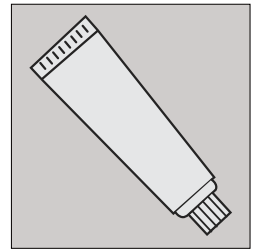

Glue

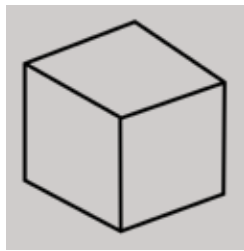

Closed silicone  
endcap

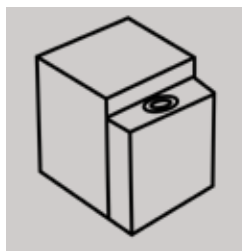

Silicone endcap  
-bottom

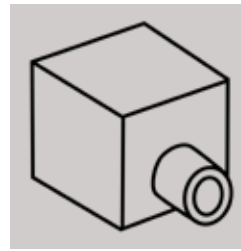

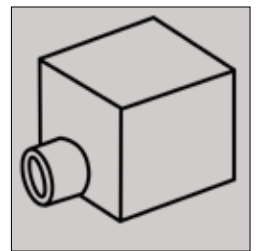

Silicone endcap  
-front



Silicone endcap  
-side

## Cable

| Cable Type | Schematic Diagram   | Specification                 | Core  | Electrical Properties |
|------------|---|-------------------------------|---|-----------------------|
| PVC Cable  |  | OD: 4.0mm /Inner core: 20AW/G |  | Red V+,Black V-       |

**Note: For more accessories, please contact our sales.**

# Driver & Controller



Order code: XLG-150-24-A  
AC100-305V DC24V 150W  
IP67, Global certification.  
Non Dimmable.



Order code: ELG-150-24B  
AC100-305V DC24V 150W  
IP67, Global certification  
3in1 dimming function: 0-10Vdc,  
10V PWM signal and resistance.



Order code: ELG-150-24DA  
AC100-305V DC24V 150W  
IP67, Global certification  
Dali control technology.



Order code: ELG-150-24DA  
AC100-305V DC24V 150W  
IP67, Global certification  
Dali control technology.



Dimmer: 1 Channel DC12V/24V, 6A,  
Dimmer, RF remote with finger  
touch ring.

## Product system solutions

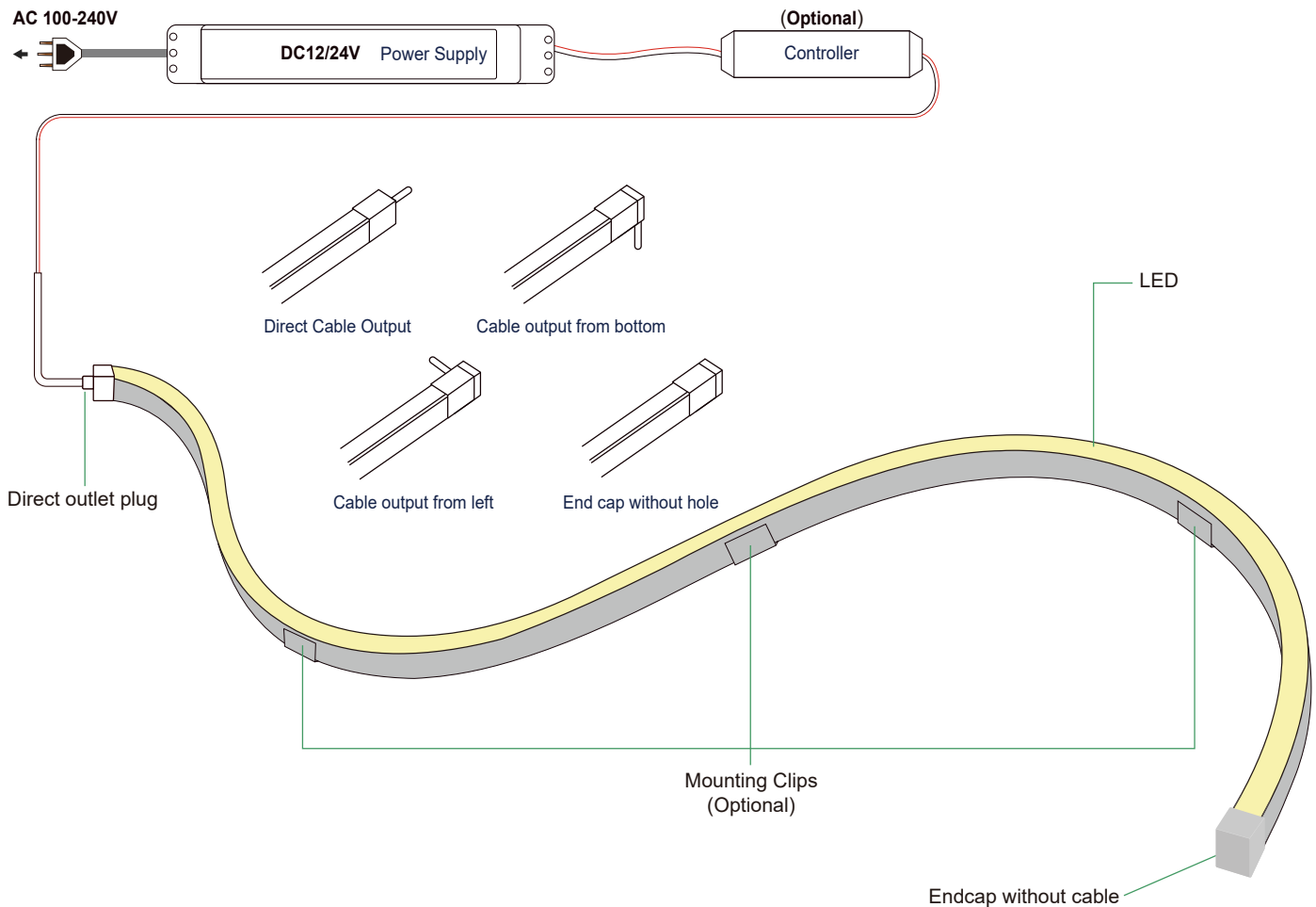

## Cut mark

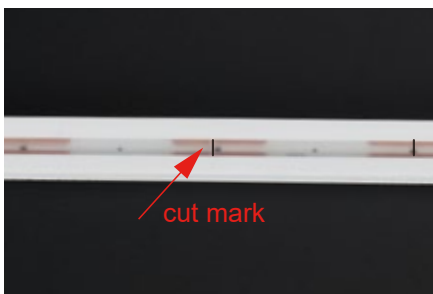

Remarks: There is a transparent window at the bottom of the light strip,



Make precise vertical cuts at the exact cut position of the light strip.

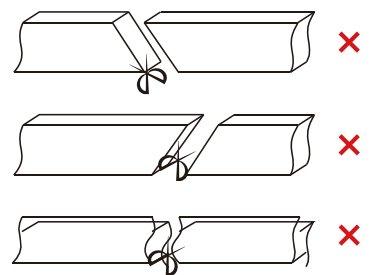

Please do not arbitrarily cut or cut into a bevel and arc section.

# Installation

This product is suitable for surface mounting or embedded sealing installation. Recommended slot size: Width 10mm, Depth 10mm, gently press the neon sleeve into the slot.

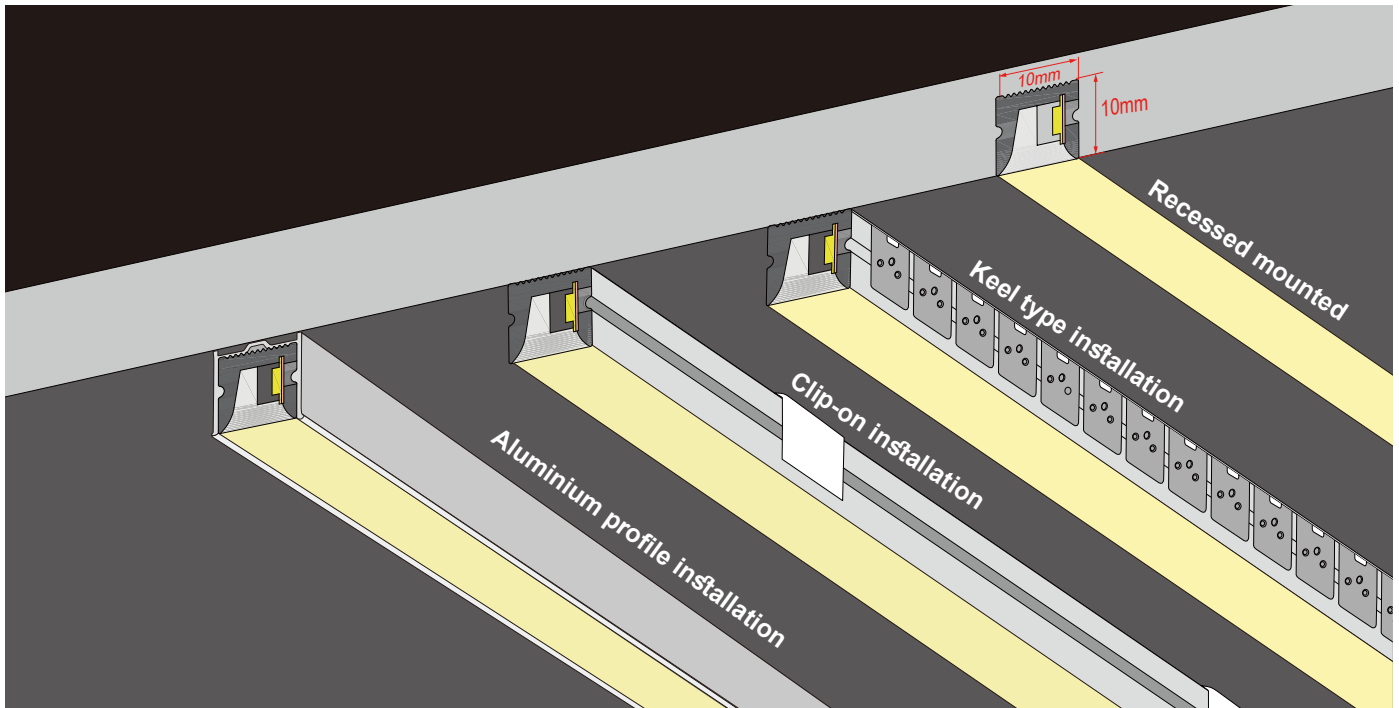

## Installation of carrier

1. When installing the LED strip, install it from both ends at the same time, installation from one direction is prohibited.

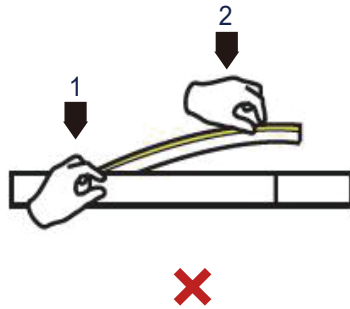
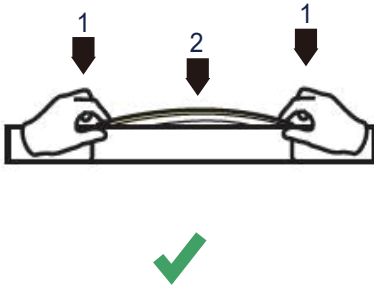

⚠ If the length of LED strip is over 2m, it is recommended to install by two persons.

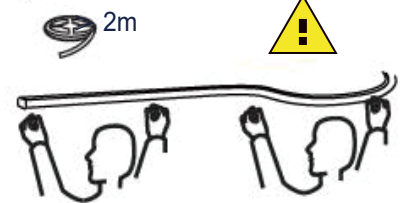

2. Use tool to disassemble carefully, and do not pull the LED strip directly.

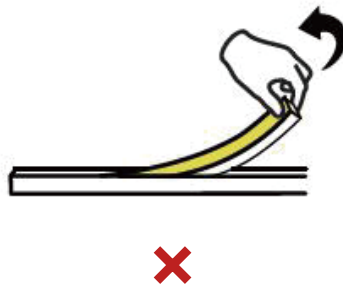
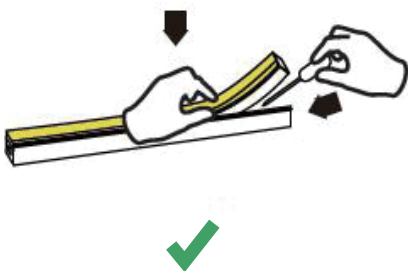

⚠ If the length of LED strip is over 2m, it is recommended to disassemble by two persons.

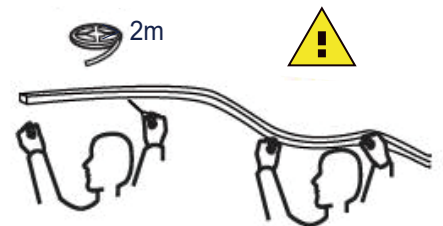

## Cautions

- Please notice that the strips are not bendable to all directions. As the appropriate specific shape and degree, please follow the following instruction.
- LED strips are low voltage products, you must use the power supply (transformer). Please don't connect the led strip directly to the AC 110V or AC 220V. Otherwise, it will burn out the LED strips and lead to safety (security) accidents.
- Please read the specifications thoroughly before installation by professional staff to make sure the safe use.

## Wrong bending way

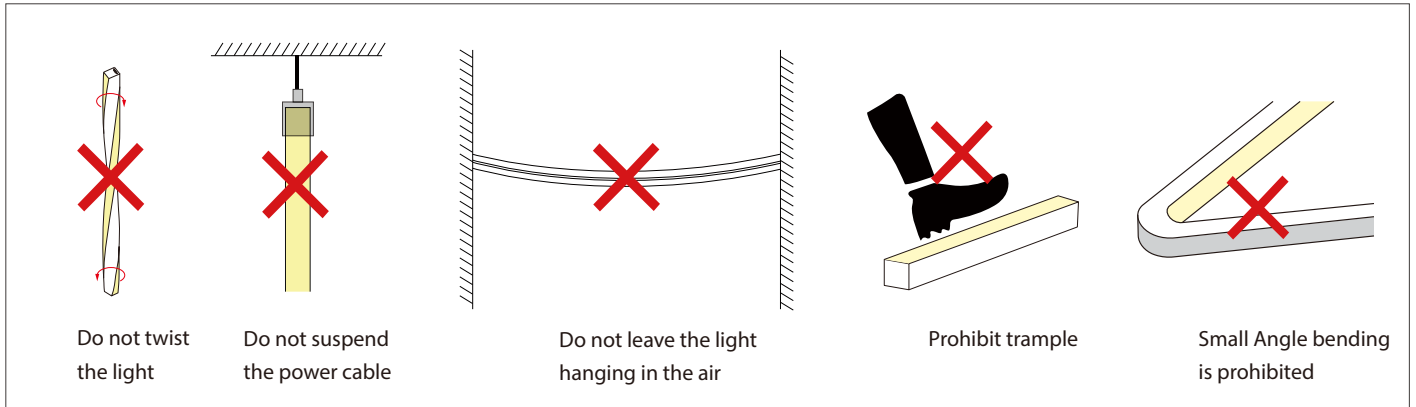

## Correct bending way

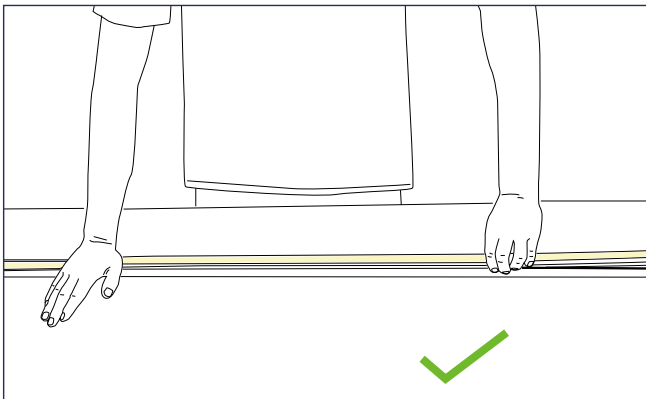

- Please press the led strip with your palm to slowly insert the led strip into the groove, and gently straighten the led strip above the groove with your right hand.
- Try to keep the led strip in a flat state during the installation process.

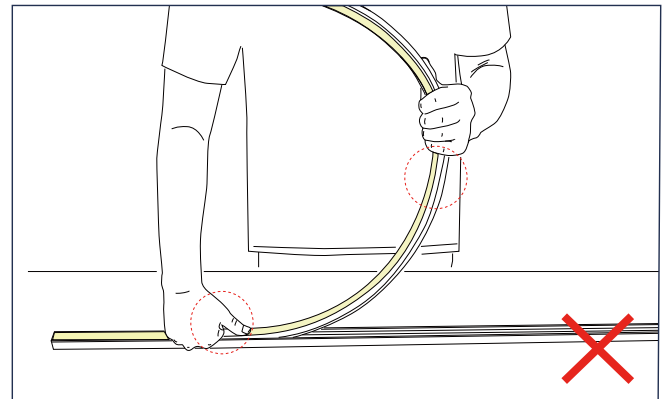

- Do not press the led strip with a single finger, it is easy to damage the internal parts of the led strip.
- The bent arc of the led strip should not be too large during installation.

# Installation Precautions -- Side Mounted

( If the length of the light is more than 2 meters, two persons must work together to install it. )

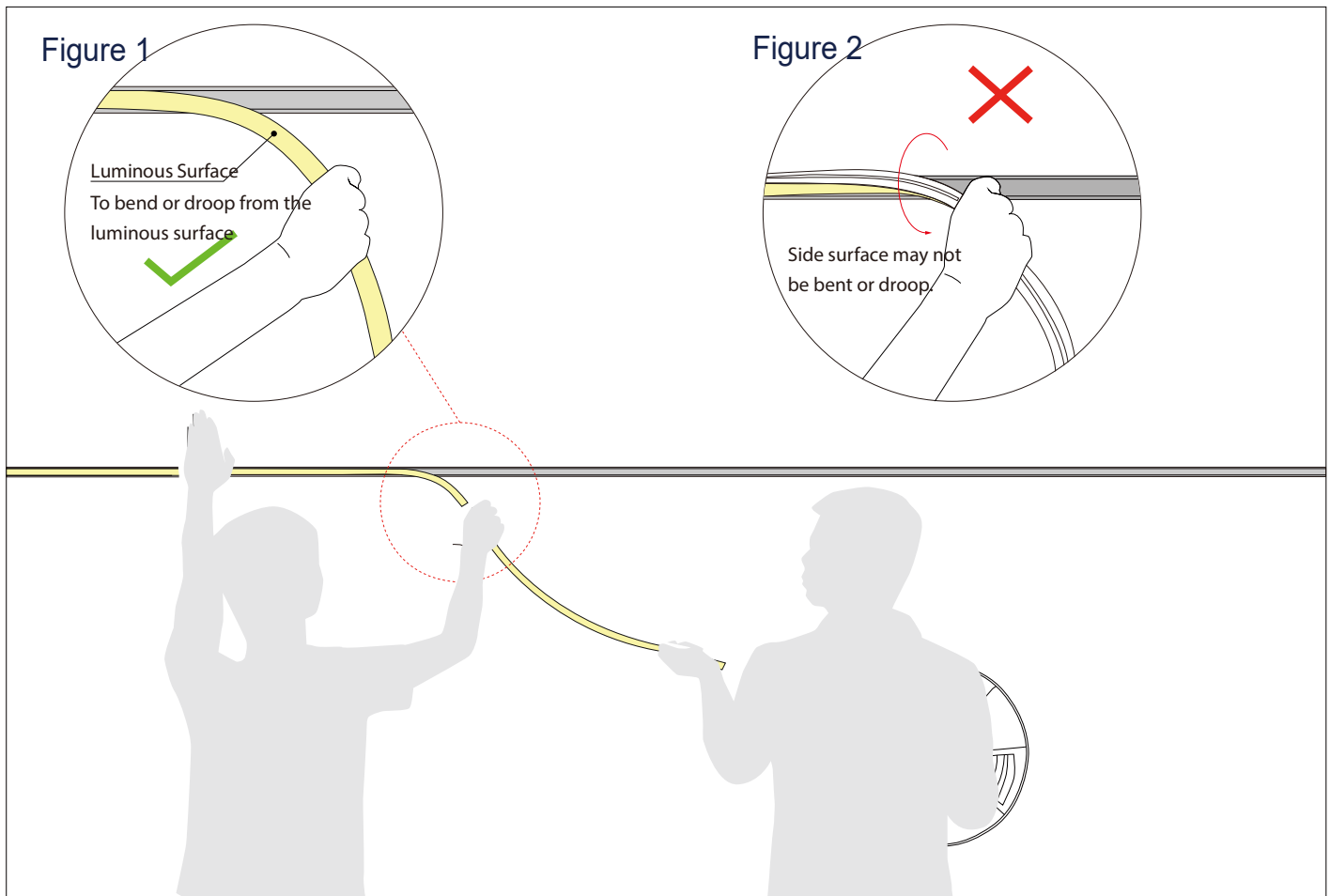

## 1. Installer:

- Press the light with the palm of the left hand to slowly load it into the slot. Straighten the light with right hand so that it droop in the direction of your hand. See Figure 1.
- Side surface may not be bent or droop, See Figure 2.

## 2. Assistant:

- Cooperate with the installer to lift the reel of the light, and then slowly deliver the light to installer. Do not pull or twist the light during the installation.

## Package of neon strip (5M/Roll)

