

STR002

Features:

- The track is work with 12-24V power supply (customizable), which is convenient for installation and can be connected to the power supply after plugging in.
- According to the needs of different occasions, the space layout can be controlled arbitrarily. The metal panels, wood panels and glass panels can be freely combined.
- Weight Capacity: ≤50KGS.
- With customized cabinet light, the track shelf can make your goods look more beautiful.



Accessories:

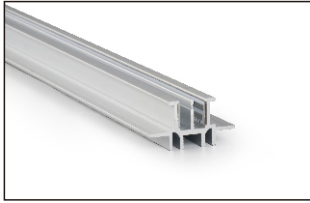

STR002

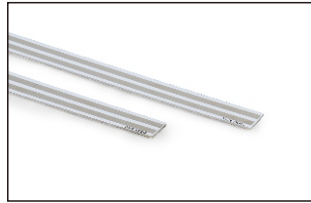

STR002-HT

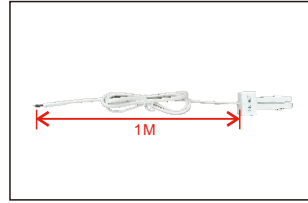

STR002-AP

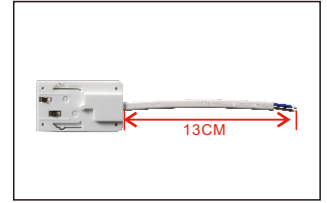

STR002-HP

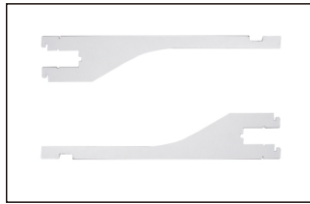

STR002-HM

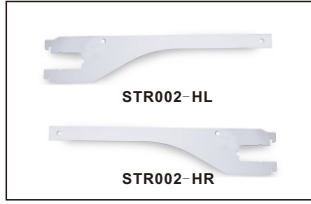

STR002-HL/HR

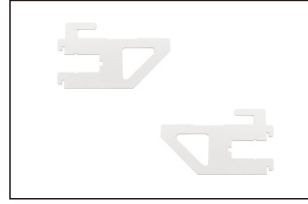

STR002-HG

Size:

STR002

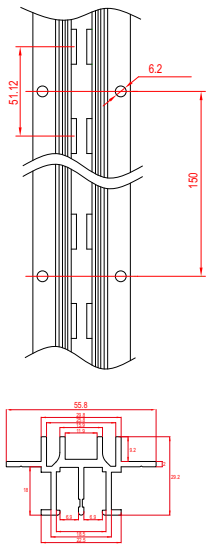

STR002-HT

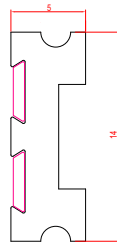

STR002-AP

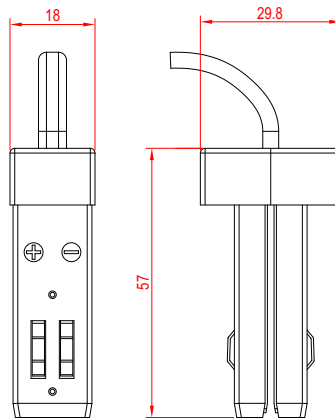

STR002-HP

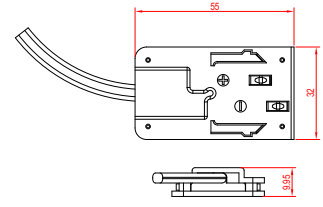

STR002-HM

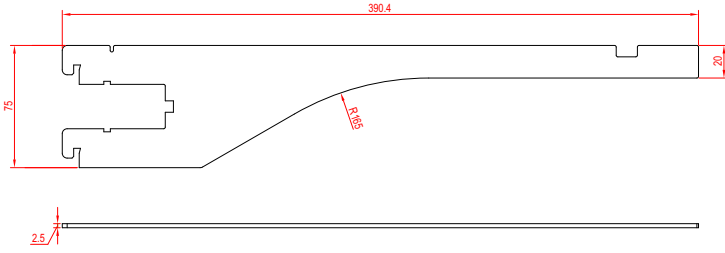

STR002-HL

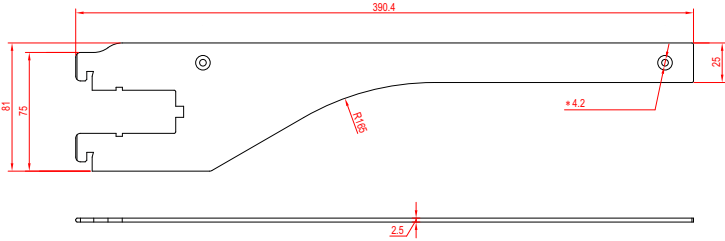

STR002-HG

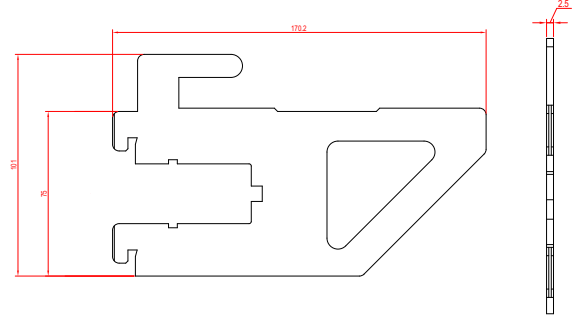

Installation method:

Installation method of STR002

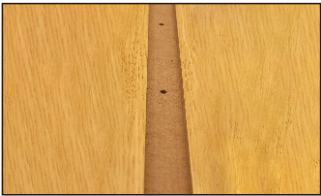

Pre-groove on the wall for installing STR002.

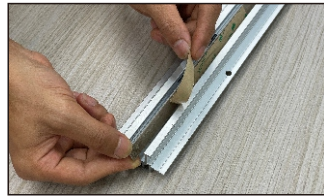

Insert two tracks (Code: STR02-HT) into the groove on both sides of STR002.



Fix STR002 to the groove.

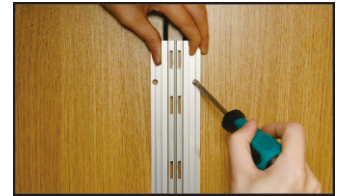

Fix STR002 with screws.

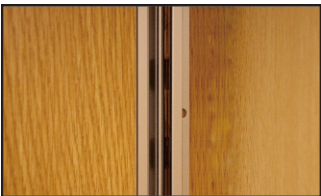

Use decorative wall to cover and embed STR002 on the wall.

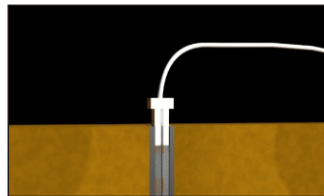

Insert power connector (Code: STR002-AP) into STR002 from the top to make STR002-HT power on.

Installation method of metal plates

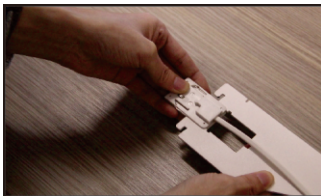

Insert power connector (Code: STR002-HP) into two STR002-HM and fix.

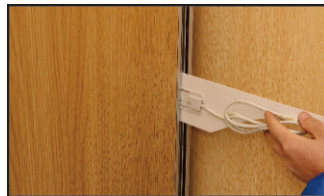

Insert two STR002-HM into the STR002 on the left and right ends respectively.



Place the metal plates on the STR002-HM and use the slot to fix it.



Lead the power cord through the channel reserved for the shelf and connect it to the finished light.

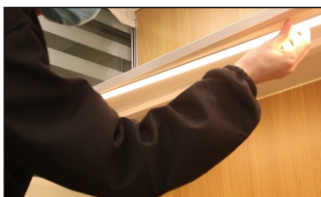

Use the magnetic attraction function of the finished light to fix it on the metal plates.

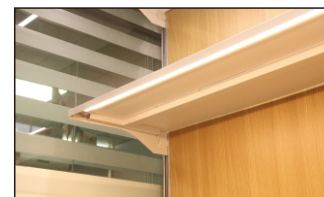

The installation is complete.

Installation method of wooden board



Embed the finished lamp into the board, and reserve a groove for the wire on the side.

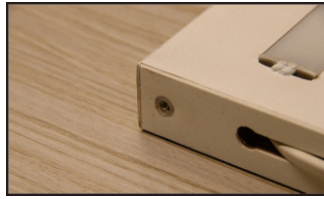

Drill holes at the corresponding positions on the board and install expansion screw plugs.

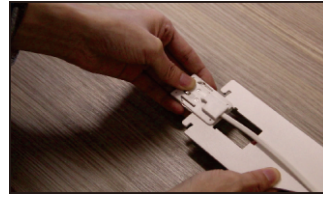

Insert two power connector (Code: STR002-HP) into STR002-HL(left) and STR002-HR(right) to fix.

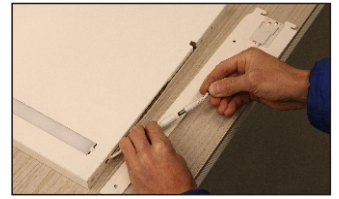

Connect the lamp and STR002-HL with a male and female connector.

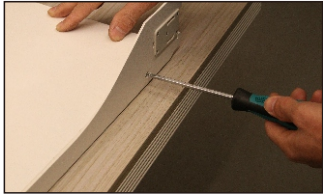

Fix the STR002-HL/HR on both sides of the wooden board with screws corresponding to the position of the expansion screw plug.



Insert the STR002- HR of the installed wooden laminate into STR002 and fix it.



Insert the STR002-HL on the other side into the STR002 and fix it to turn on the power, the light will be lit.



The installation is complete.

Installation method of glass plates

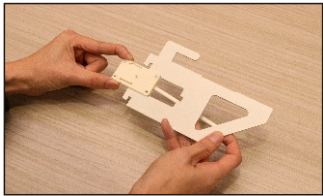

Insert two power connector (Code: STR002-HP) into two STR002-HG respectively.

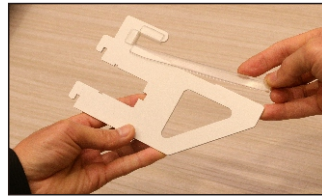

Put rubber pads on the two STR002-HG glass slots to reduce glass damage.



Insert STR002-HG into STR002 on both sides and fix.

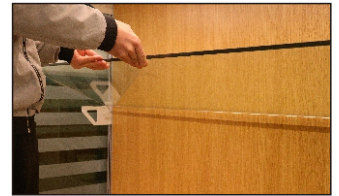

Insert the glass plates into the slot on the corresponding STR002-HG and fix it.



The installation is complete.