

Recessed Door Sensor IR005-D

Functions:

- Lights will be ON/OFF when open/close the door.
- Input Voltage: 12V -24VDC.
- Output Voltage: 12V -24VDC.
- Input Current: 4A.
- Load around 48W for 12V, and 96W for 24V.
- Input and output cable length: 1m (Customized length can be ordered).
- $0.5\text{cm} \leq \text{Detection Range} \leq 10\text{cm}$.

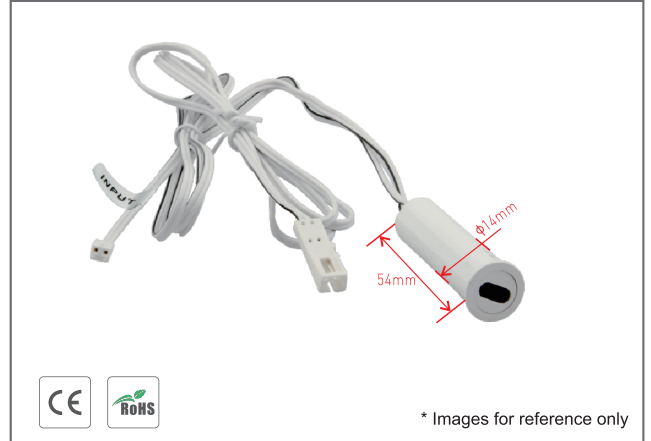

Operations:

- The LED lamp connects to the output end.
- The IR sensor switch will turn on the LED light when the door is open and will turn off the LED light when the door is closed.
- Detection range is 10cm from the sensor detector to the door.
- The sensor switch will turn on or off the LED light with above repeatable steps.

Installation Steps:

- Step 1: Drill a hole of $\Phi 14\text{mm}$ and minimum depth 54mm in wooden plate.
- Step 2: Insert the sensor into the hole in the wooden plate.

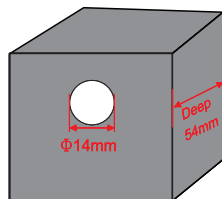

Connectors:

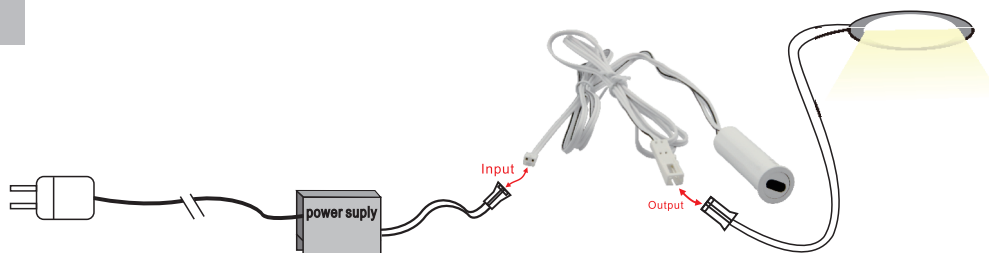

Note: Please read the tag on the wire when connecting cables.

The function/program can be customized, made upon different needs, such as longer time for stay on, etc.