

Stair LED Aluminum Profile-S003

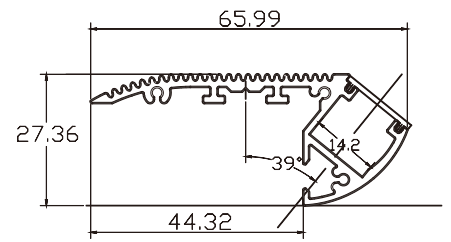

Customized Color can be ordered



LED Aluminum profile 1~2meter

Service Environment and Installation:

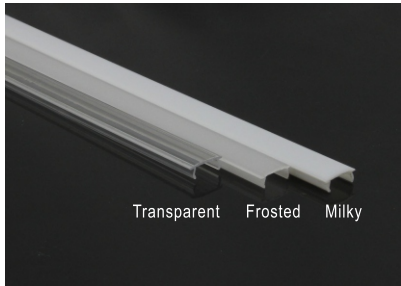
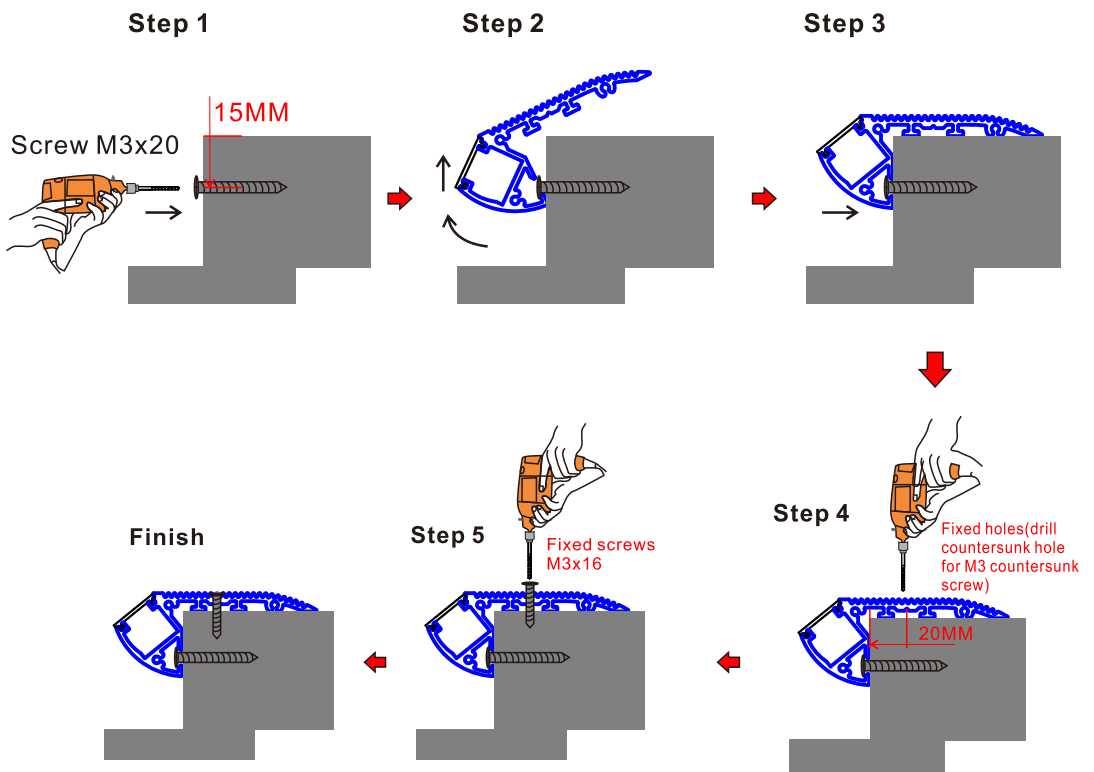

PC Cover



Endcaps *2pcs
Screws *4pcs
silicone ring *2pcs

Fixed screws x 2pcs
Example every 450mm

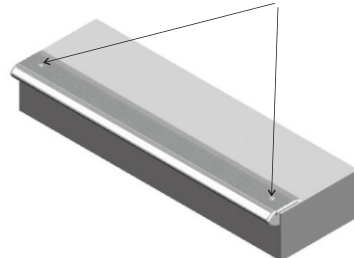

With Lighting Symbol

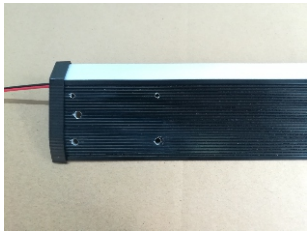

Step 1
drilled the hole on the
step profile *5PCS

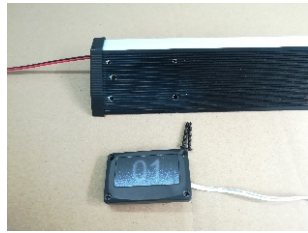

Step 2
row number *1
Screws spec: M3*16 *2PCS

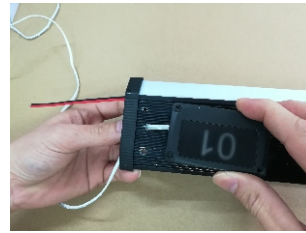

Step 3
Put the cable of the row number
through the hole



Step 4

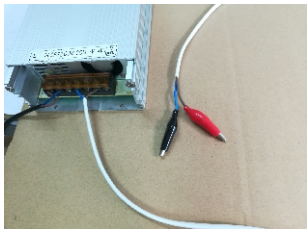

Step 8
Power supply

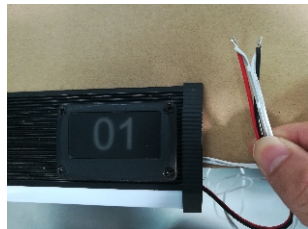

Step 7
led strip + connect to row number +,
led strip- connect to row number -
(black-,red +)

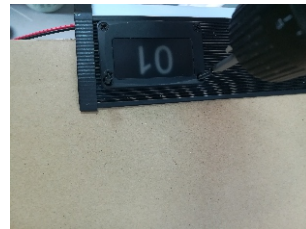

Step 6
fixed the row number by
M3*16 screw on the profile



Step 5
Screw the Lighting symbol
on the lamp slot

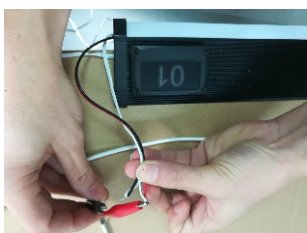

Step 9
LED light connect to
power supply (black-,red +)

